

1

-Use protective clothing, goggles, gloves
-Follow safety precautions at all times

Cable Shorten Manual

Remove original cables

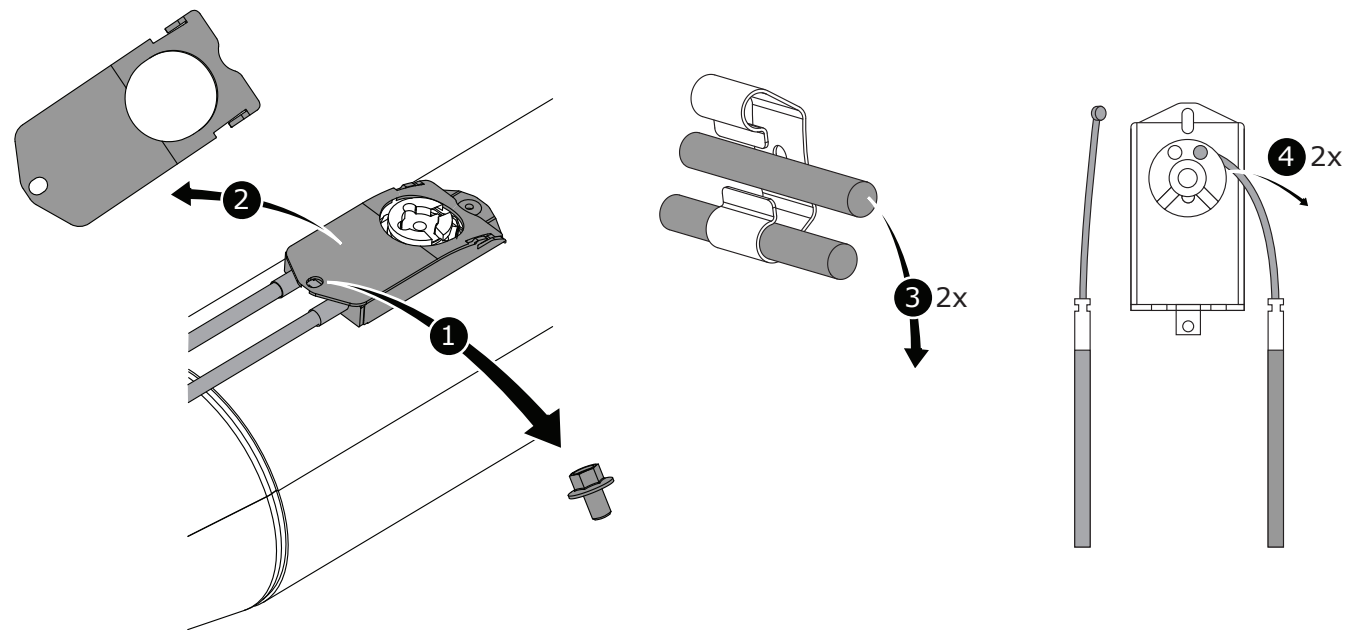

2

Determine cable lengths

1 Line up servomotors lid & housing as shown

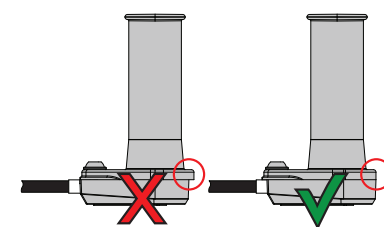

With outer cable connected

2 Place servomotors at the desired position on the motorcycle and secure them in place

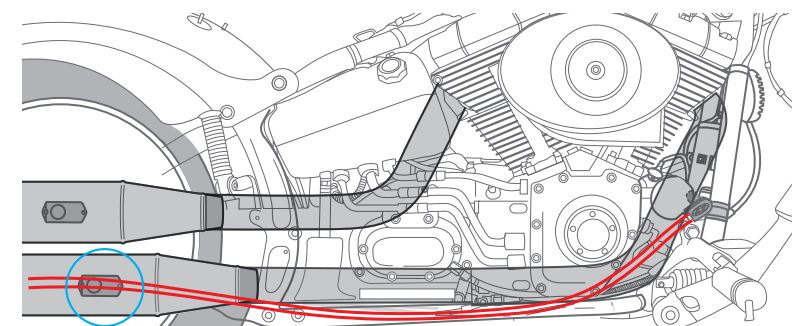
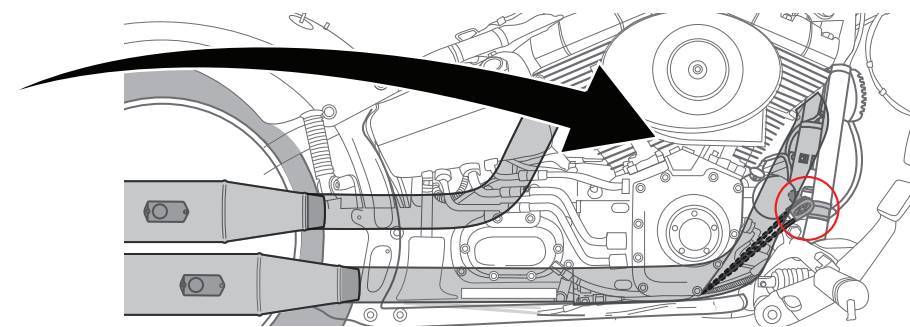

3 Determine outer cable routing

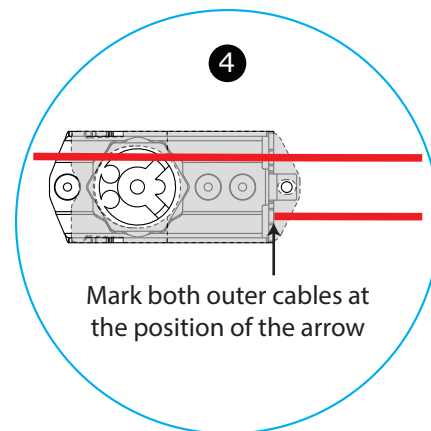

Mark both outer cables at the position of the arrow

3

Disassemble servo's

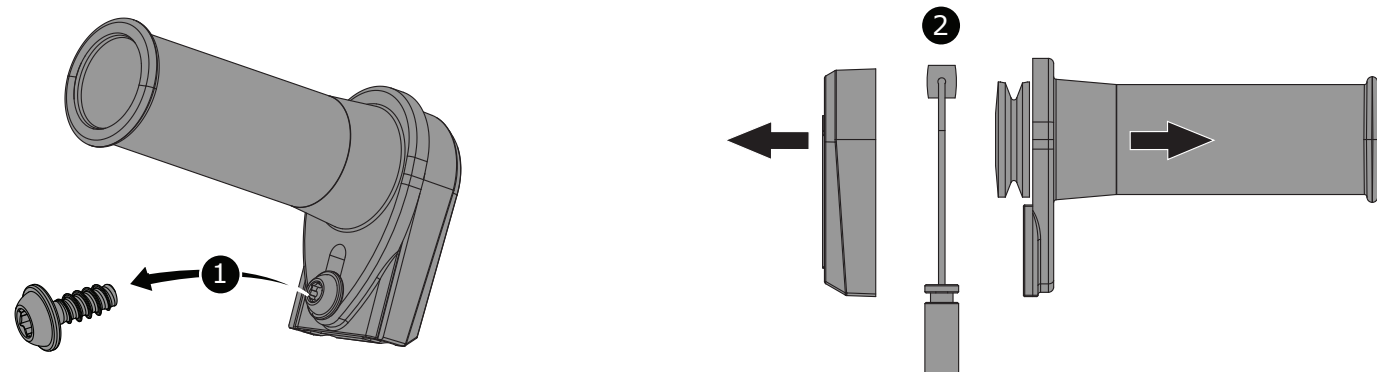

4

Shorten outer cables

1 Cut off both cable nipples

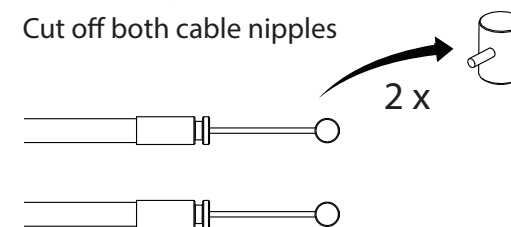

2 Remove outer cables

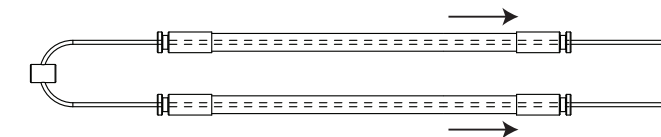

Cut, 2x

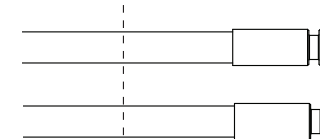

length of both cables may vary per servomotor

3 Cut or grind off outer cables at the mark (step 1.4)

5 Assemble cables (1/2)

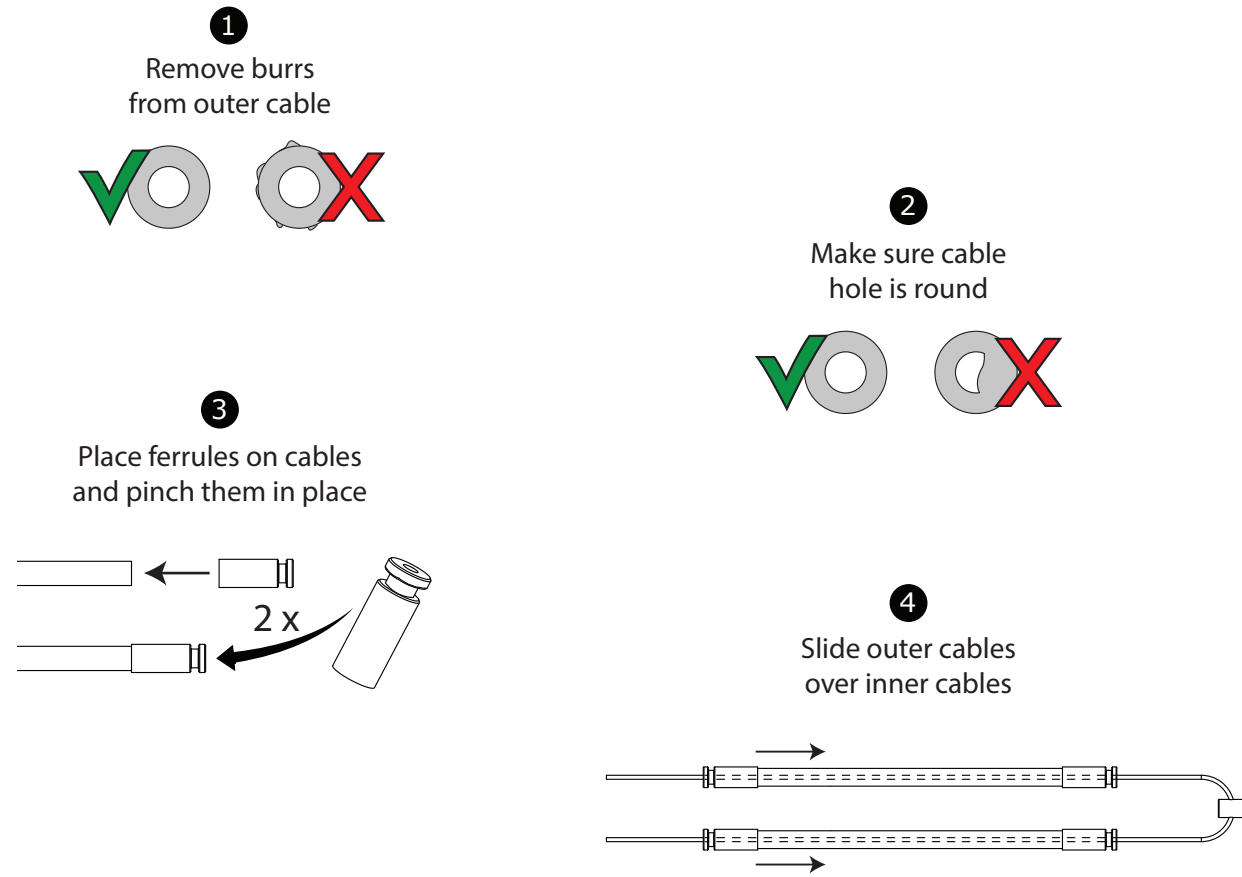

6 Assemble cables (2/2)

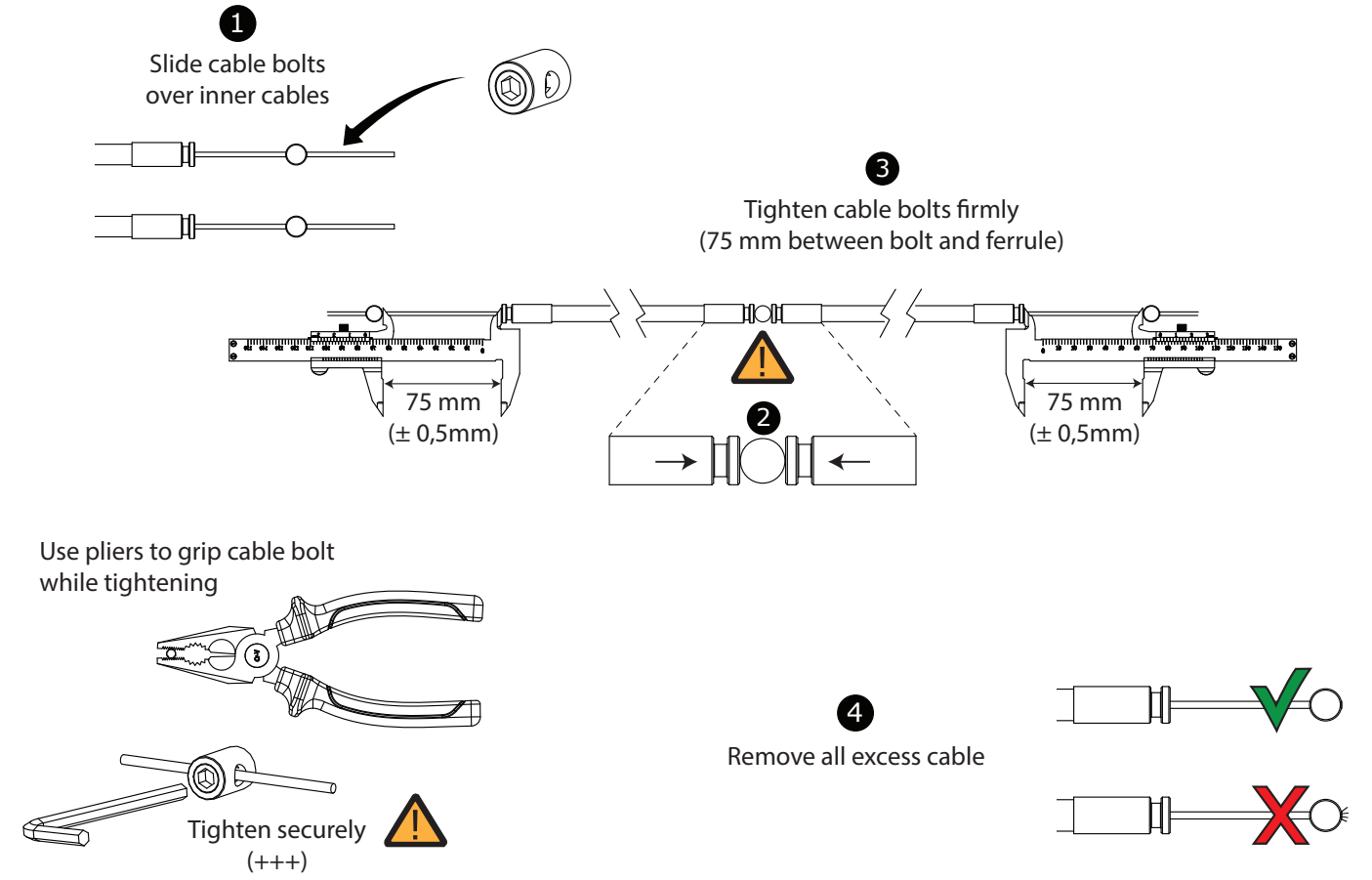

7 Mount new cables to exhaust

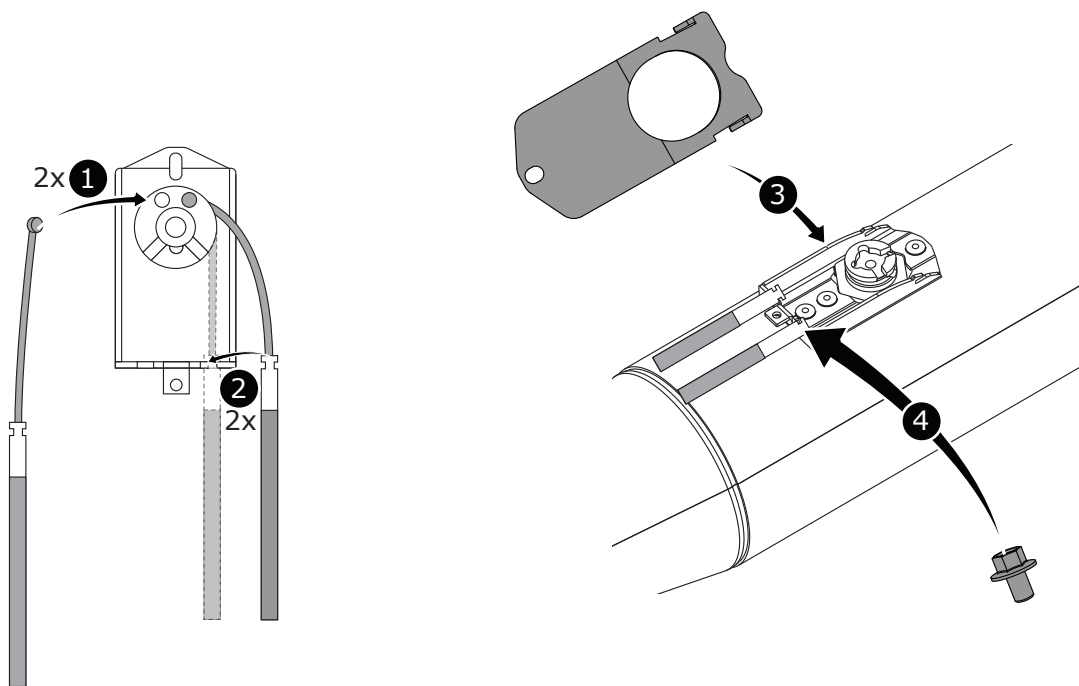

8 Mount new cables to servo's and adjust cable tension

