



SN. . . . .

# Dr. Jekyll & Mr. Hyde<sup>®</sup>

## THE EXHAUST

MANUAL : HARLEY-DAVIDSON<sup>®</sup> | EASYMOUNT | SMARTBOX 2

### NEW IN THIS MANUAL:

- SMARTBOX 2
- HIROSE CONNECTORS



Softail Upper/Middle/Lower

1

# All Softail Models

## Easymount Smartbox 2

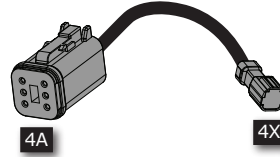
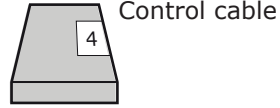
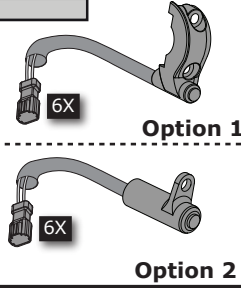
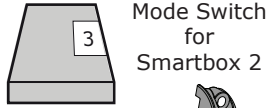
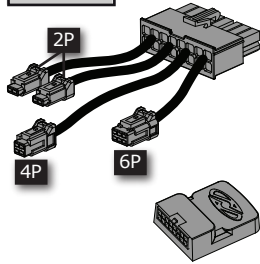
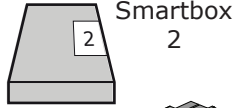
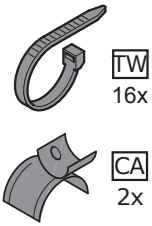
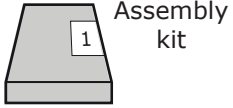
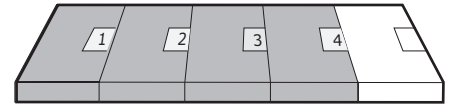

Exhaust/cable/  
servo system

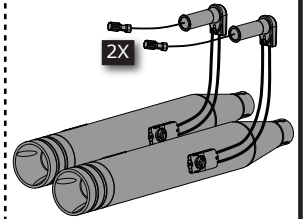

2

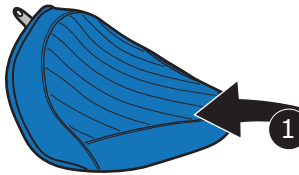

2

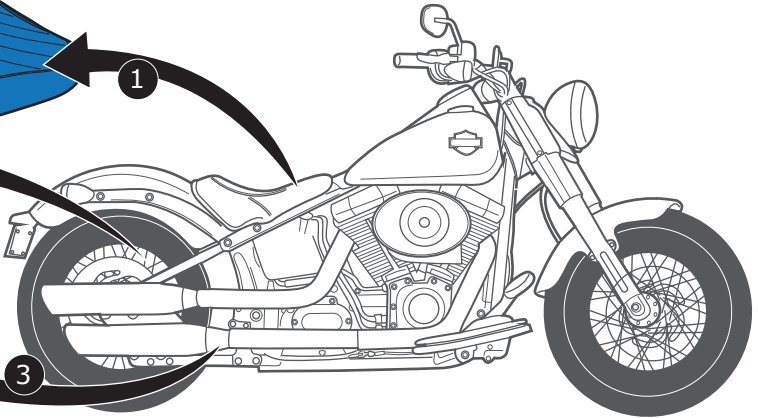

May vary per model **STEP 3**



3

To mount exhaust  
use the mountingset

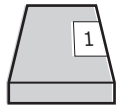
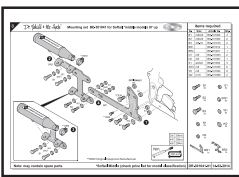
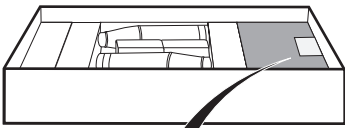

**STEP 4** 2X 2x

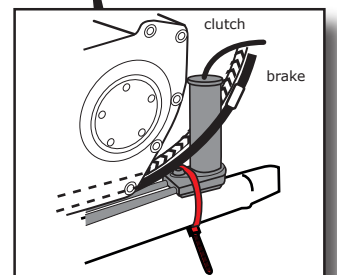
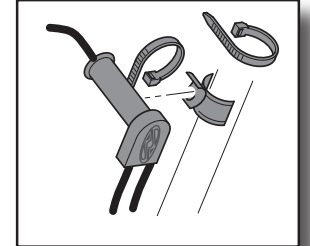
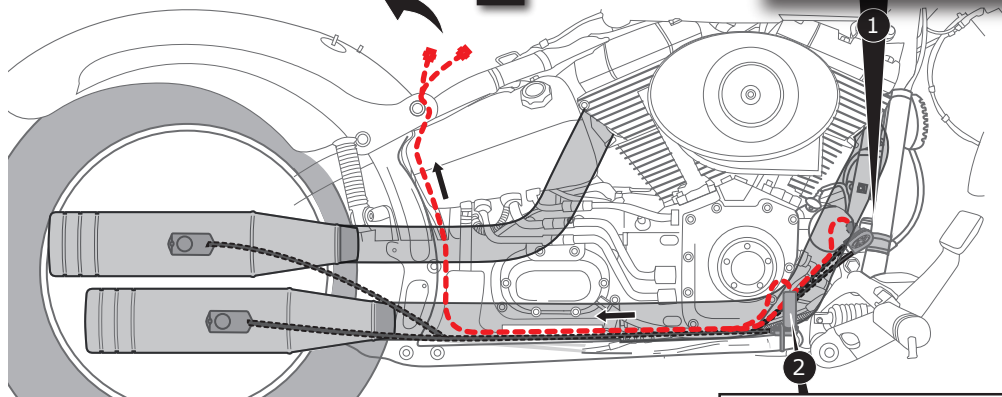

Note: may vary per model

4

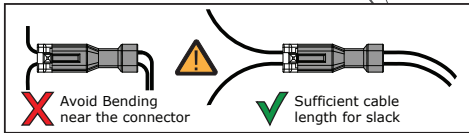
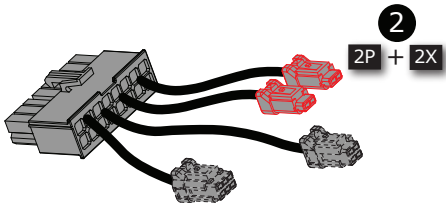
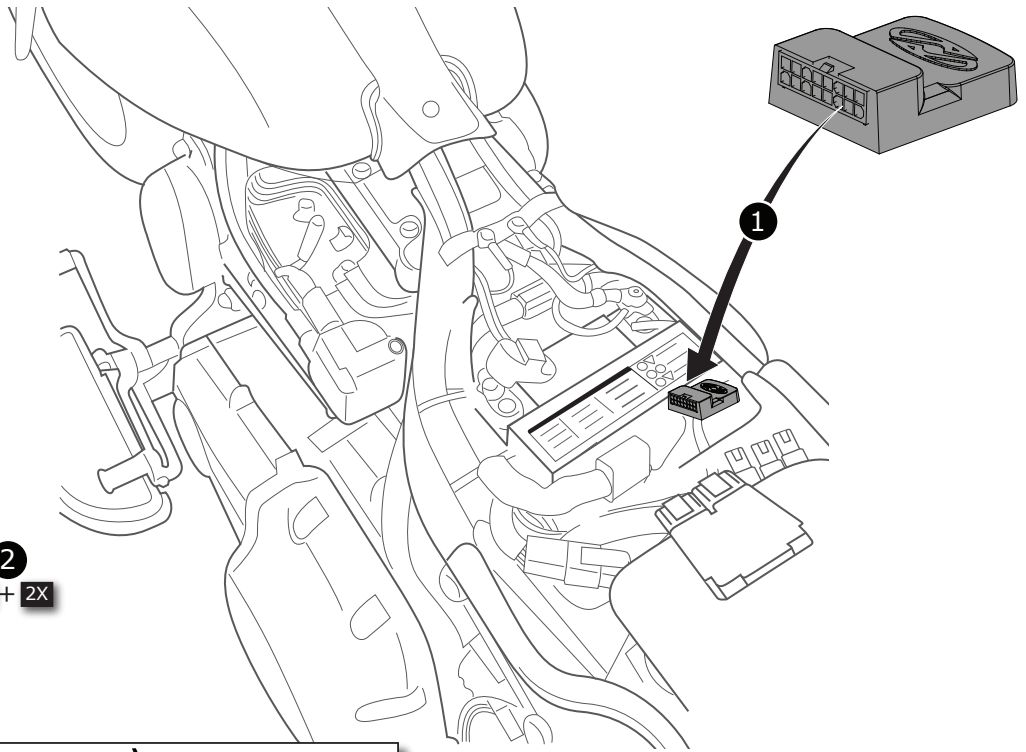
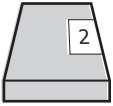

5

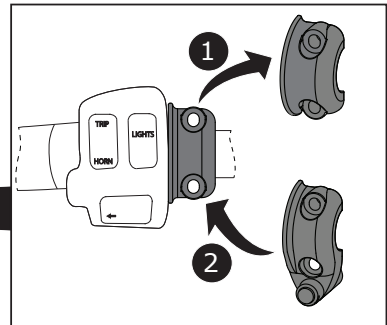
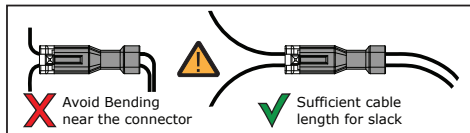
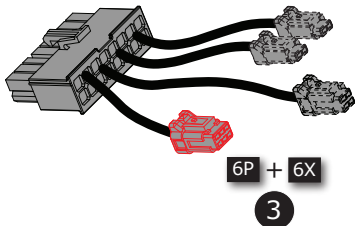
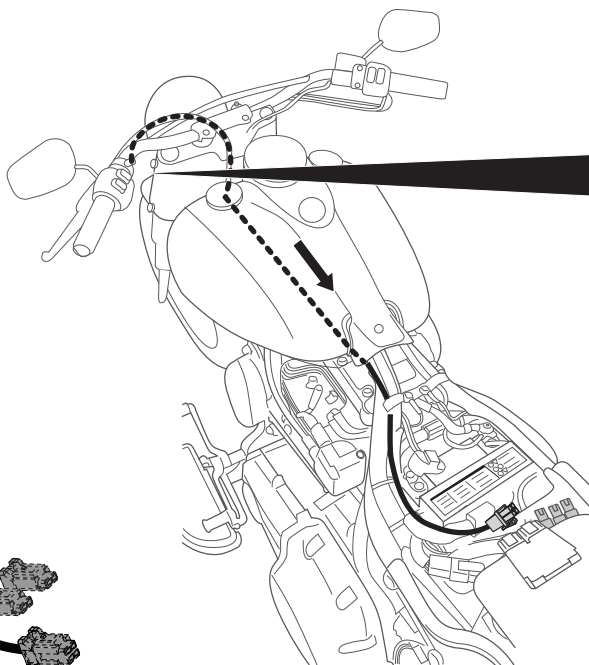
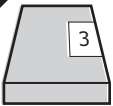

Or

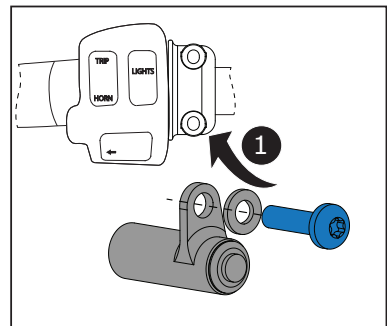

6

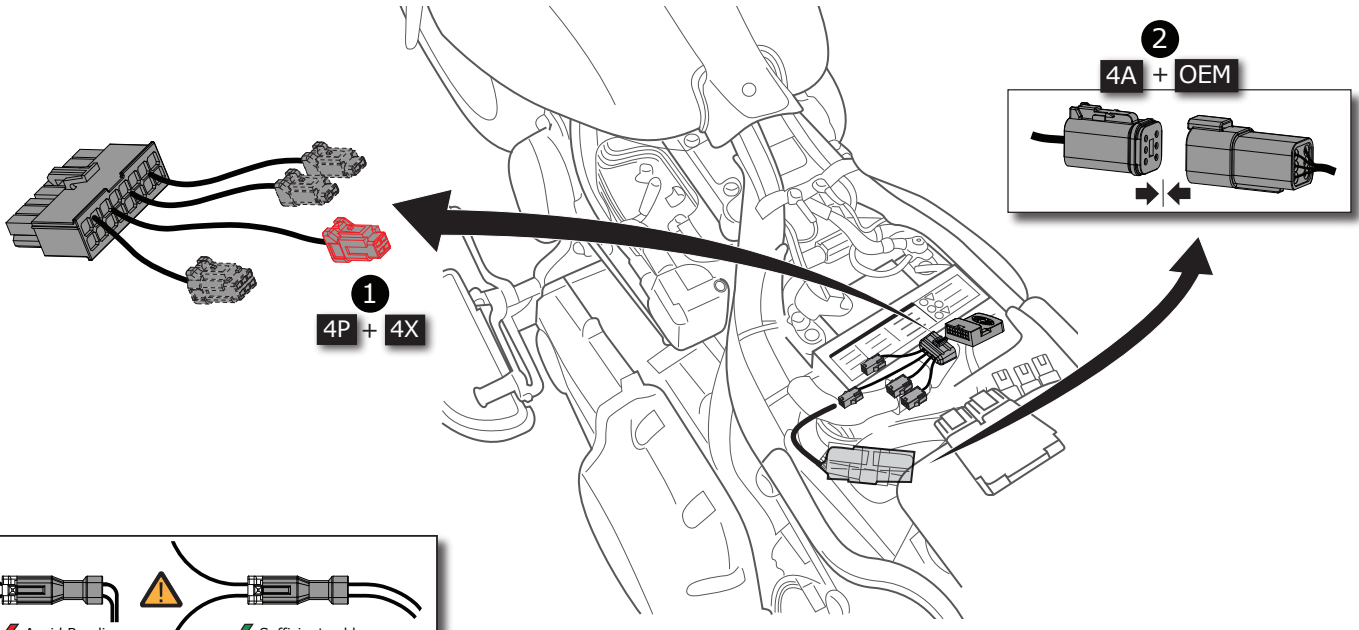

7

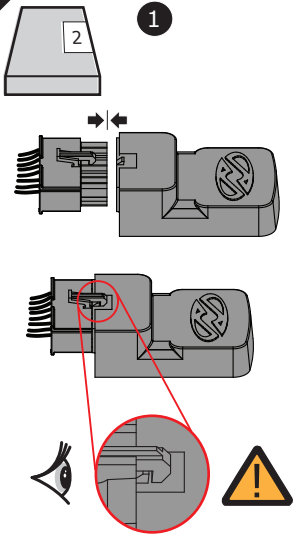

**Complete System Check!**

