



SN.

Dr. Jekyll & Mr. Hyde[®]

THE EXHAUST

MANUAL : HARLEY-DAVIDSON[®] | EASYMOUNT | BLACKBOX



V-Rod 2001-2011

1

V-Rod 2001-2011 Easymount Blackbox

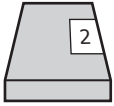

Mode Switch for Blackbox

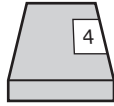
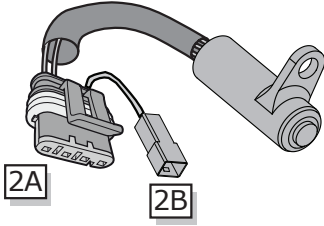

Blackbox

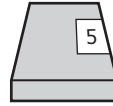
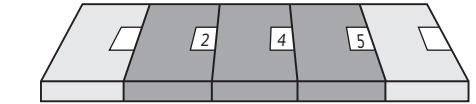
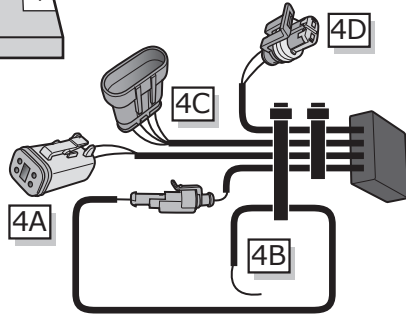

Y Cable

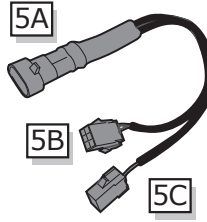

Exhaust/cable/
servo system

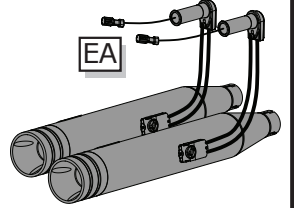

2

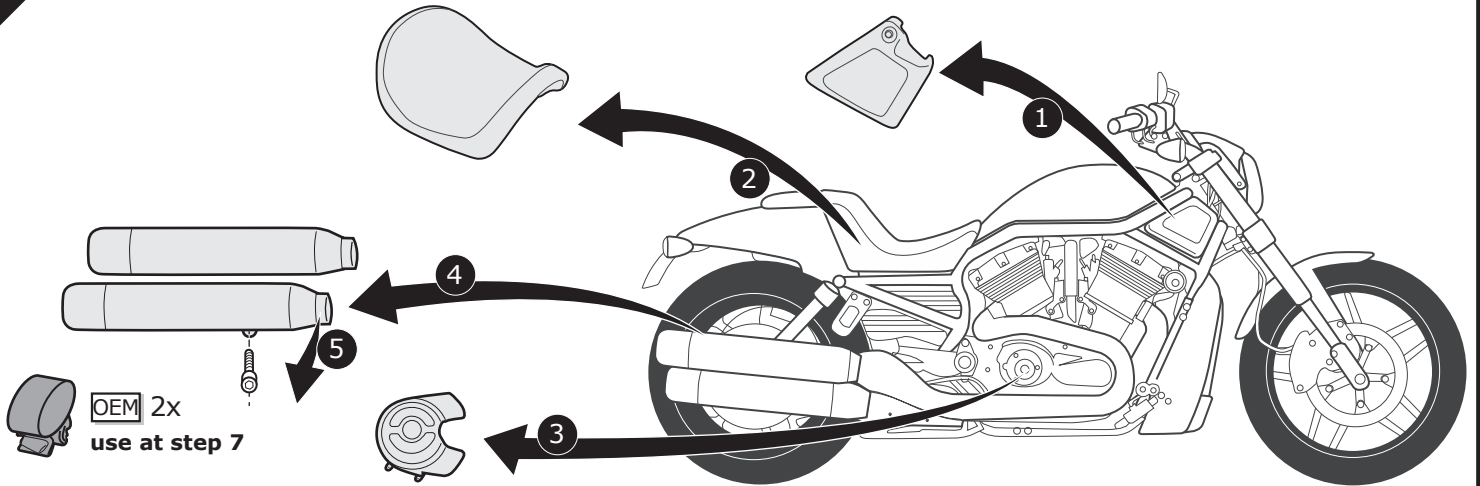

3

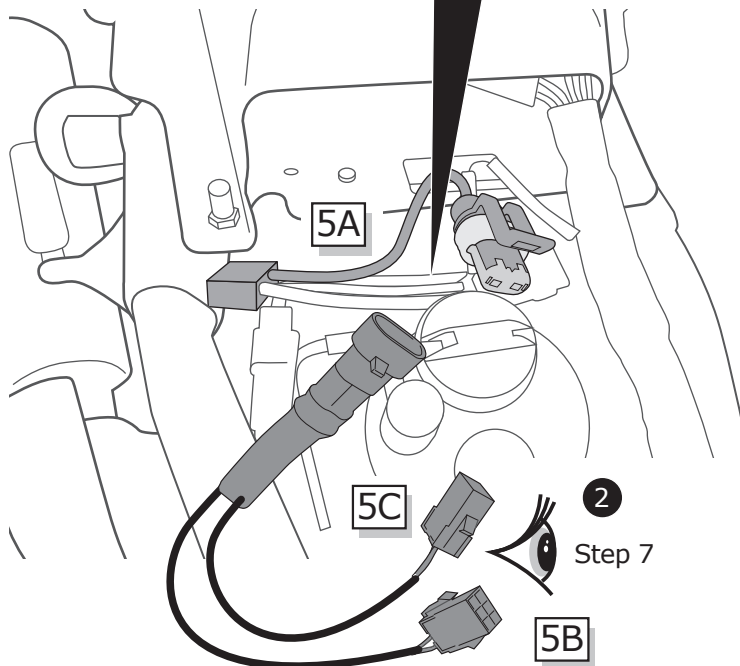
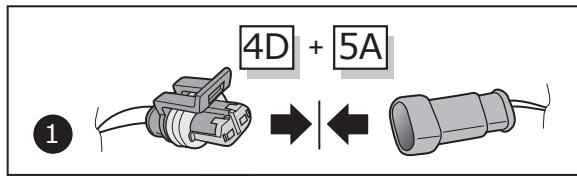
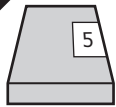

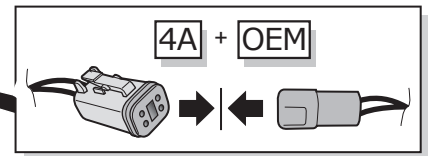
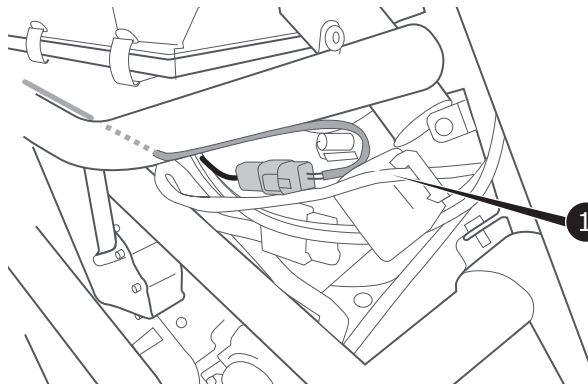
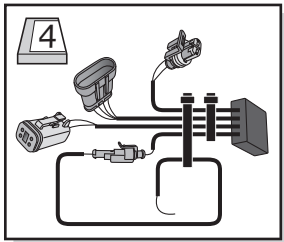
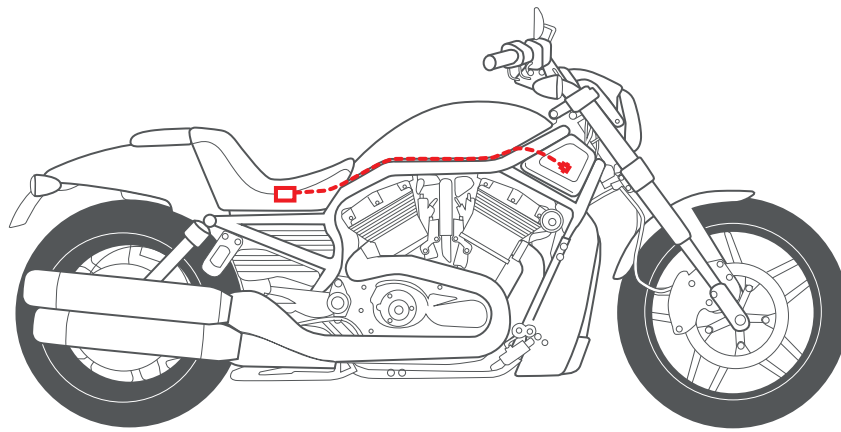

Speed signal

1 **(NL) Zwart-Blauw**
(DE) Schwarz-Blau
(GB) Black-Blue

2 **(NL) Zwart-Blauw**
(DE) Schwarz-Blau
(GB) Black-Blue

3 **(NL) Groen**
(DE) Grün
(GB) Green

4B

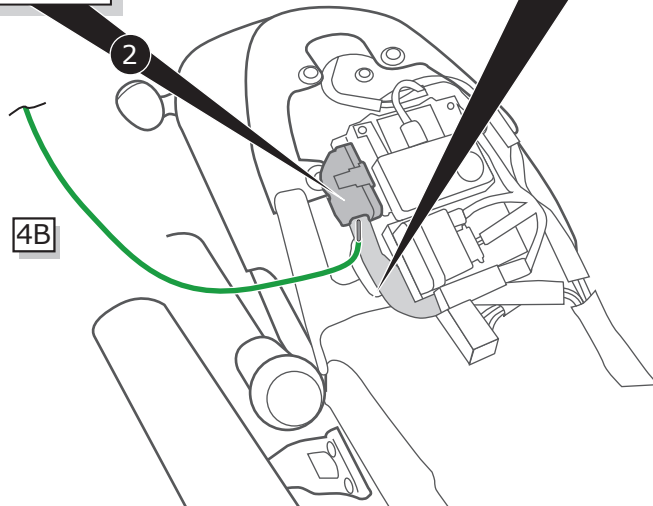
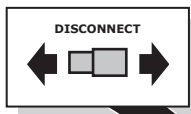

5

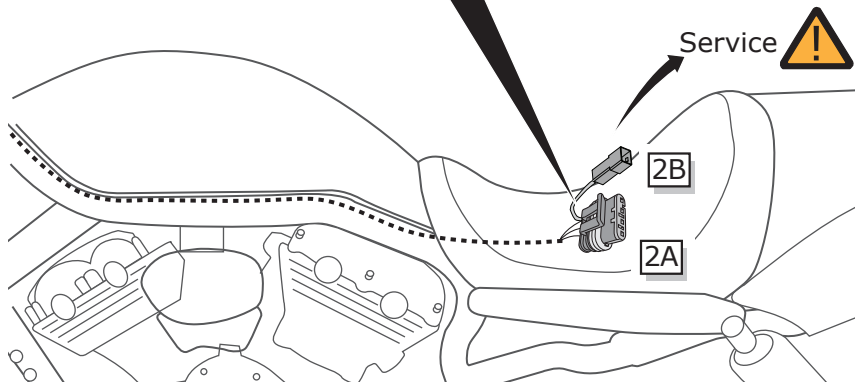
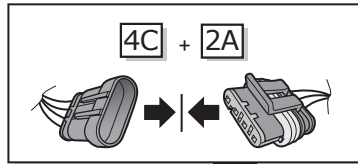
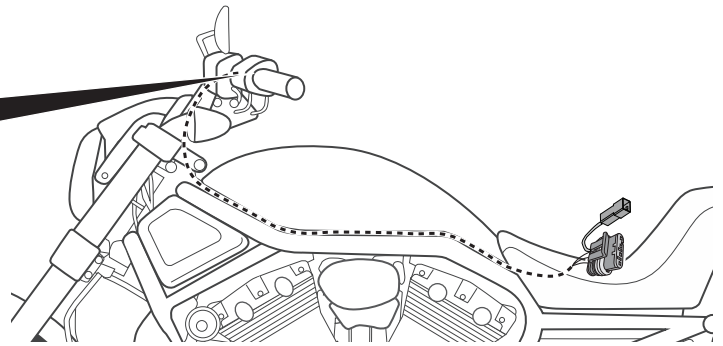
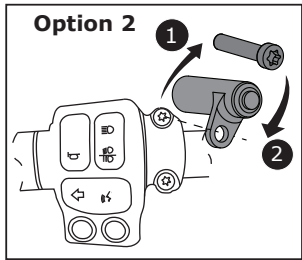
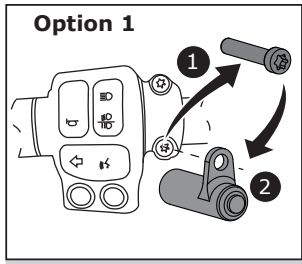
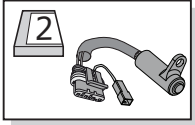

6

Items needed at step 7

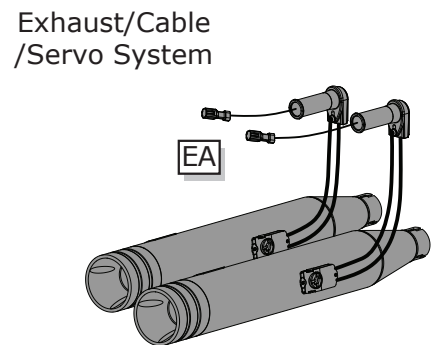
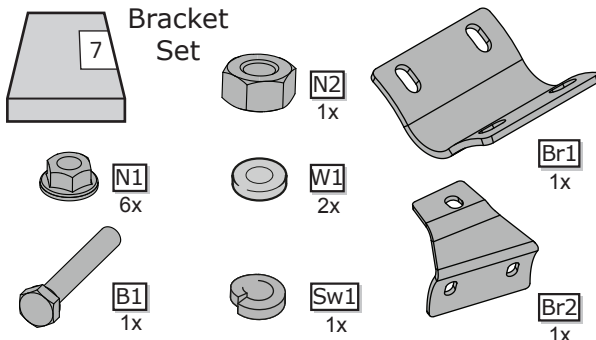
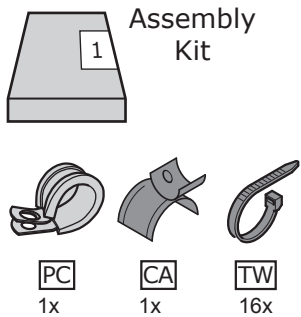
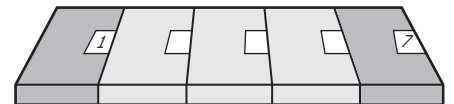

7

1 N1 2x

2 N1 2x

3 N1 2x

4 Br2 Sw1 N1 W1 B1

7Nm 300 km 6x

27Nm 300 km 1x

50Nm 300 km 2x

OEM

5B + EA

5C + EA

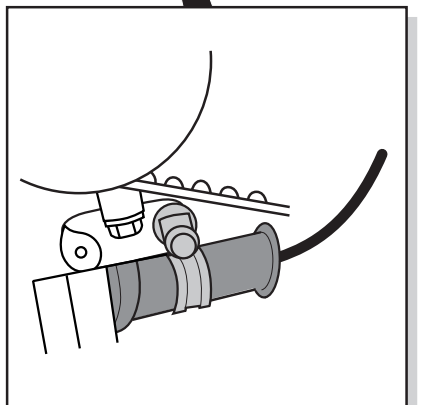
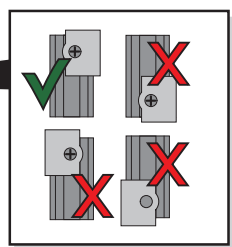
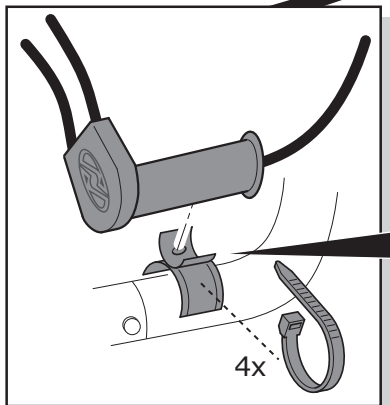
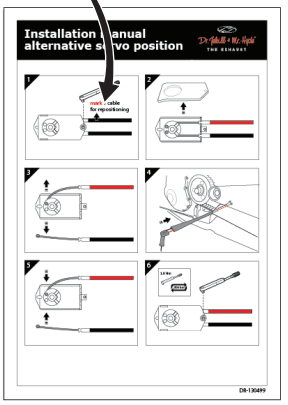
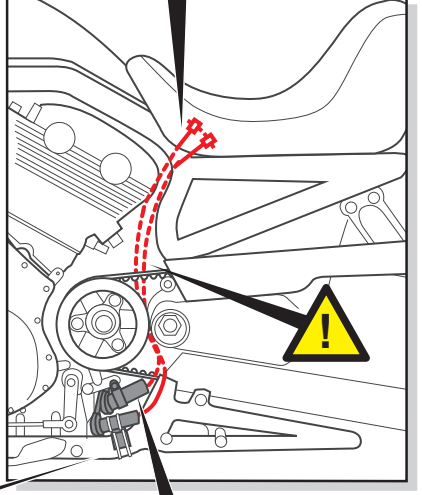
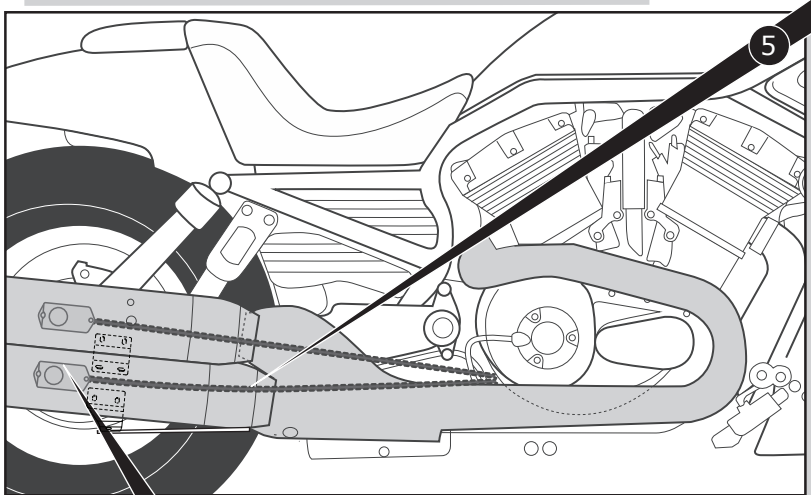

8

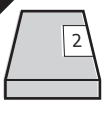

1

Complete System Check!

