



SN.

Dr. Jekyll & Mr. Hyde[®]

THE EXHAUST

MANUAL : HARLEY-DAVIDSON[®] | EASYMOUNT | BLACKBOX



Dyna Switchback

1

Dyna Switchback Easymount Blackbox

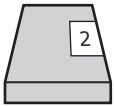
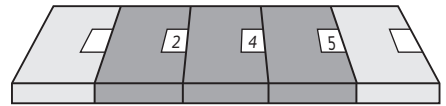

Mode Switch for Blackbox

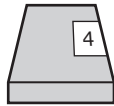
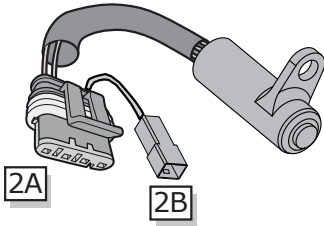

Blackbox

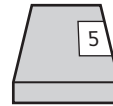
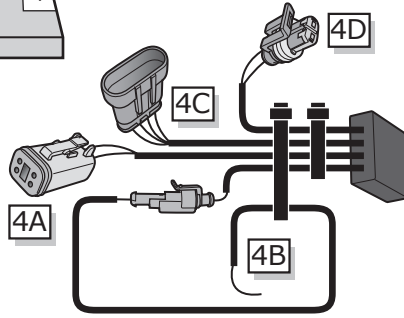

Y Cable

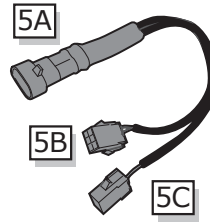

Exhaust/cable/servo system

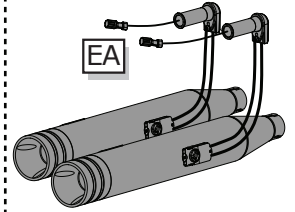

2

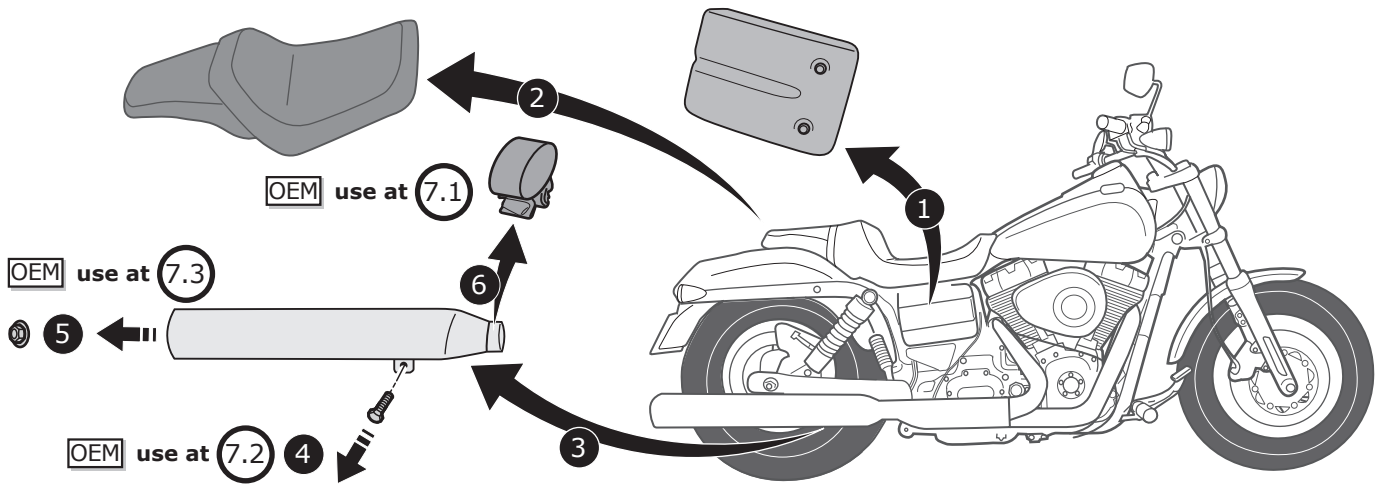

3

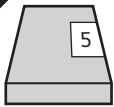

4D + 5A

STEP 7

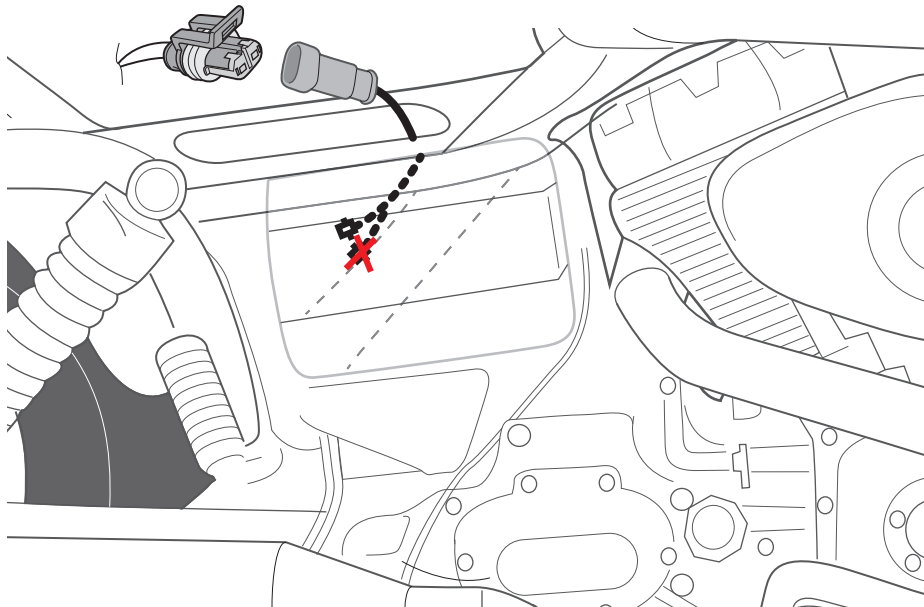

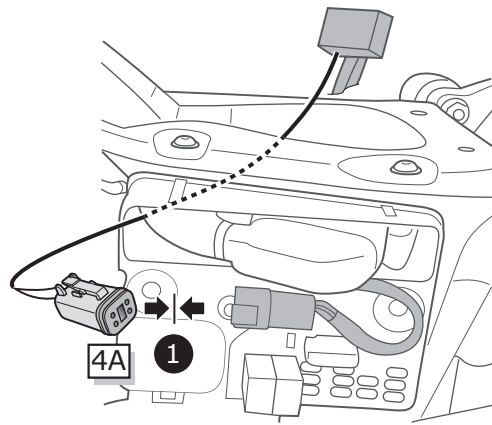
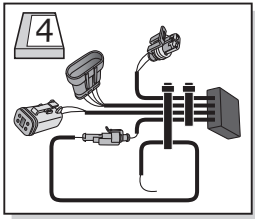

**Option 2
CANBUS**

6 Pole

Speed signal

1

2 3

Option 1

Option 2

NL Groen
DE Grün
GB Green

4B

Option 1

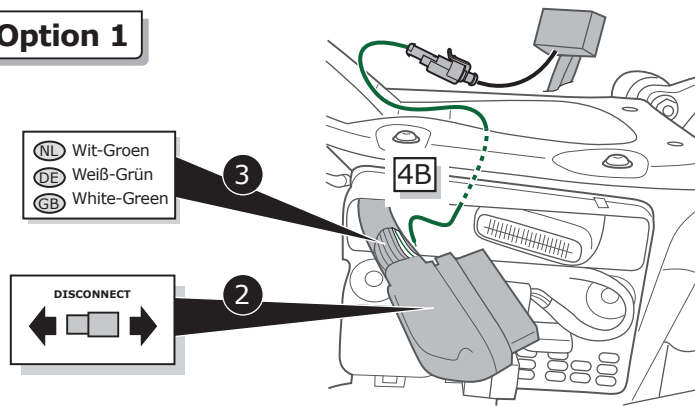

**Option 2
CANBUS**

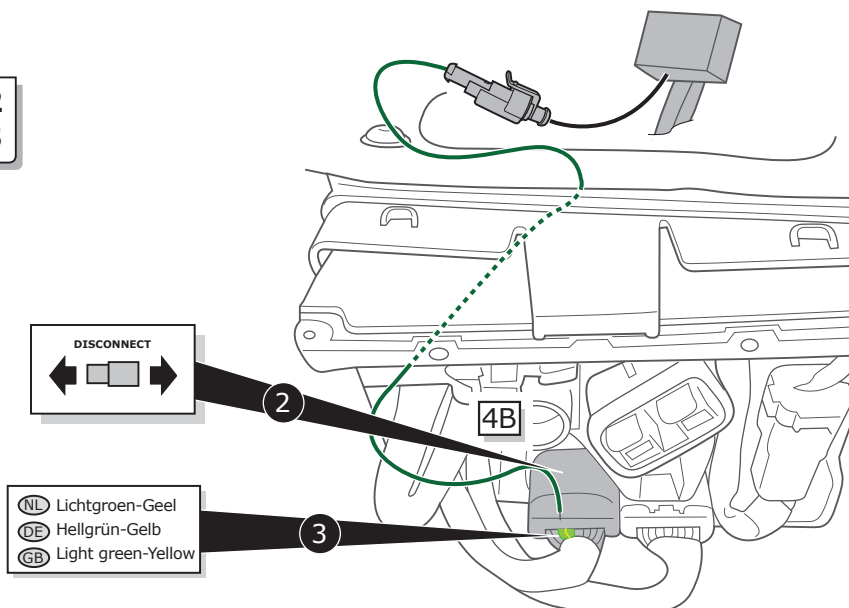

5

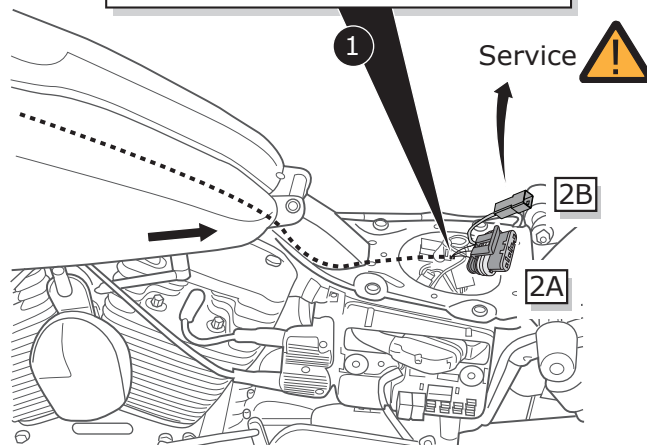
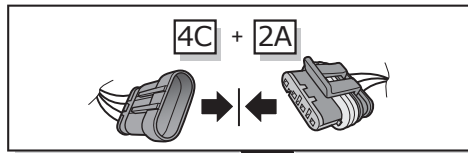
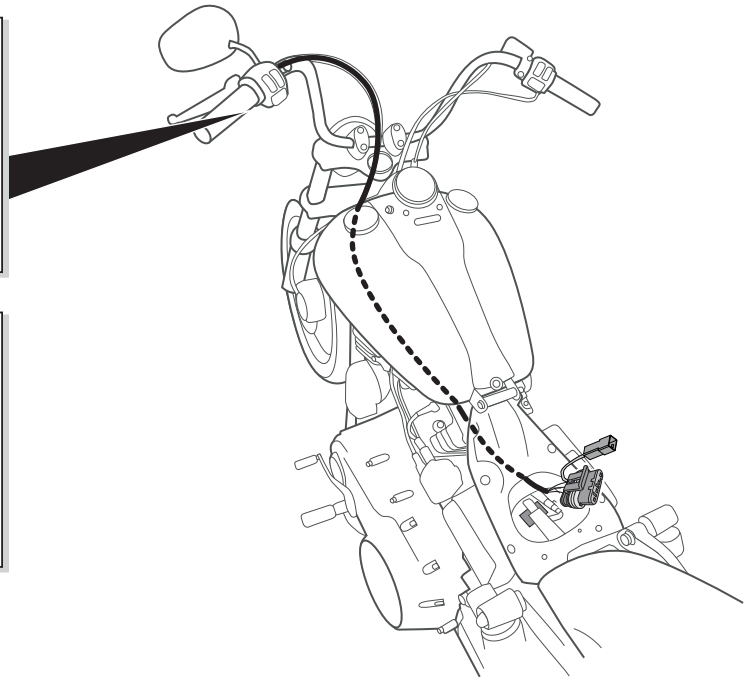
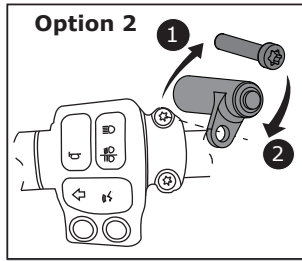
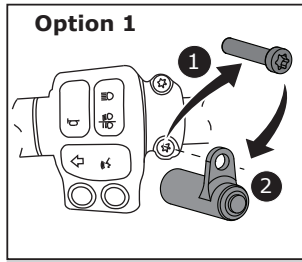
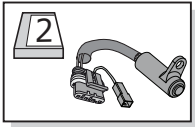

6

Items needed at step 7

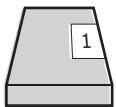
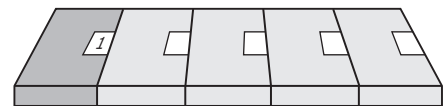

Assembly Kit



TW
6x



PC
1x

Exhaust/Cable
/Servo System

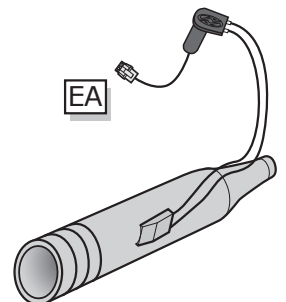

7

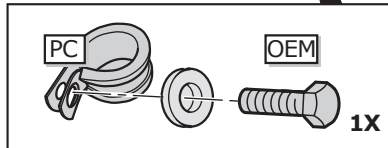
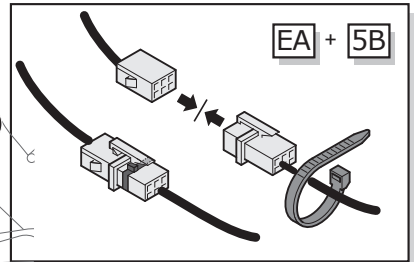
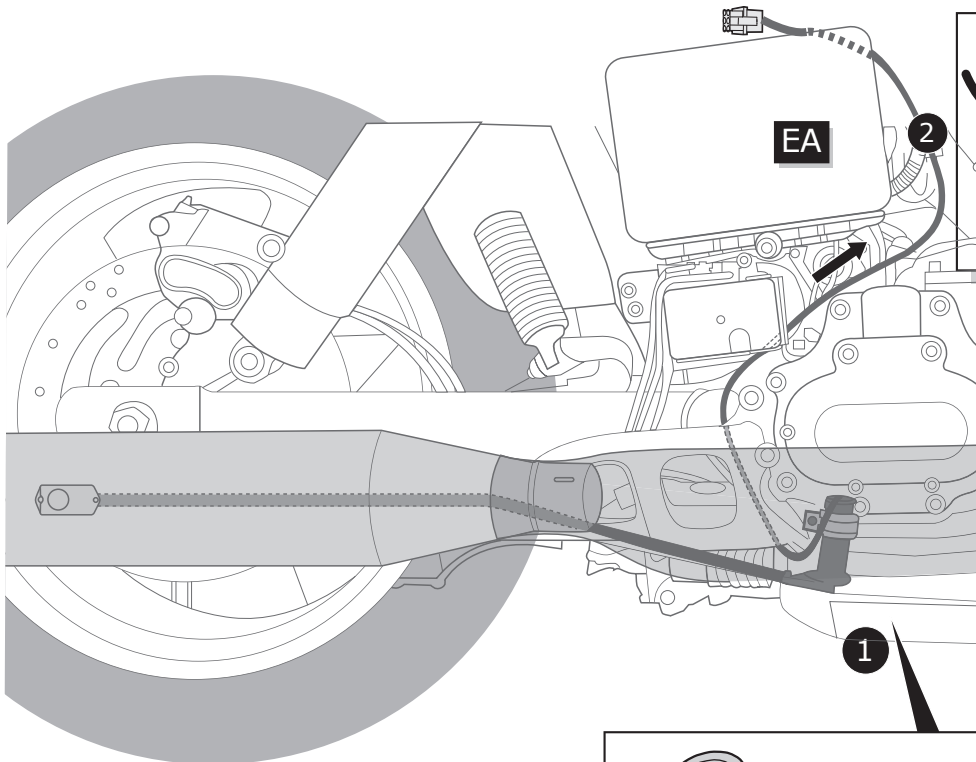
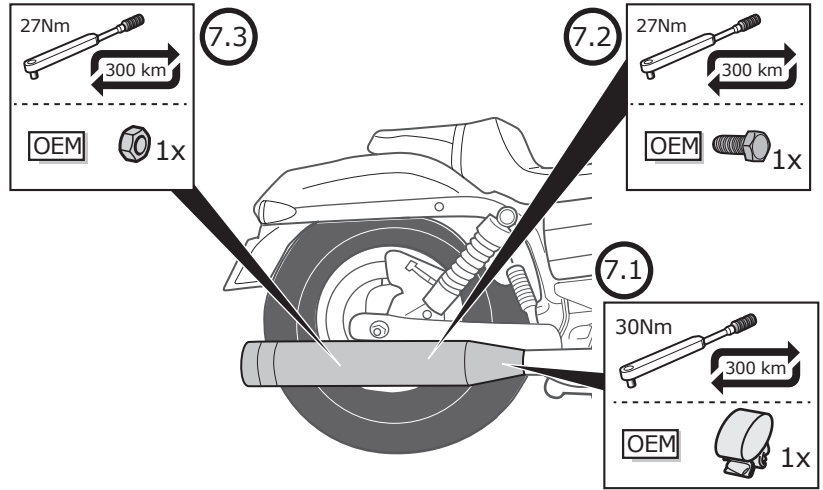
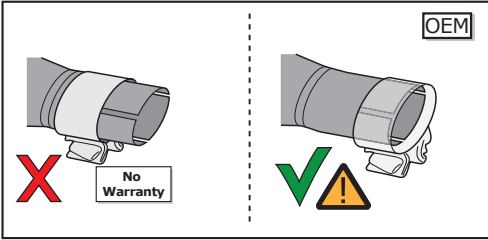
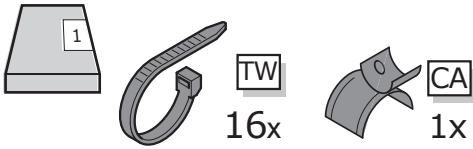

8

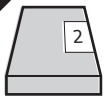

1

Complete System Check!

