



SN. . . . .

# Dr. Jekyll & Mr. Hyde<sup>®</sup>

## THE EXHAUST

MANUAL : HARLEY-DAVIDSON<sup>®</sup> | EASYMOUNT | SMARTBOX 2

### NEW IN THIS MANUAL:

- SMARTBOX 2
- HIROSE CONNECTORS



Sportster V-Strike

1

# Sportster Easymount Smartbox 2

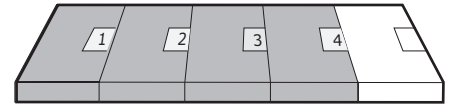

1 Assembly kit

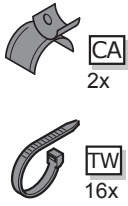

2 Smartbox 2

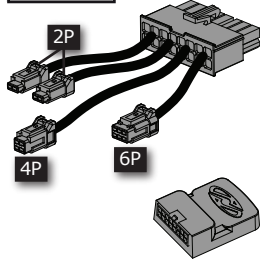

3 Mode Switch for Smartbox 2

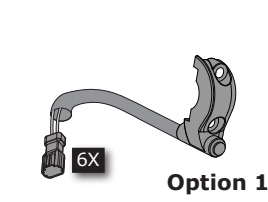

4 Control cable

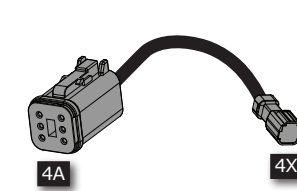

Exhaust/cable/servo system

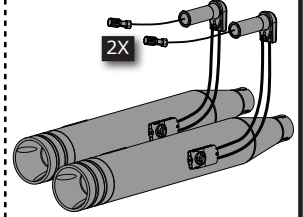

2

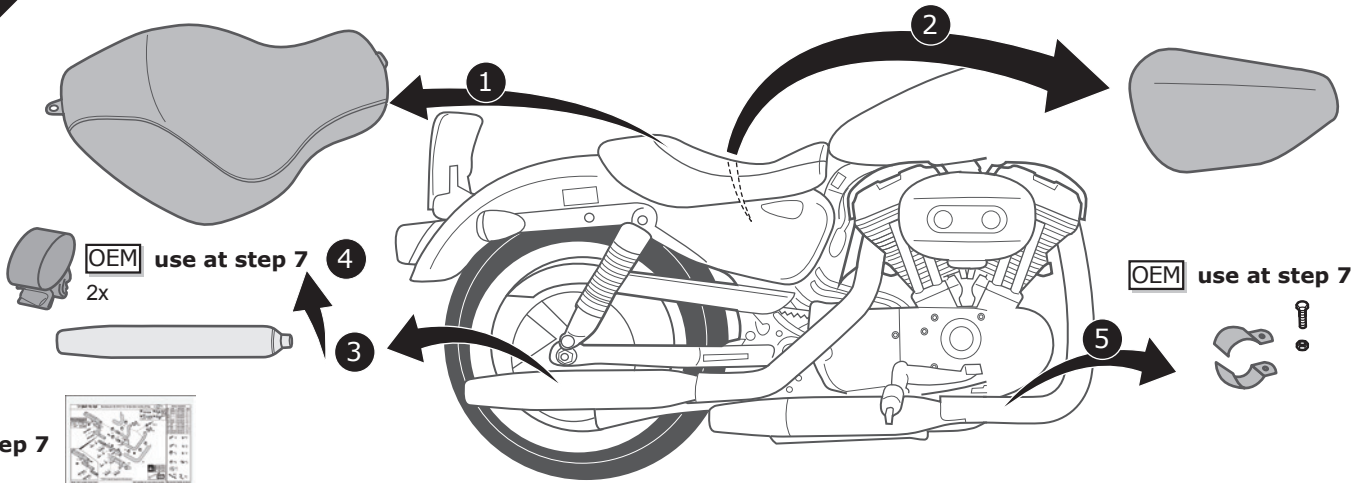

Step 7

3

To mount exhaust use the mountingset

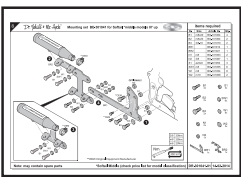
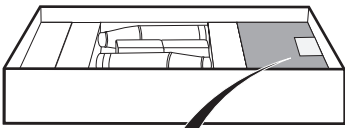

1

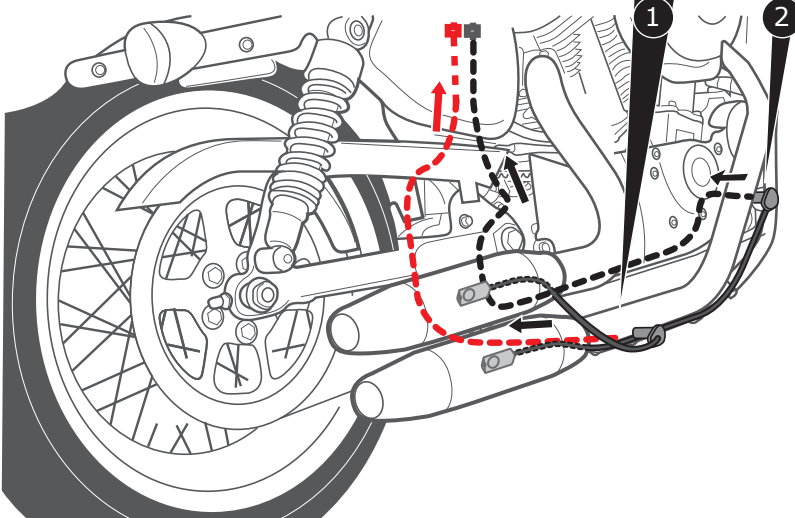
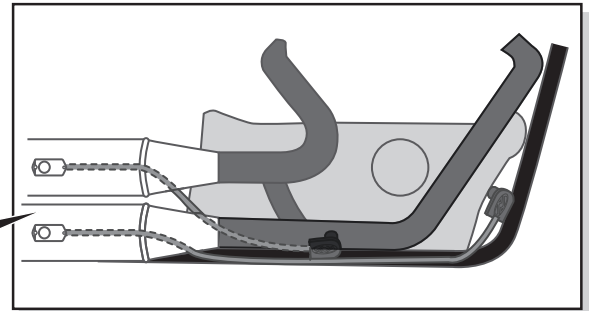
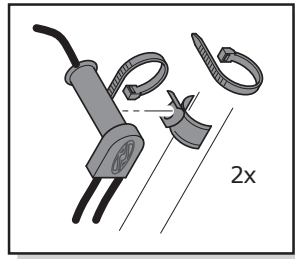

Note: may vary per model

4

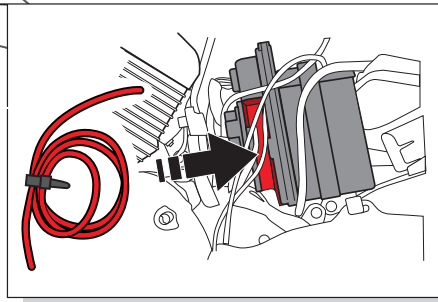
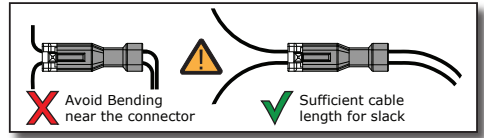
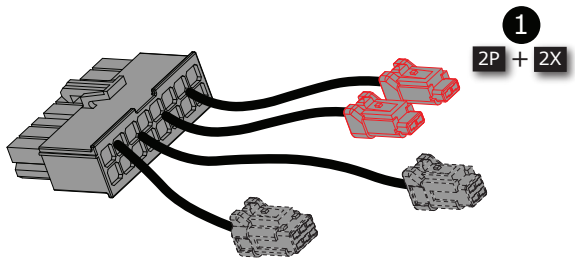
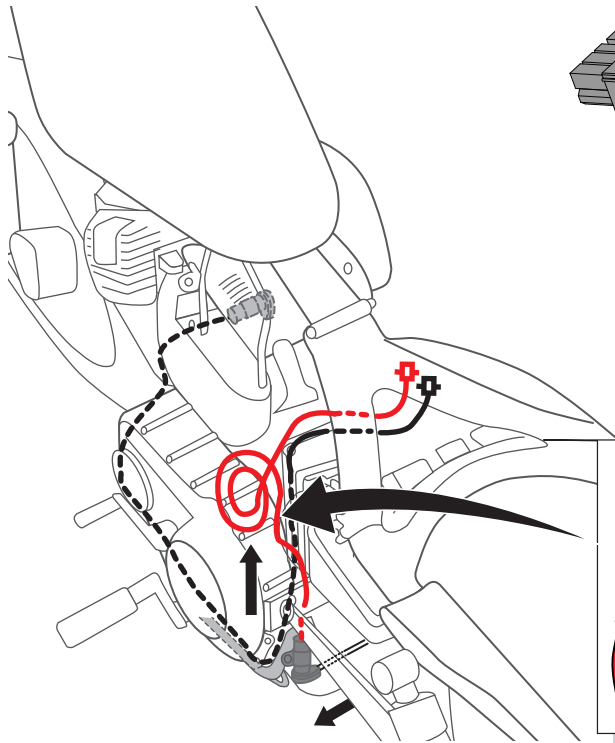
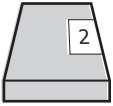

5

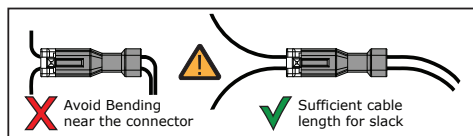
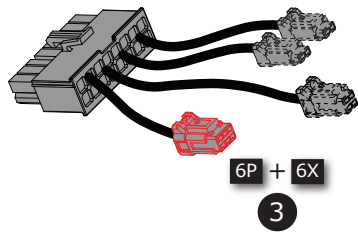
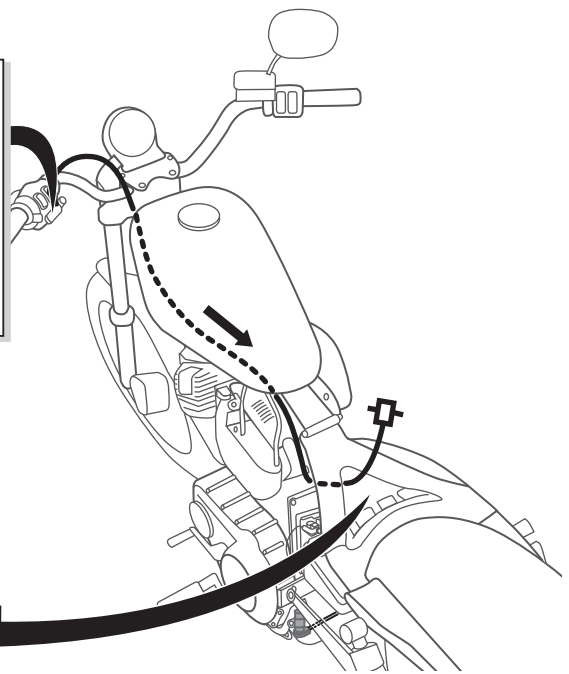
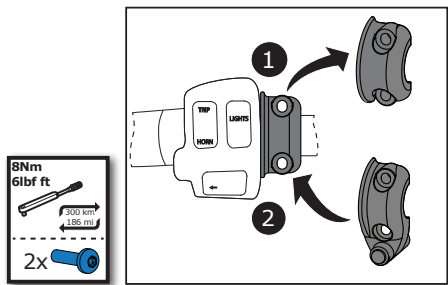
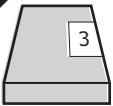

6

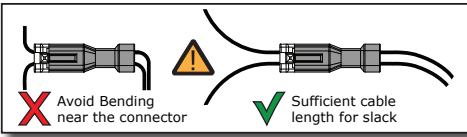
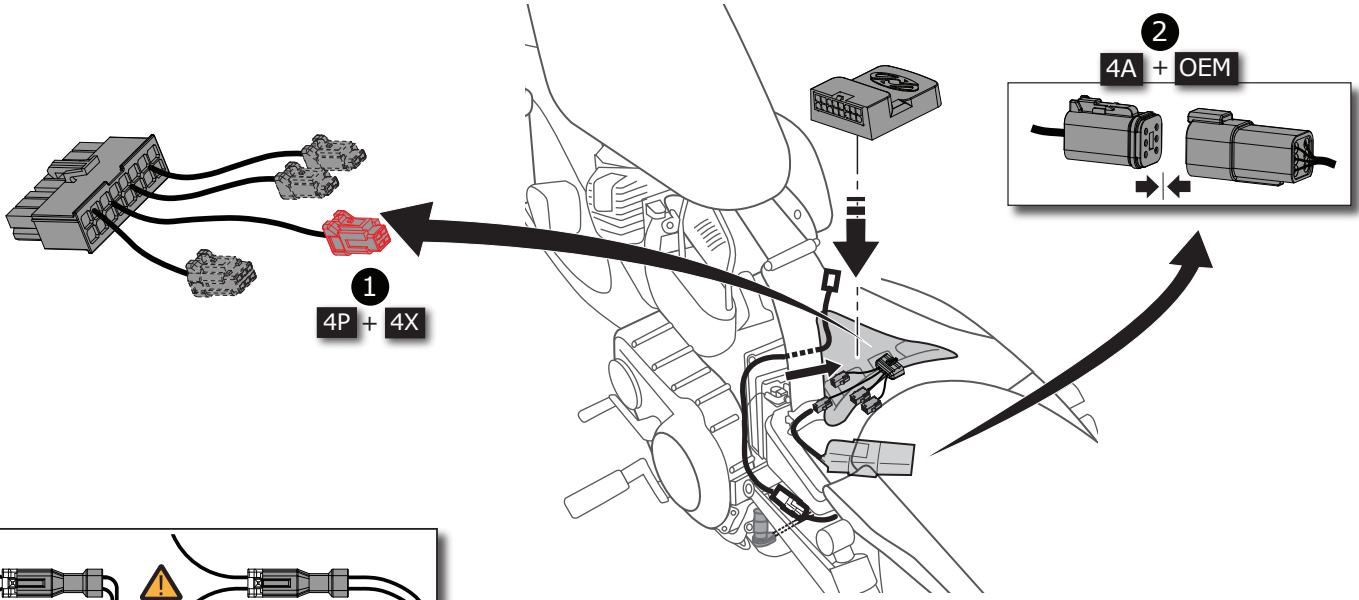

7

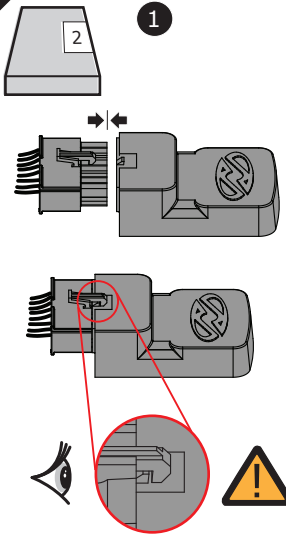

**Complete System Check!**

