



SN.

Dr. Jekyll & Mr. Hyde[®]

THE EXHAUST

MANUAL : HARLEY-DAVIDSON[®] | EASYMOUNT | SMARTBOX 2

NEW IN THIS MANUAL:

- SMARTBOX 2
- EXHAUST MOUNTING
- J&H GASKETS
- SERVO POSITIONS



Sportster
2017->

1

Sportster 2017->

Easymount Smartbox 2

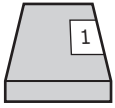
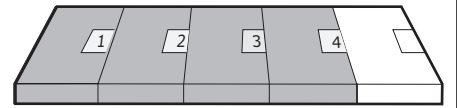

Assembly Kit

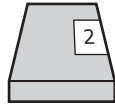
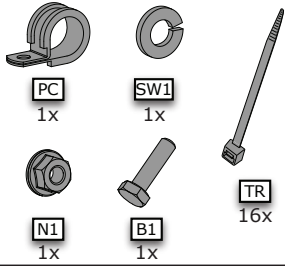

Smartbox 2

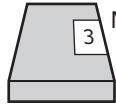
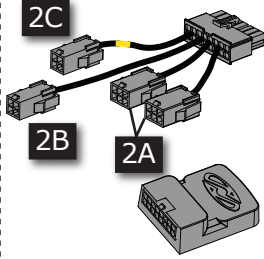

Mode Switch for Smartbox

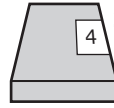
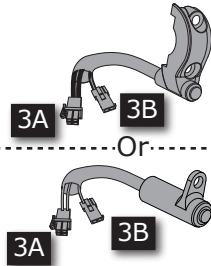

Smartbox Control Cable

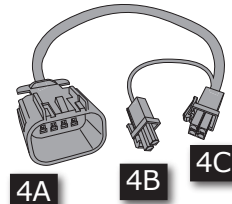

Exhaust/Cable/Servo System

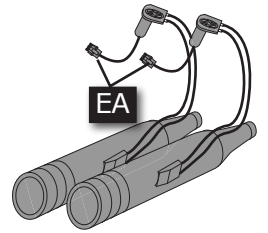

2

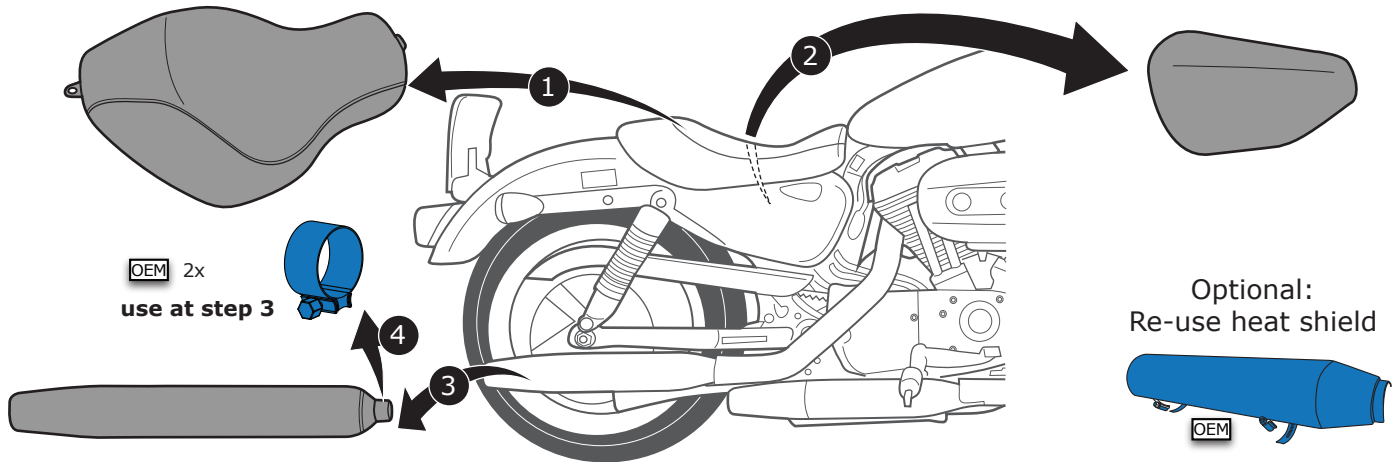

3

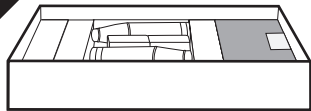

Items required

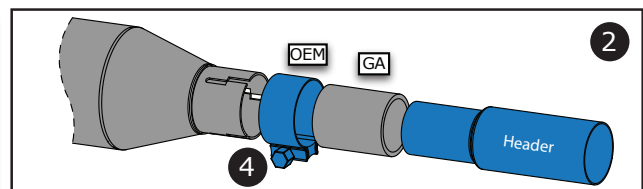
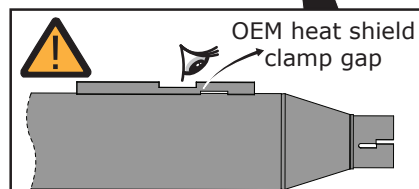
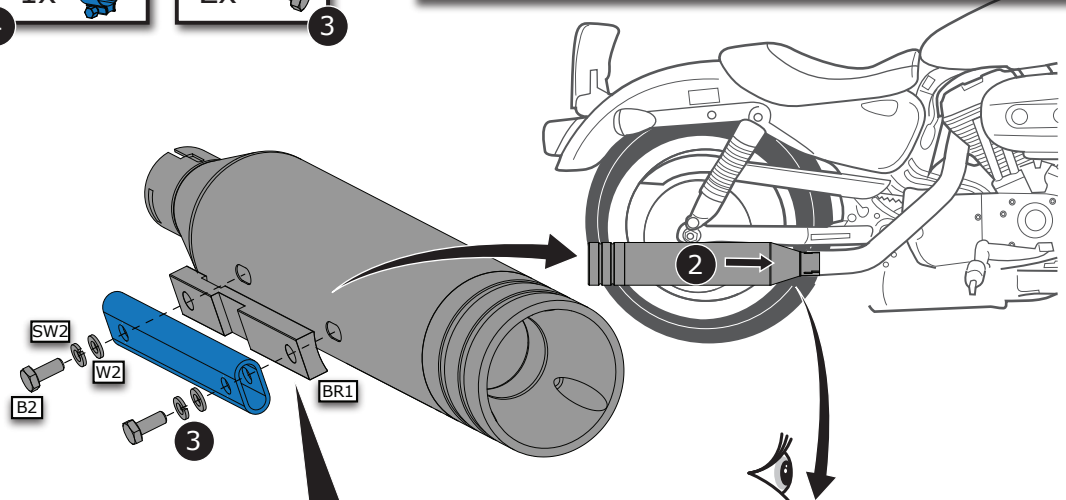
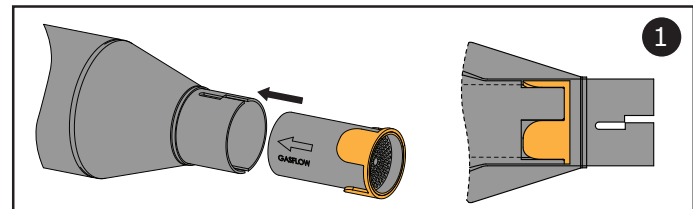
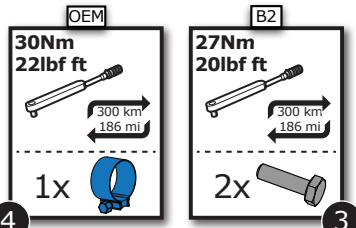
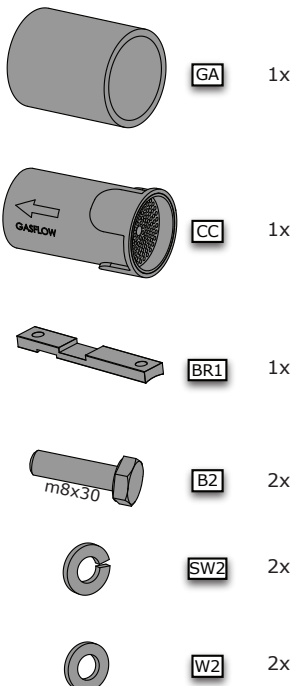

4

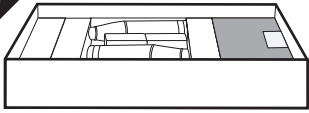

Items required

- GA 1x
- CC 1x
- BR1 1x
- B2 2x
m8x30
- SW2 2x
- W2 2x

OEM	B2
30Nm 22lbf ft	27Nm 20lbf ft
300 km 186 mi	300 km 186 mi
1x	2x

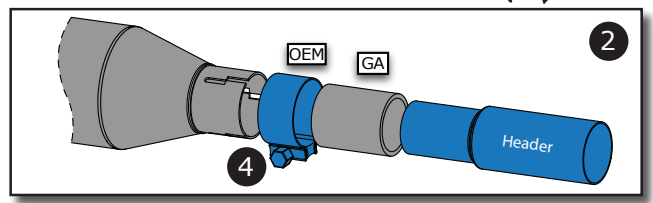
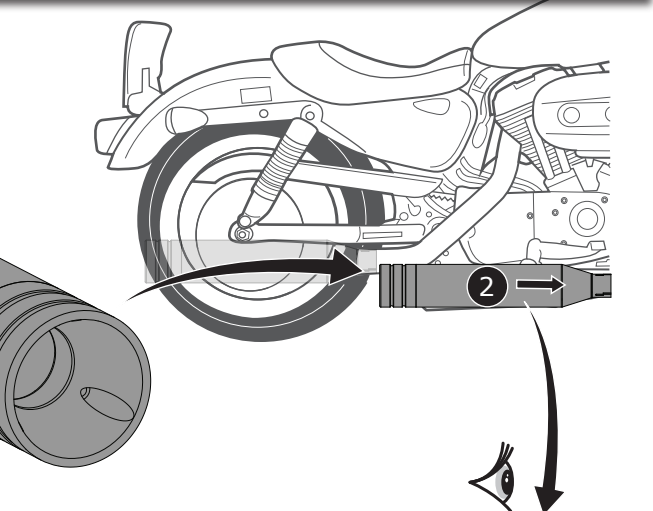
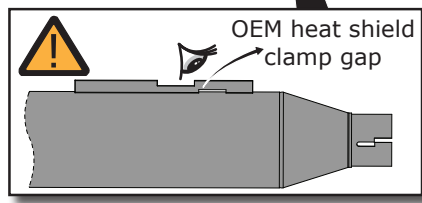
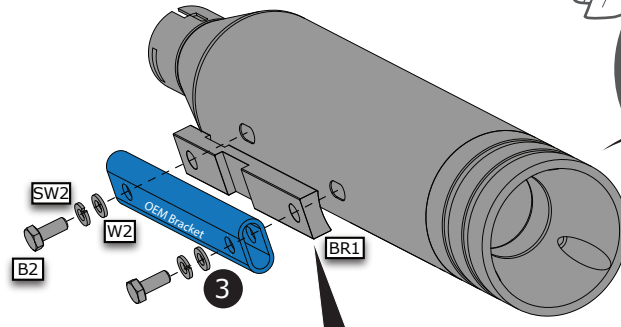
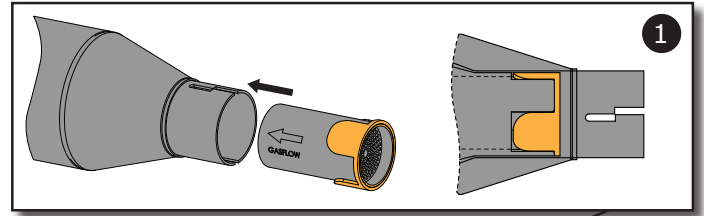

5

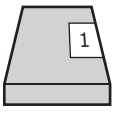
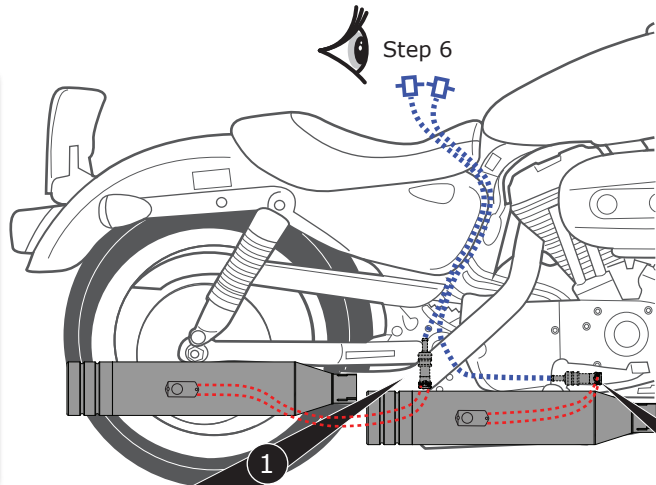
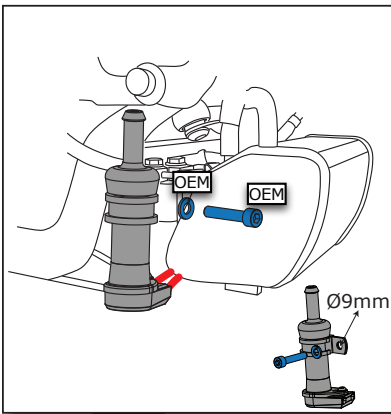

B1
10Nm 7lbf ft
300 km 186 mi
1x

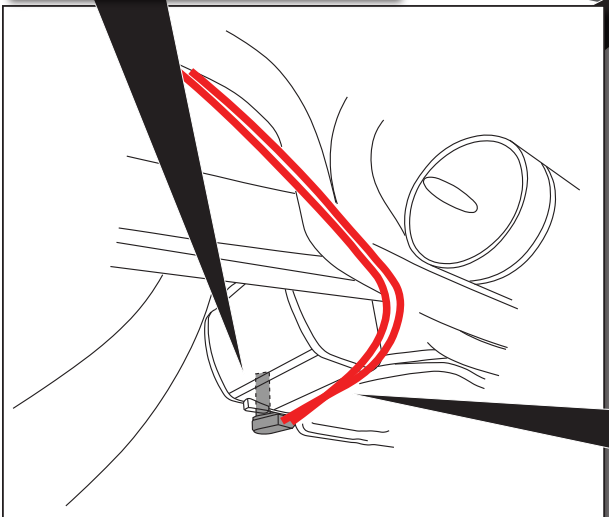

B1
SW1
PC
N1
Ø7mm

Use ty-raps to ensure enough ground clearance

