



SN. . . . .

# Dr. Jekyll & Mr. Hyde<sup>®</sup>

## THE EXHAUST

MANUAL : **BMW<sup>®</sup>** | **EASYMOUNT** | **SMARTBOX 2**

### NEW IN THIS MANUAL:

- SMARTBOX 2 POSITION
- HIROSE CONNECTORS



R 1200 RT

2015 » Up

# R 1200 RT

## Easymount Smartbox 2

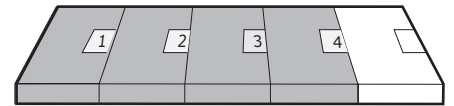

1

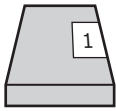

Assembly Kit

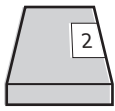
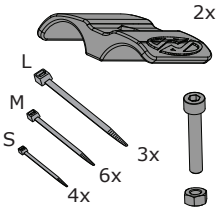

Smartbox 2

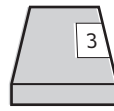
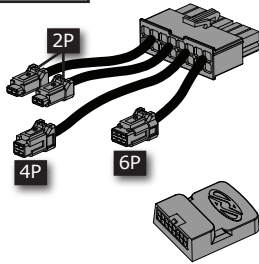

Mode Switch for Smartbox

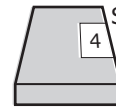
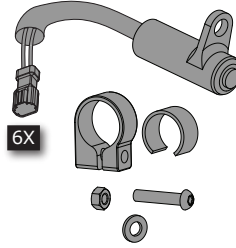

Smartbox Control Cable

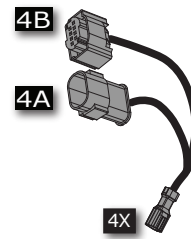

Exhaust/Cable /Servo System

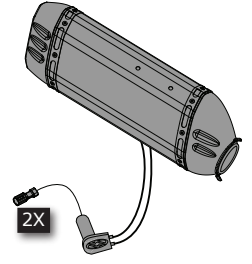

2

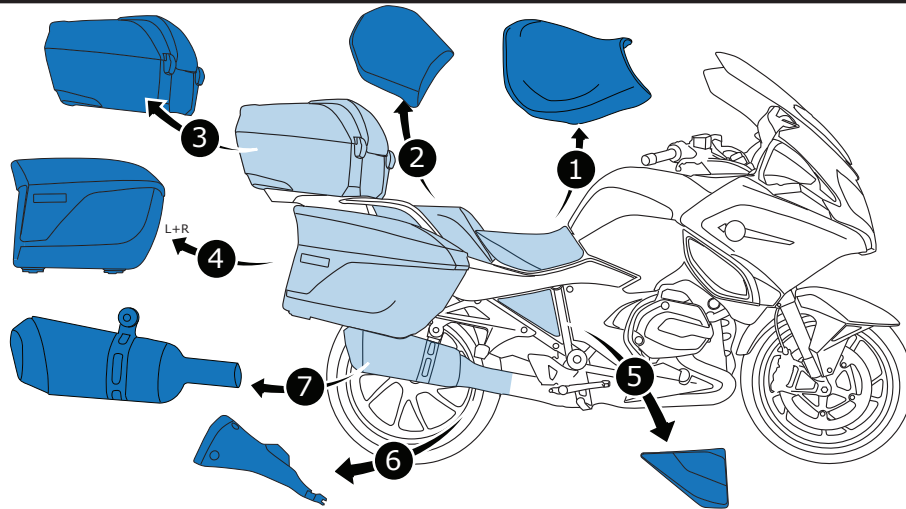

3

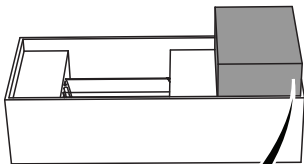

Items required



To mount the exhaust use the mountingset + manual

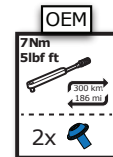
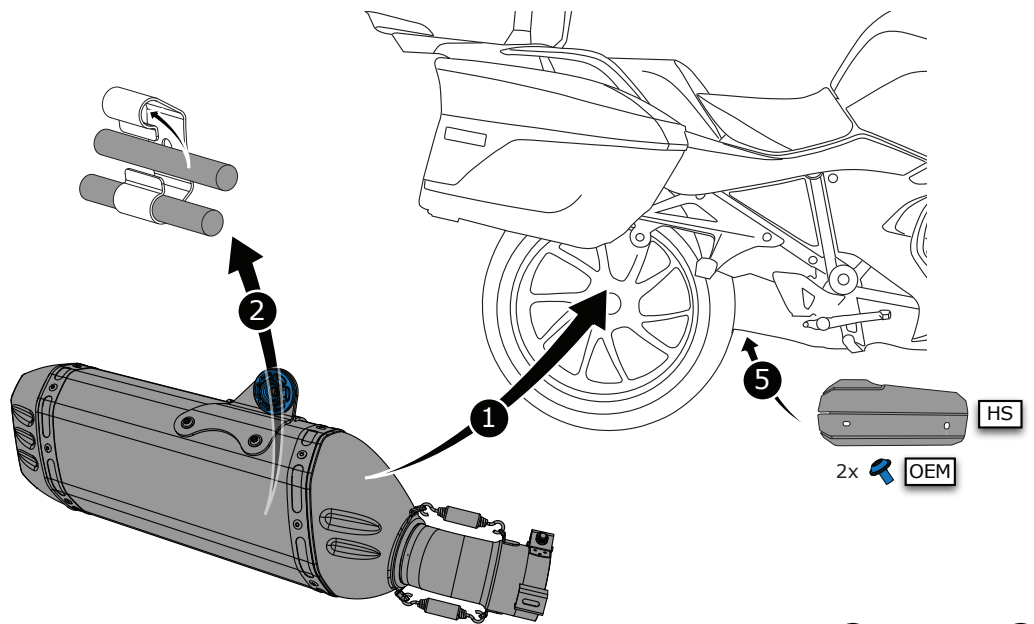
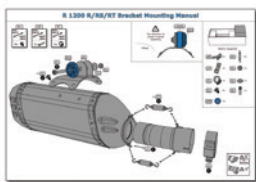

4

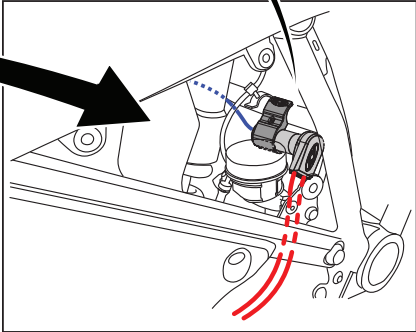
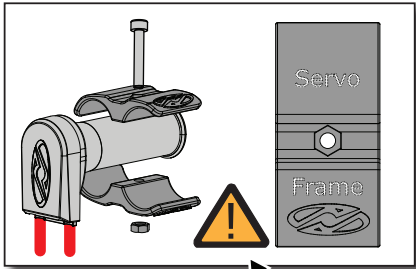
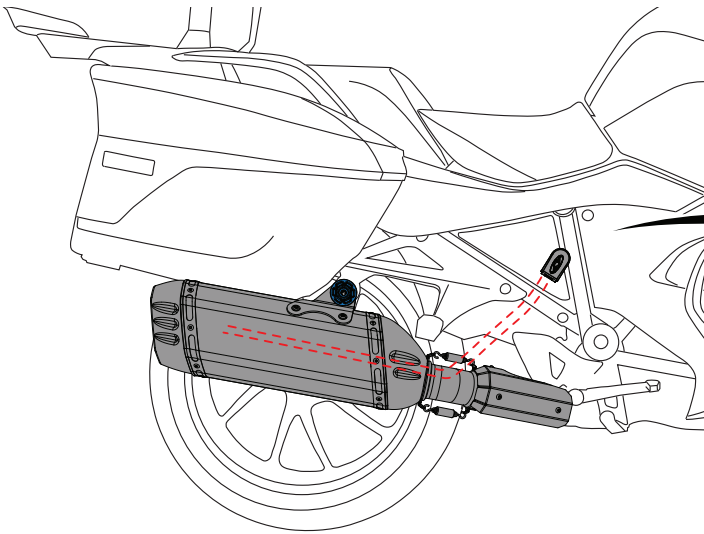
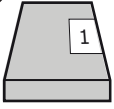

Cable routing & connecting  
step 7

5

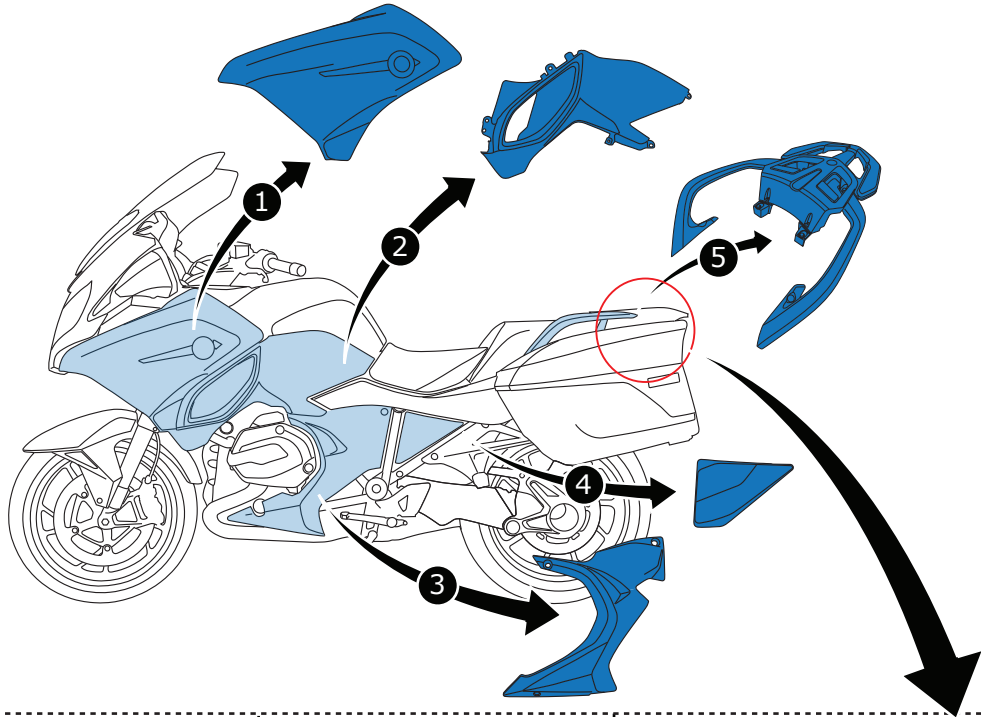
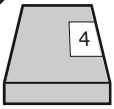

Current situation

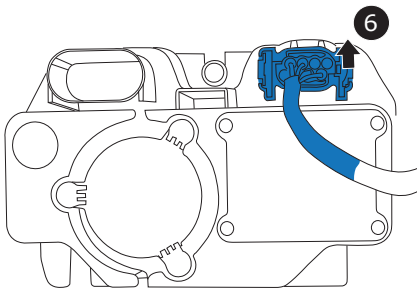

Connect control cable

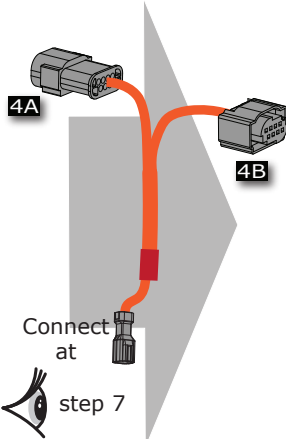

New situation

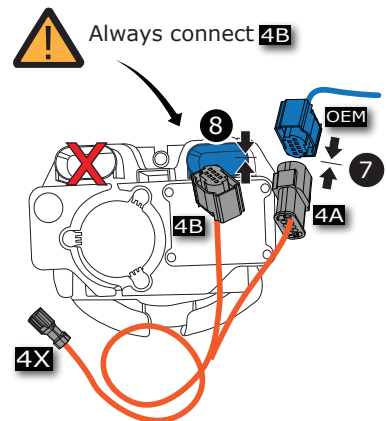

**6**

3

Cable routing & connecting

step 7

**Option 1**

OEM

8 Nm  
6lbf ft

300 km  
186 mi

1x

**Option 2**

2 Nm  
1.5 lbf ft

4000 mi  
6400 km

1x

**7**

2

In reality all cables are black

**8**

2

1

2

**Complete System Check!**