



SN.

Dr. Jekyll & Mr. Hyde[®]

THE EXHAUST

MANUAL : **BMW[®]** | **EASYMOUNT** | **SMARTBOX 2**

NEW IN THIS MANUAL:
- SMARTBOX 2



R 1200 GS-AC Adventure

2010 - 2012

1

R 1200 GS-AC Adventure 2010-2012

Easymount Smartbox 2

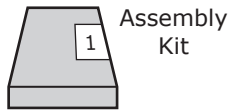
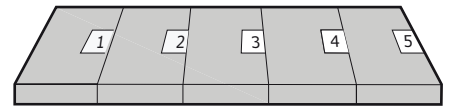

Assembly Kit

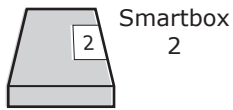
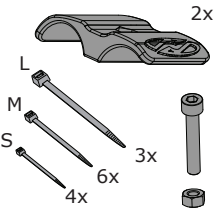

Smartbox 2

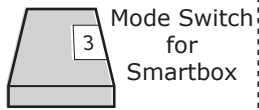
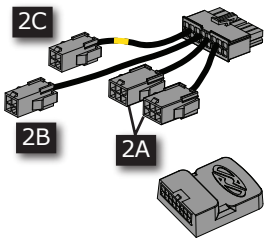

Mode Switch for Smartbox

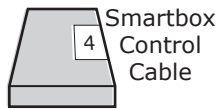
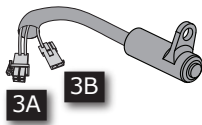

Smartbox Control Cable

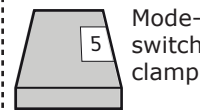
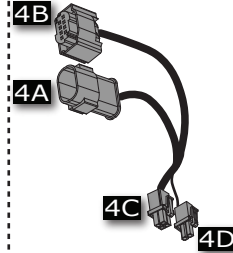

Mode-switch clamp

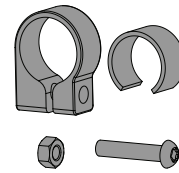

Exhaust/Cable /Servo System

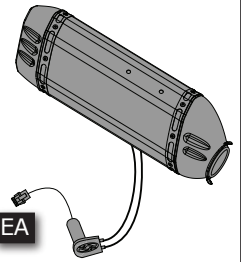

2

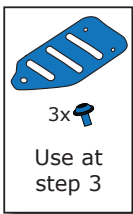
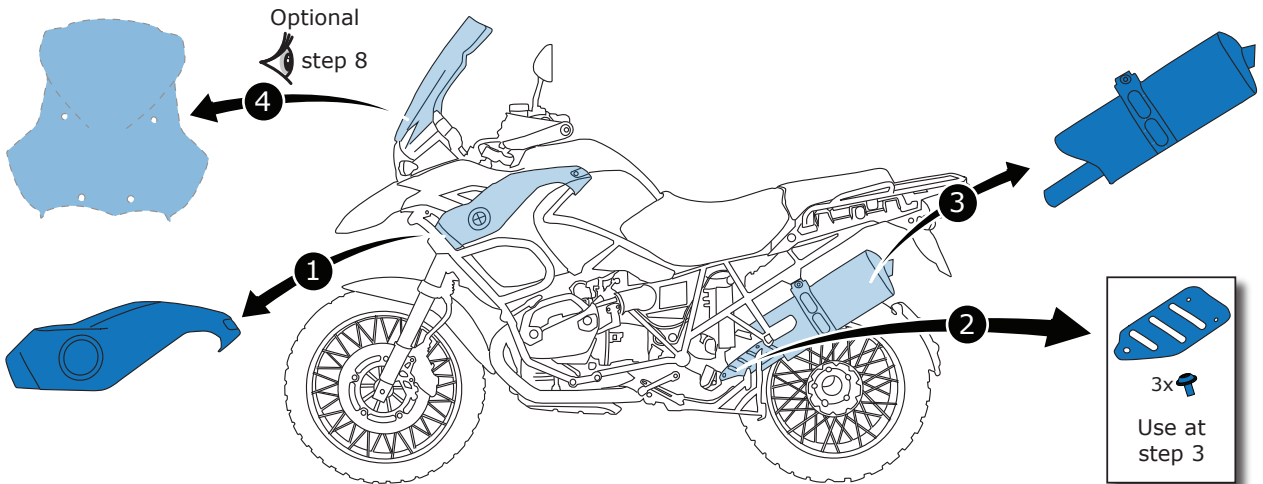

3

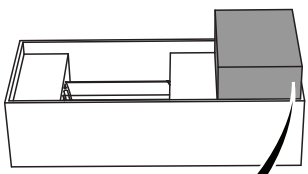

Items required



To mount the exhaust use the mountingset + manual

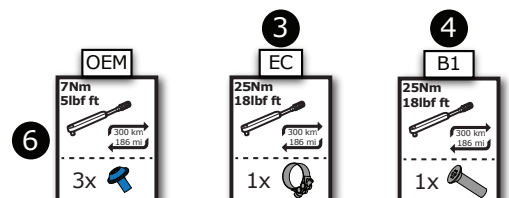
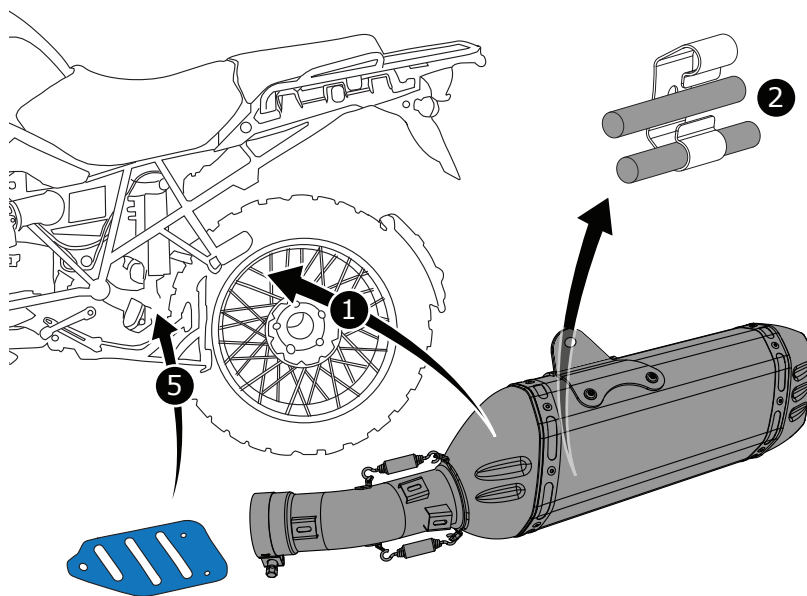
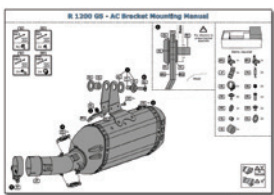

4

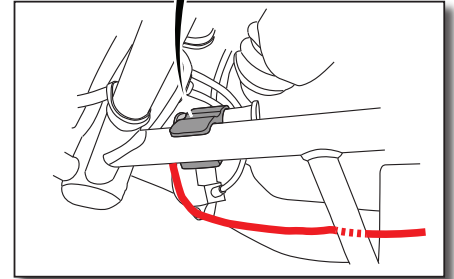
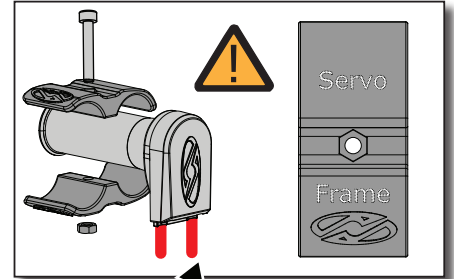
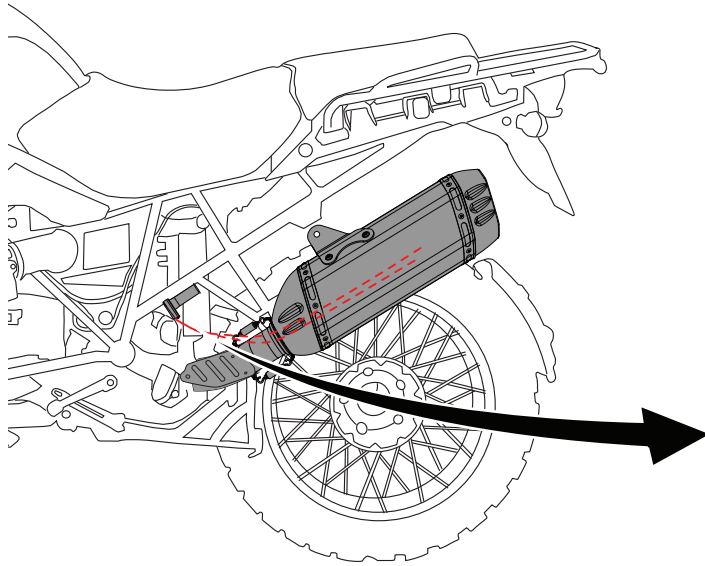
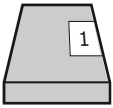

5

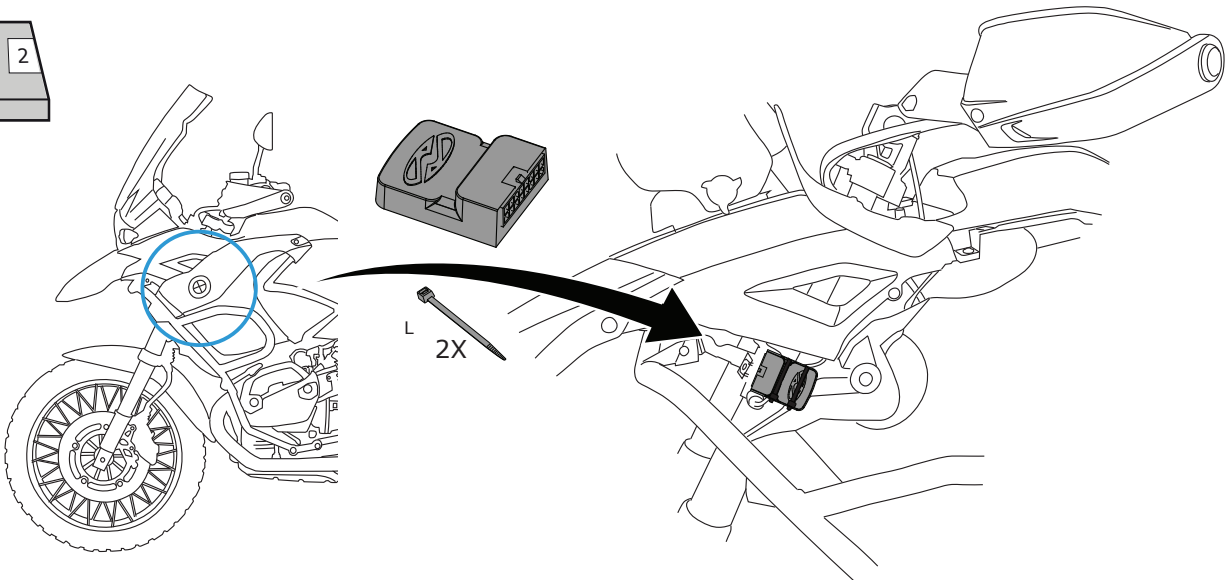
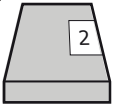

6

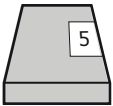
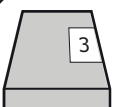

Ty-wrap cable to brake line

4

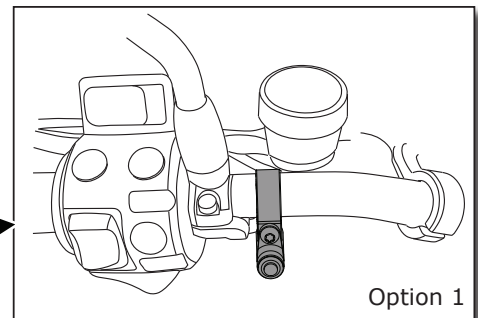
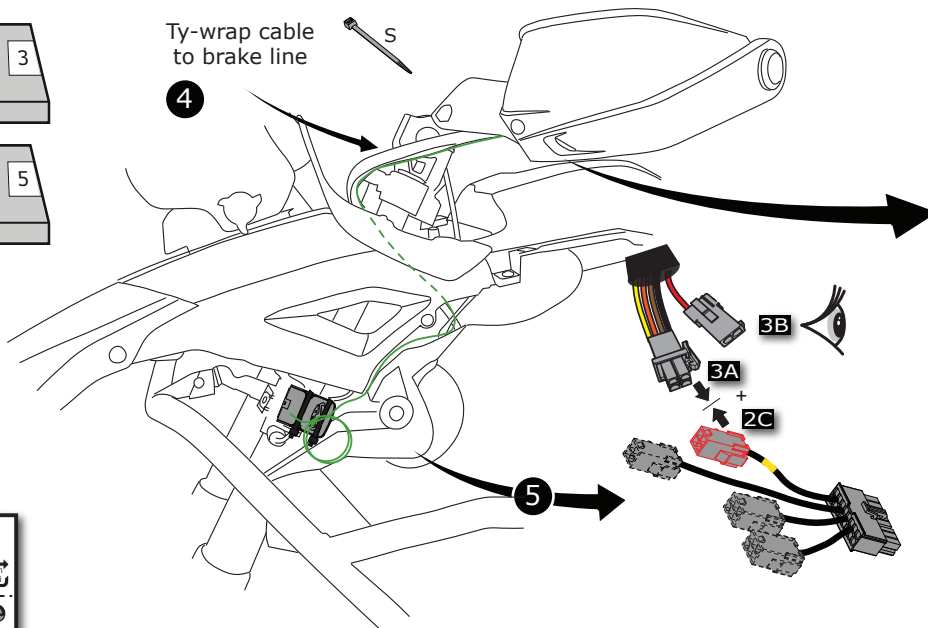

Option 1

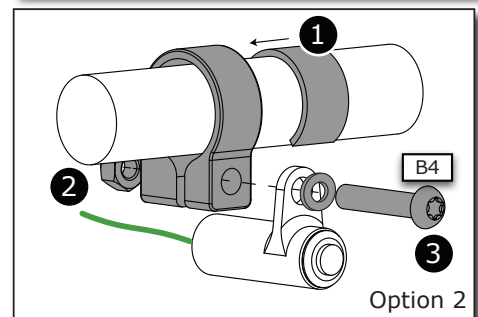

Option 2

B4

2 Nm
1,5 lbf ft



1x

7

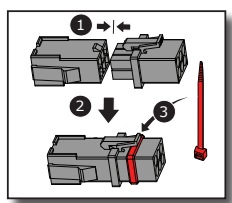
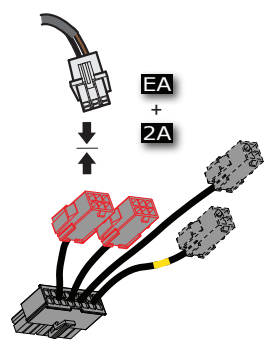
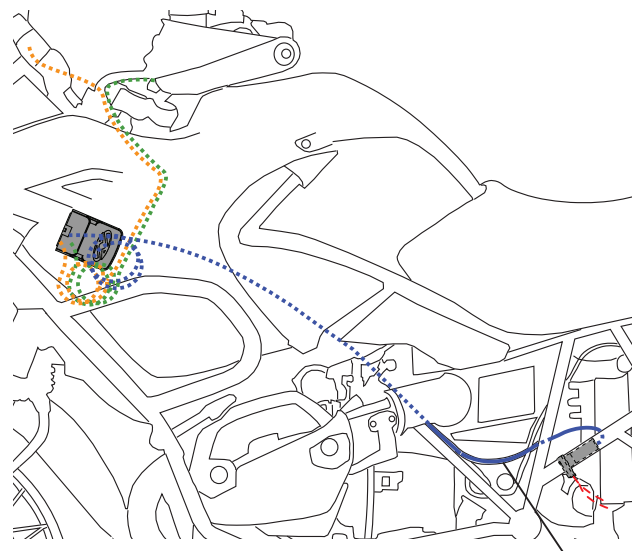

In reality all cables are black

Follow brake line

8

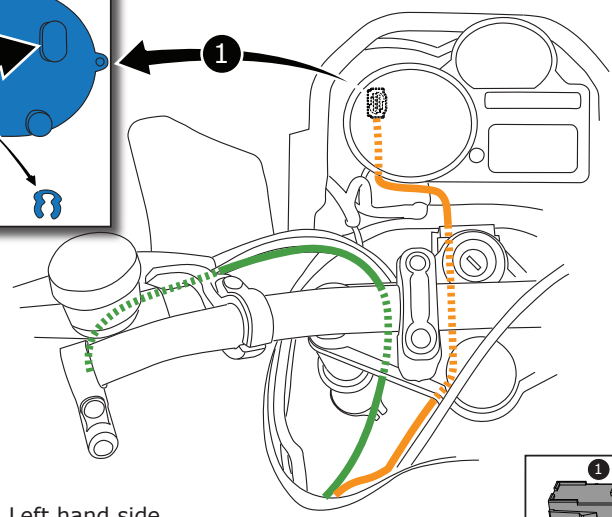
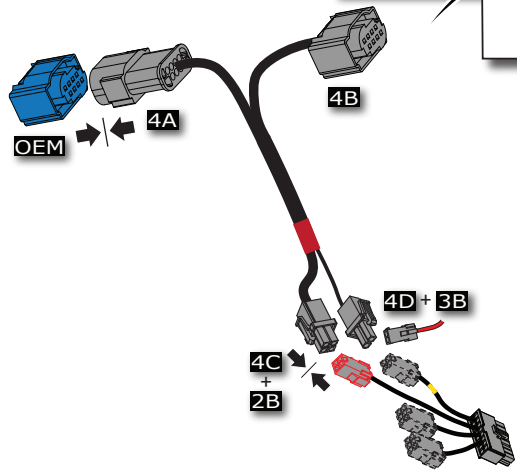
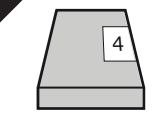
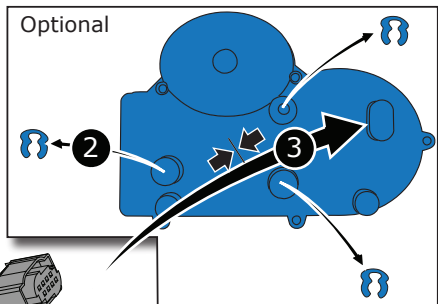

Left hand side cable routing:

step 7

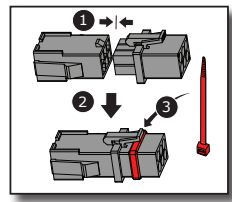

9

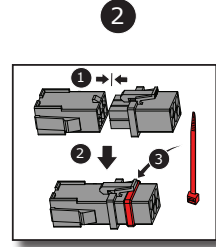
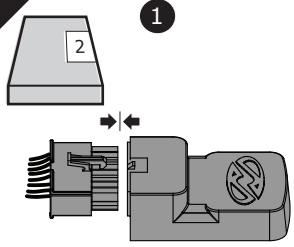

Complete System Check!

