



SN. . . . .

# Dr. Jekyll & Mr. Hyde®

## THE EXHAUST

MANUAL : BMW® | EASYMOUNT | SMARTBOX 2

### NEW IN THIS MANUAL:

- SMARTBOX 2 POSITION
- HIROSE CONNECTORS



R 1200 GS-LC Adventure

2014 » Up

1

# R 1200 GS-LC Adventure

## Easymount Smartbox 2

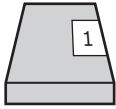
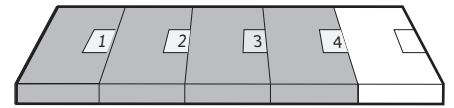

Assembly Kit

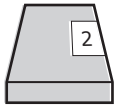
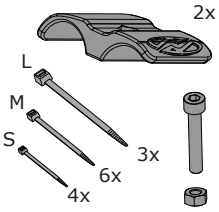

Smartbox 2

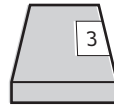
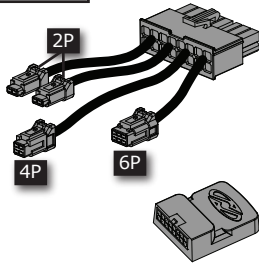

Mode Switch for Smartbox

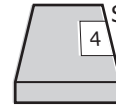
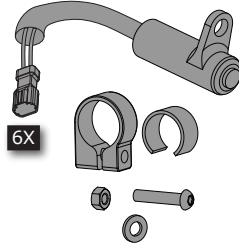

Smartbox Control Cable

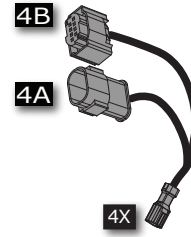

Exhaust/Cable /Servo System

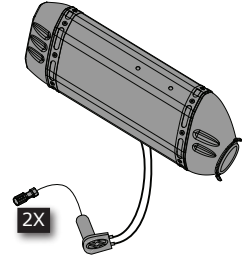

2

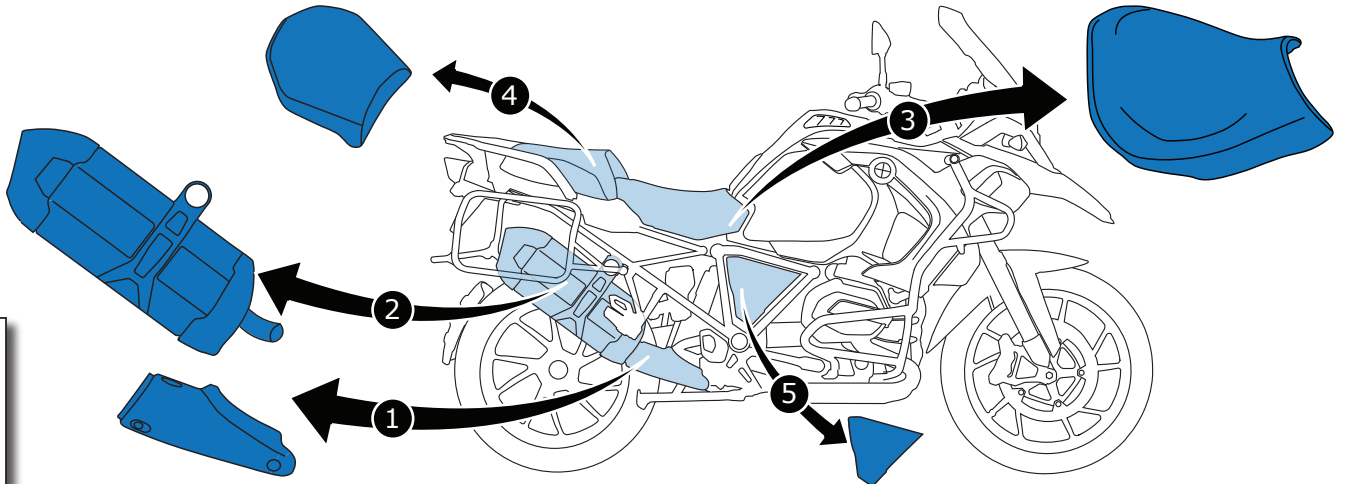

3

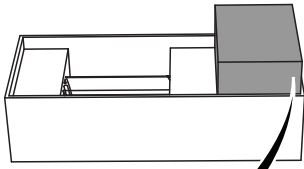

Items required



To mount the exhaust use the mountingset + manual

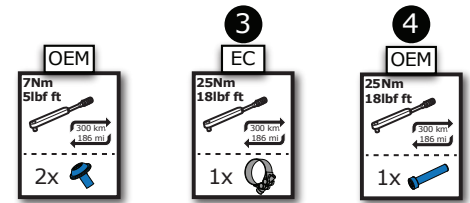
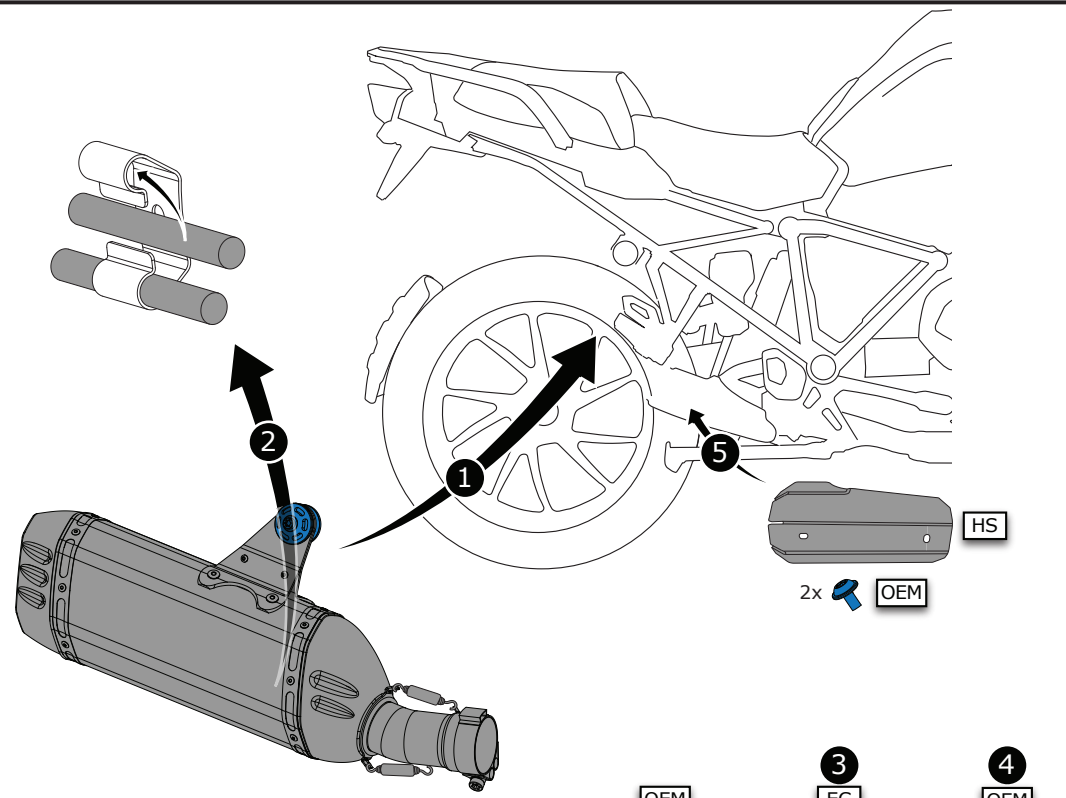
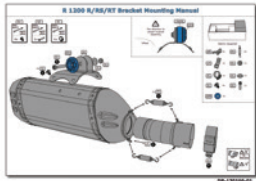

4

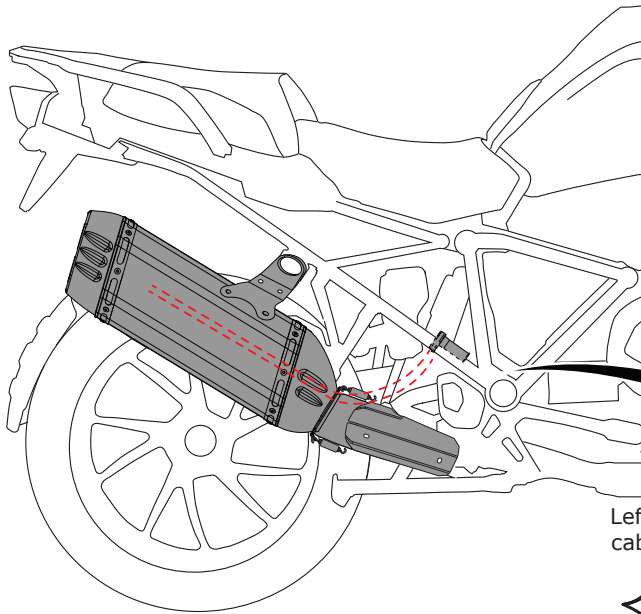
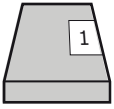

Left hand side cable routing:

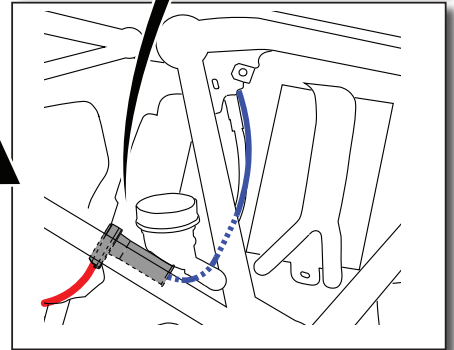
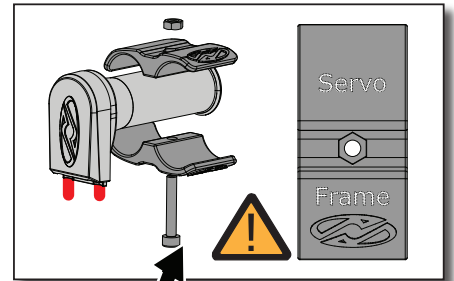

5

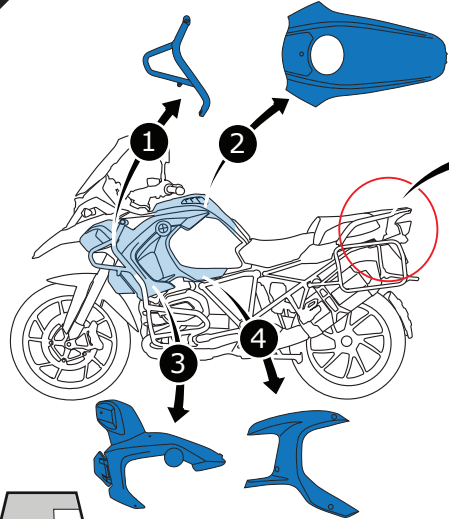

Current situation

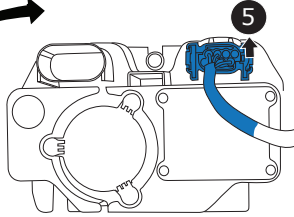

Connect control cable

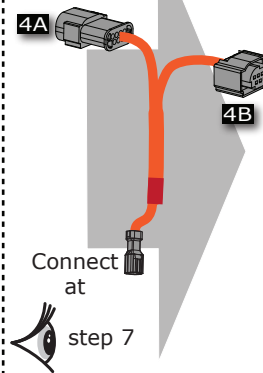

New situation

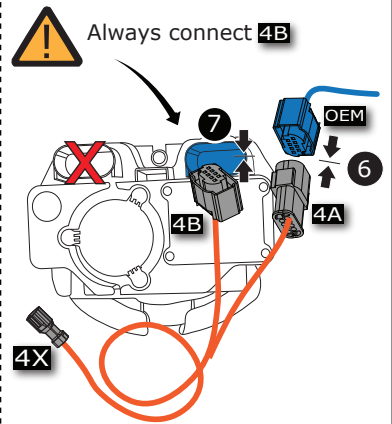

The alarm unit can be accessed in one of two manners:

Option 1: From below

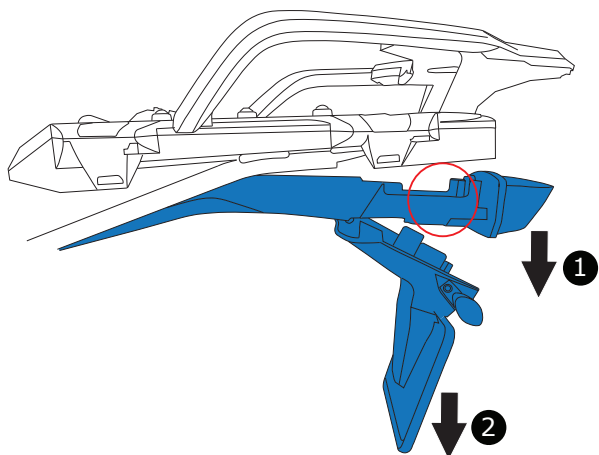

Option 2: From the top

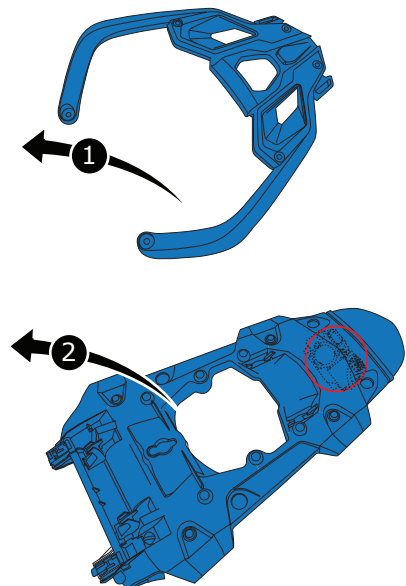

**6**

Or

Left hand side

Right hand side

2 Nm  
1,5 lbf ft  
170 mm  
186 mm  
1x

B4

8 Nm  
6 lbf ft  
300 mm  
186 mm  
1x

OEM

**7**

In reality all cables are black

2P + 2X

4P + 4X

6P + 6X

X Avoid Bending near the connector

✓ Sufficient cable length for slack

**8**

2

1

Complete System Check!

1

2

3

4

5

6

7