



SN.

Dr. Jekyll & Mr. Hyde®

THE EXHAUST

MANUAL : BMW® | EASYMOUNT | SMARTBOX 2

NEW IN THIS MANUAL:

- SMARTBOX 2 POSITION
- HIROSE CONNECTORS



R 1200 GS-LC

2013 » Up

R 1200 GS-LC

Easymount Smartbox 2

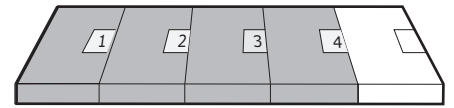

1

1 Assembly Kit

2 Smartbox 2

3 Mode Switch for Smartbox

4 Smartbox Control Cable

Exhaust/Cable /Servo System

2

Use at step 3

3

Items required

HS 1x

To mount the exhaust use the mountingset + manual

OEM

7Nm
5lbf ft

300 km
186 mi

2x

EC

25Nm
18lbf ft

300 km
186 mi

1x

OEM

25Nm
18lbf ft

300 km
186 mi

1x

4

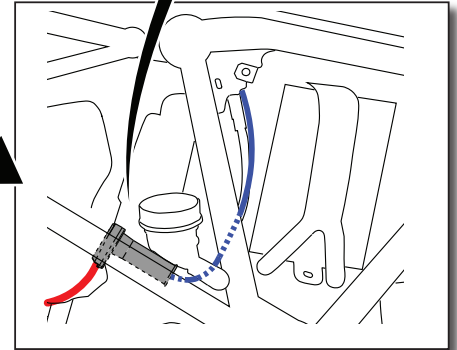
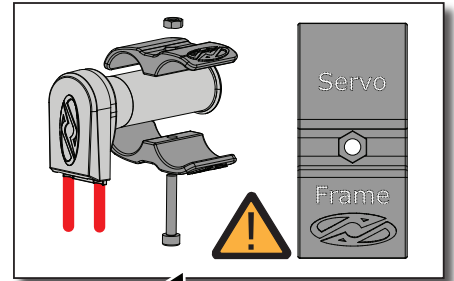
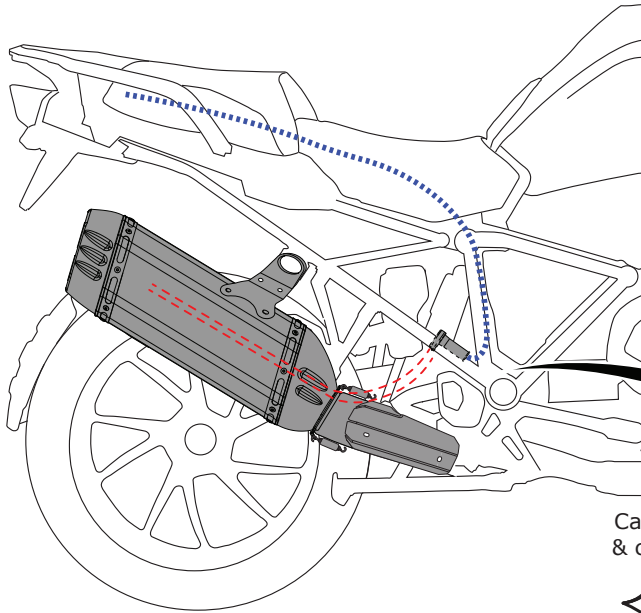
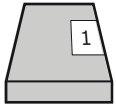

Cable routing & connecting:



5

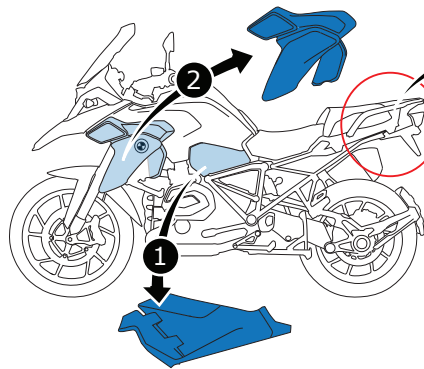

Current situation

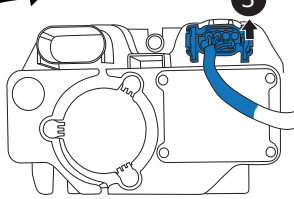

Connect control cable

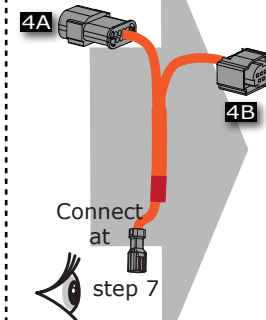

New situation

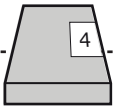
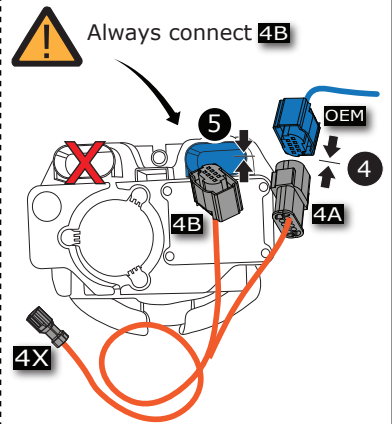

The alarm unit can be accessed in one of two manners:

Option 1: From below

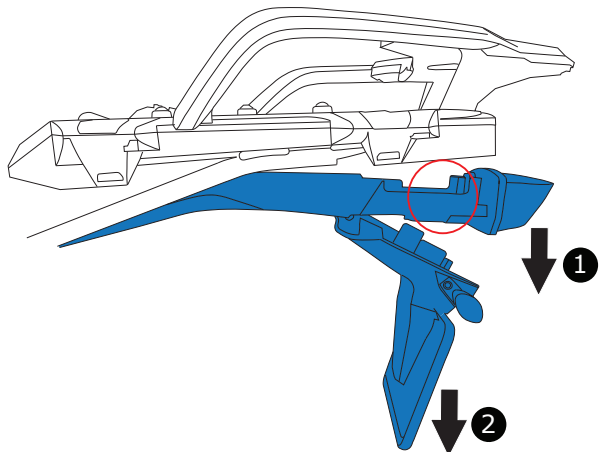

Option 2: From the top

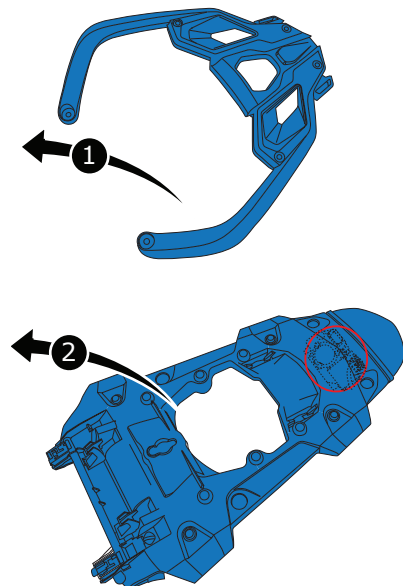

6

OEM
8Nm
6lbf ft
300 mm
118 mm
1x

Option 1

Or
Option 2
2 Nm
1,5 lbf ft
300 mm
118 mm
1x
B4

Cable routing & connecting:
step 7

7

2P + 2X

3
4P + 4X

4
6P + 6X

In reality all cables are black

Avoid Bending near the connector

Sufficient cable length for slack

8

Complete System Check!