



SN. . . . .

# Dr. Jekyll & Mr. Hyde<sup>®</sup>

## THE EXHAUST

MANUAL : HARLEY-DAVIDSON<sup>®</sup> | EASYMOUNT | SMARTBOX 2

### NEW IN THIS MANUAL:

- CATALYTIC CONVERTERS  
(WELDING NECESSARY)
- UPDATED BRACKET/LOCK PLATE
- LINK PIPE POSITIONING



Triglide , Freewheeler  
2019-up

1

# Triglide, Freewheeler 2019-up

## Easymount Smartbox

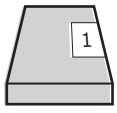
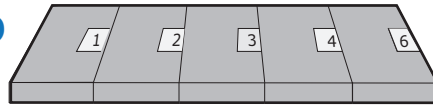

Assembly Kit

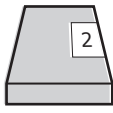
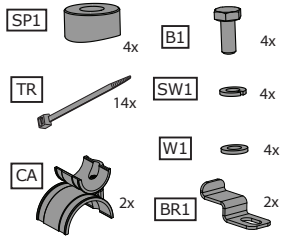

Smartbox 2

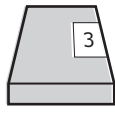
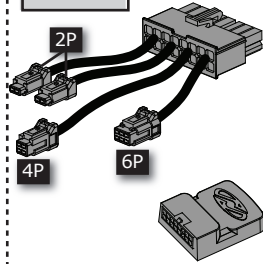

Mode Switch for Smartbox

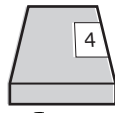
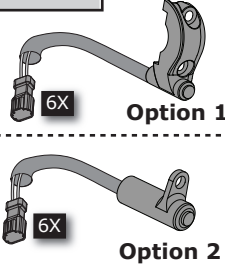

Smartbox Control Cable

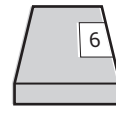
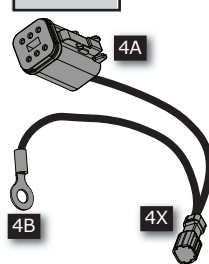

Cats

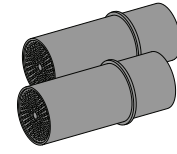

Exhaust/Cable /Servo System

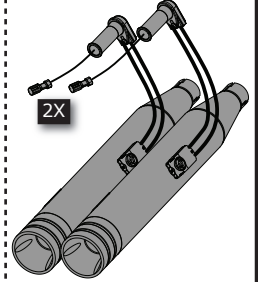

2

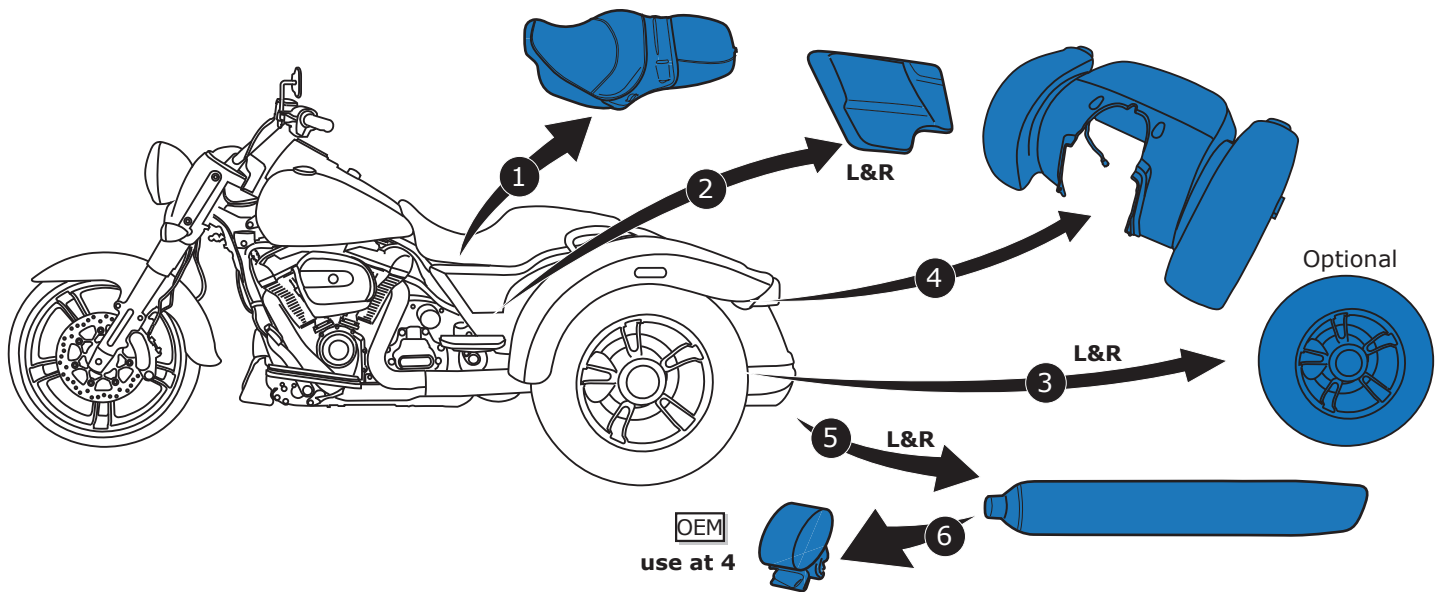

3

Weld catalytic converters to OEM headers  
(if included)

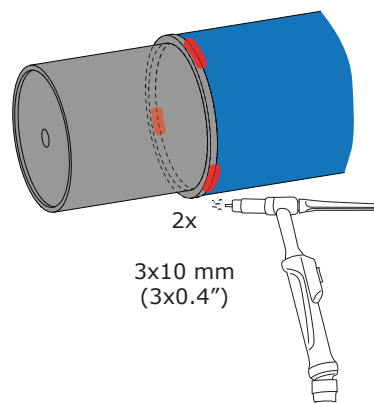
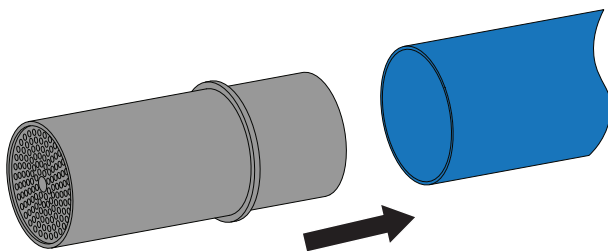
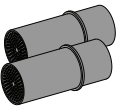







Catalytic converters not welded = no warranty!

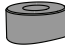

4

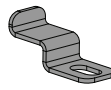

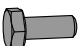
items required

- SP1  4x
- CA  2x
- SW1  4x
- BR1  2x
- TR  14x
- B1  4x
- W1  4x

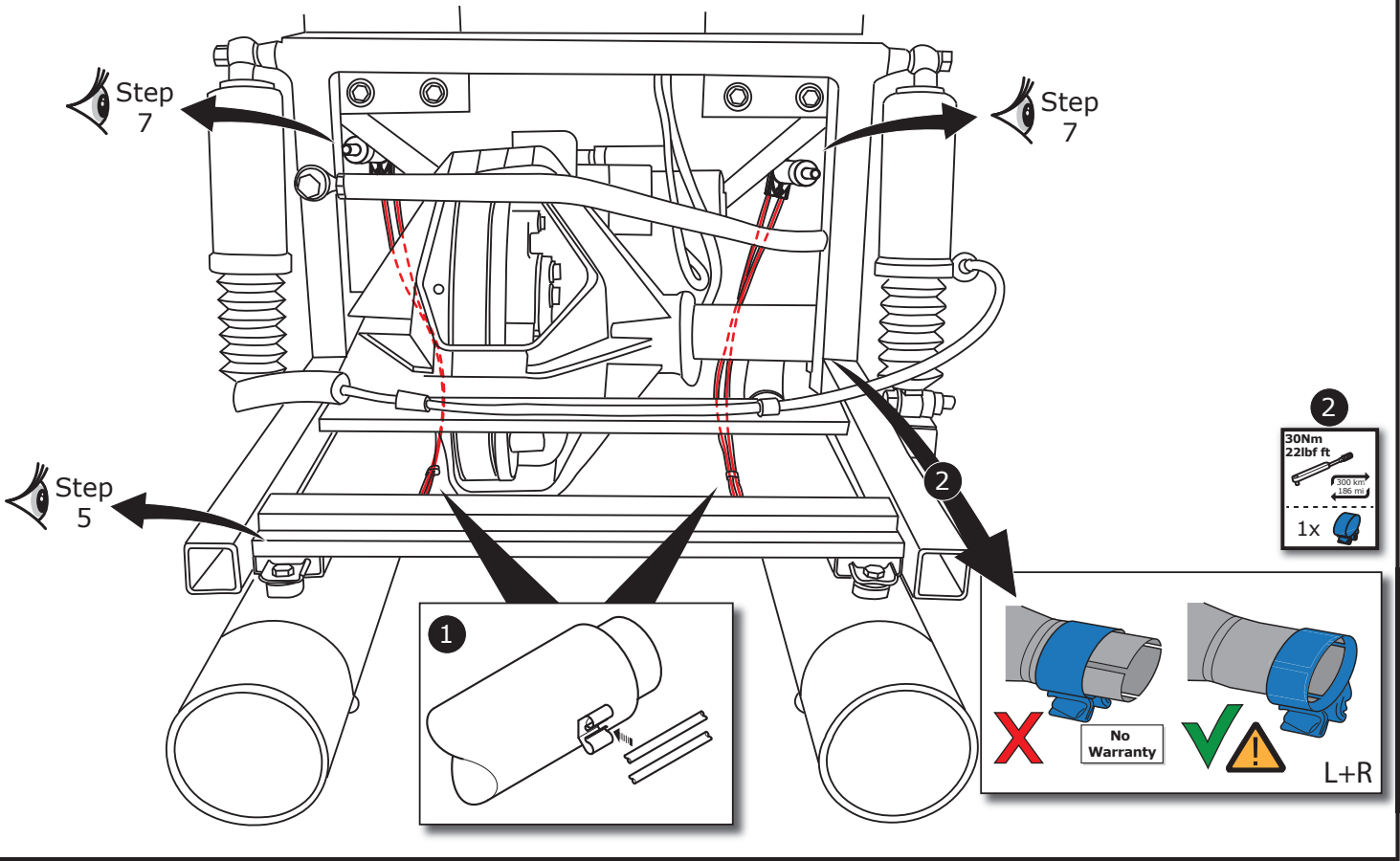

5



L+R

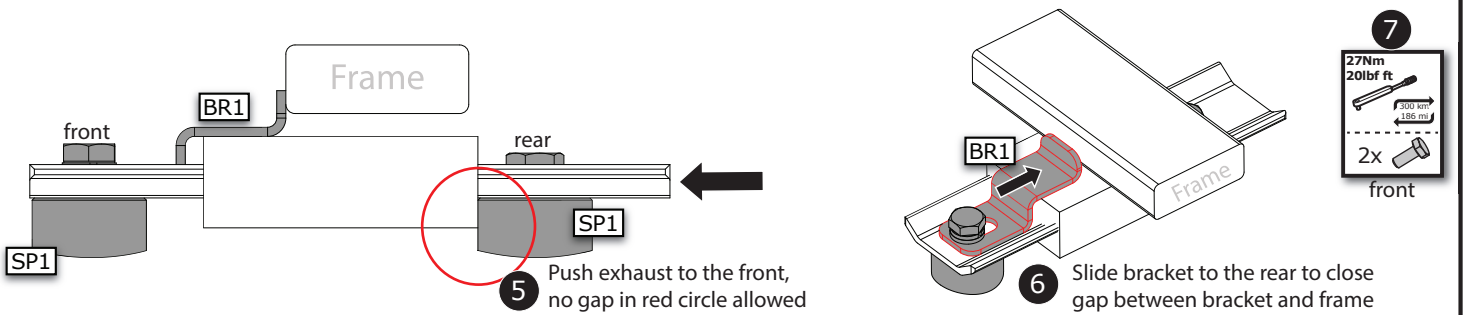
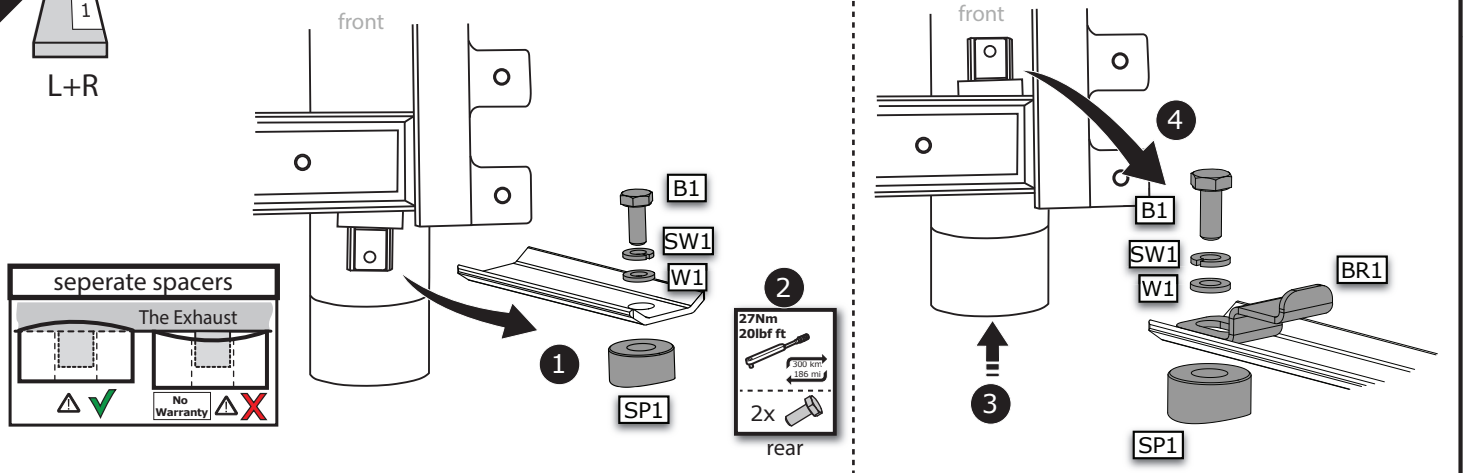

6

### Adjust right hand side OEM link pipe position

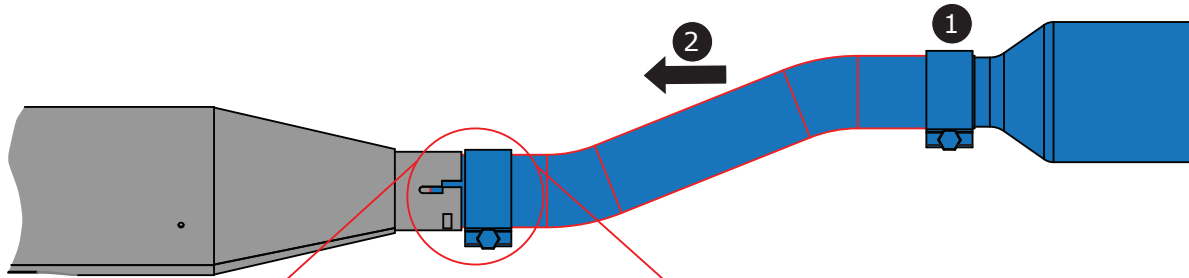

- 1 Loosen OEM exhaust clamp
- 2 Adjust Link pipe position
- 3 Check/adjust gap
- 4 Tighten both OEM exhaust clamps

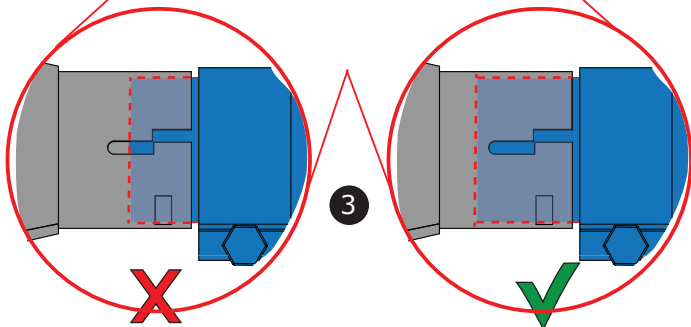

4

30Nm  
22lbf ft

300 km/h  
186 mph

2x

7

### Servo position right

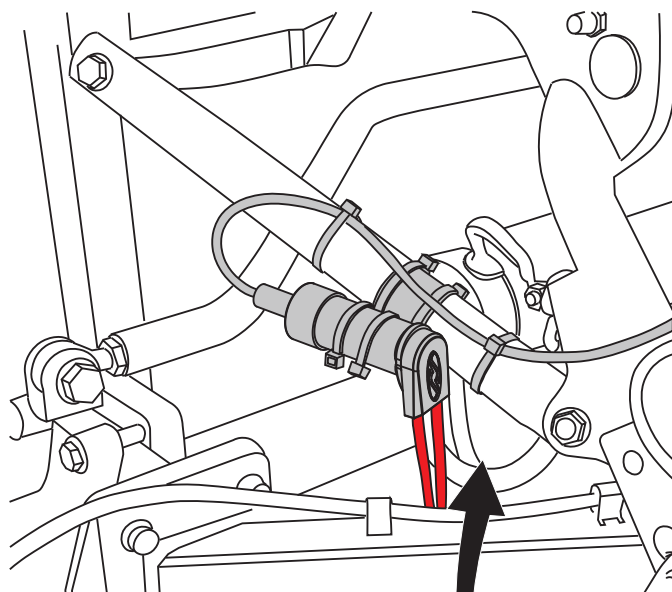

### Servo position left

