



SN.

Dr. Jekyll & Mr. Hyde[®]

THE EXHAUST

MANUAL : HARLEY-DAVIDSON[®] | EASYMOUNT | SMARTBOX 2

NEW IN THIS MANUAL:
- INTEGRATED CATALYTIC CONVERTER



Triglide , Freewheeler
2019-up

1

Triglide, Freewheeler 2019-up

Easymount Smartbox

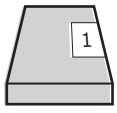
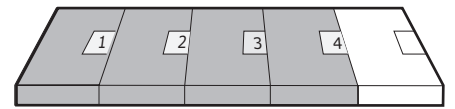

Assembly Kit

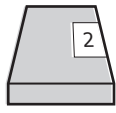
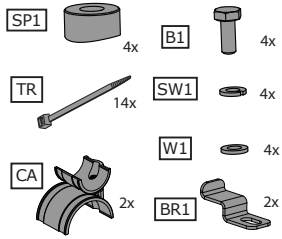

Smartbox 2

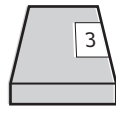
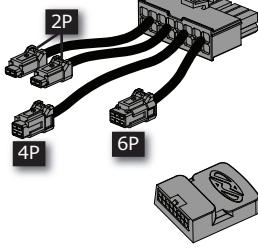

Mode Switch for Smartbox

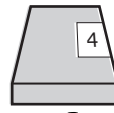
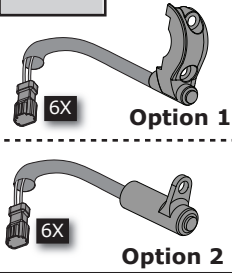

Smartbox Control Cable

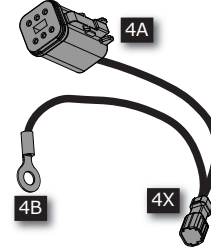

Exhaust/Cable /Servo System

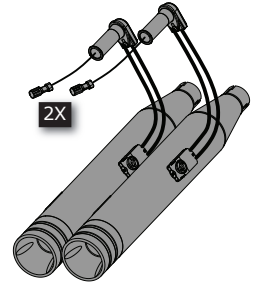



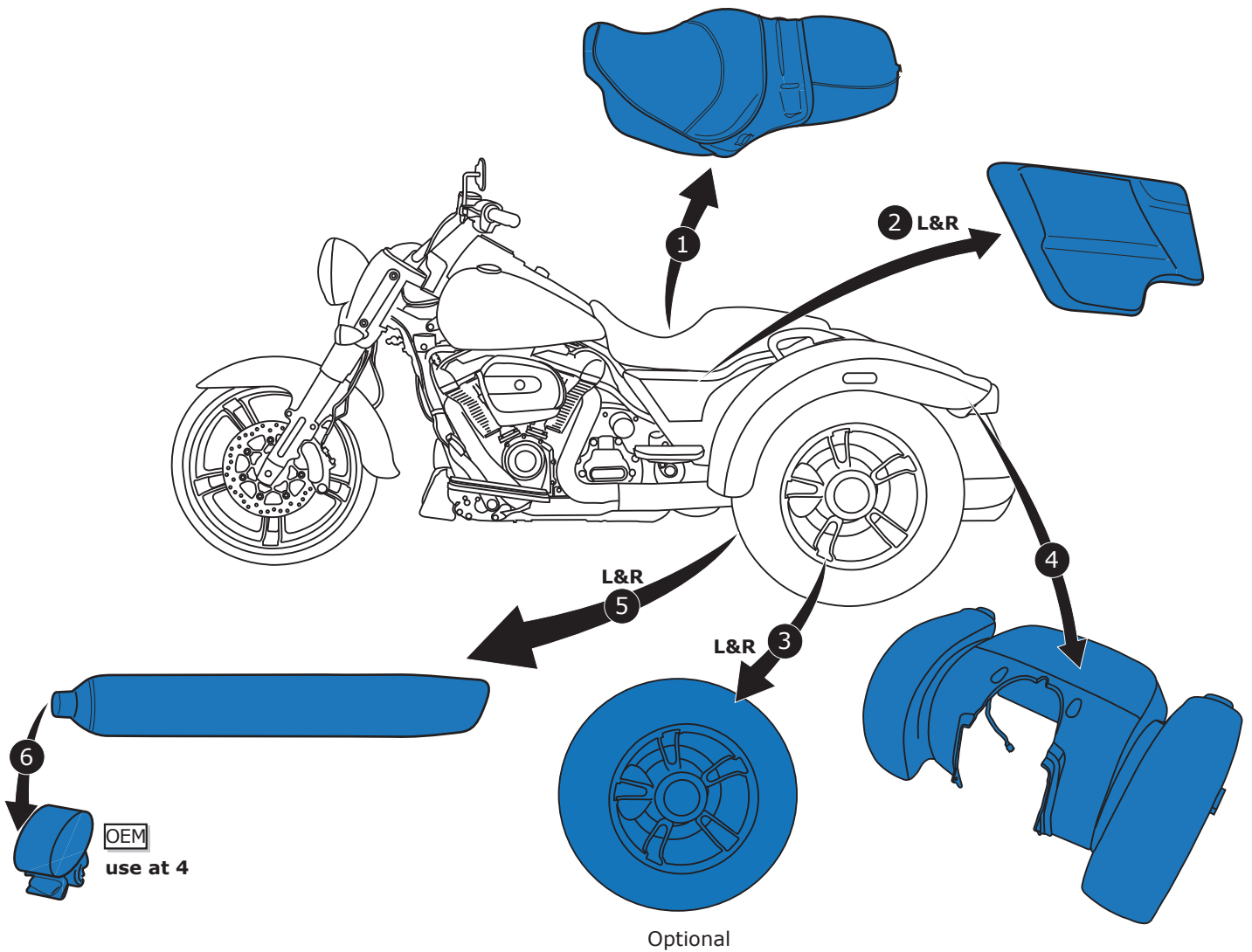



2



4

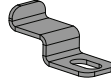

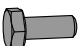
items required

- SP1  4x
- CA  2x
- SW1  4x
- BR1  2x
- TR  14x
- B1  4x
- W1  4x

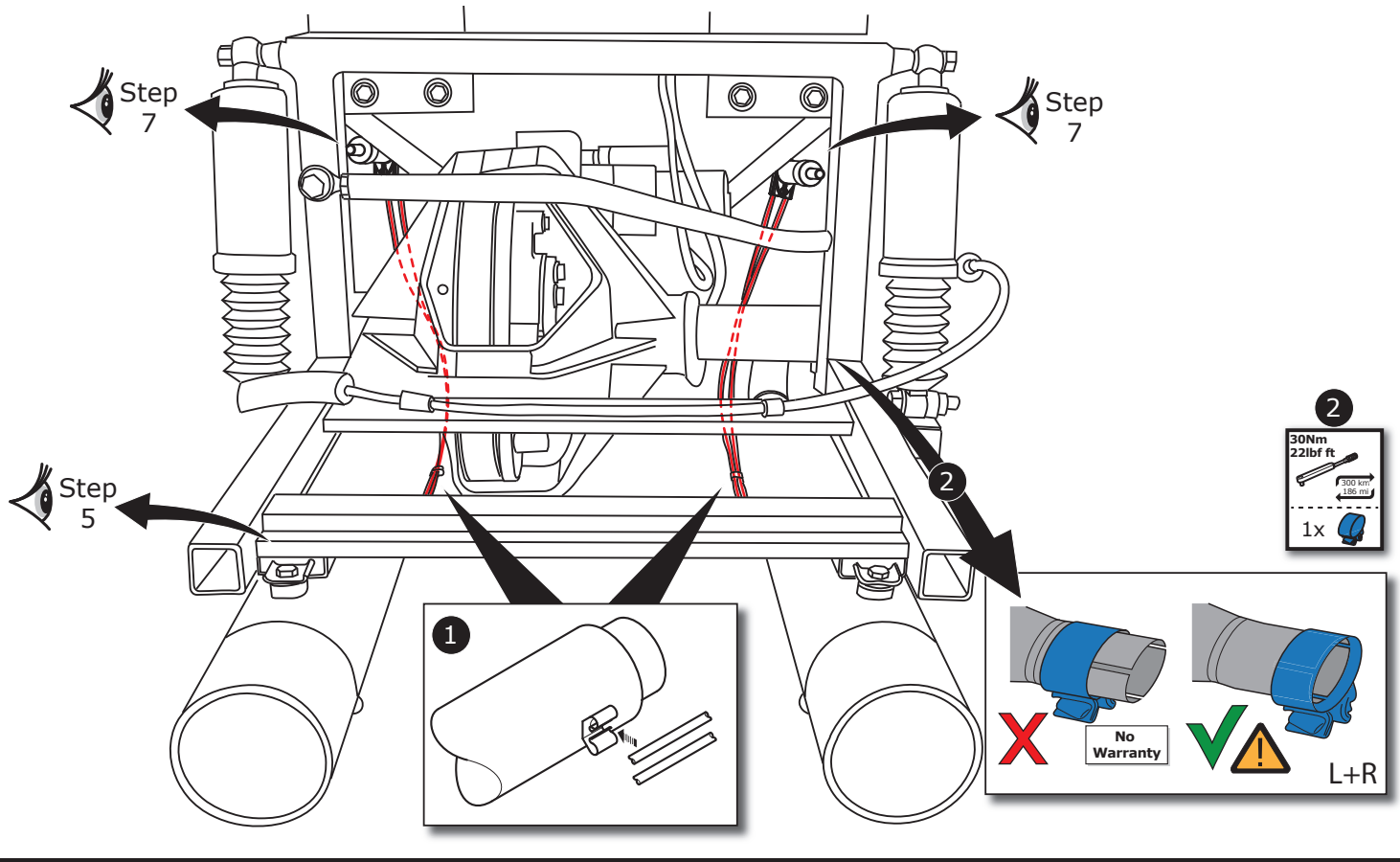

5



L+R

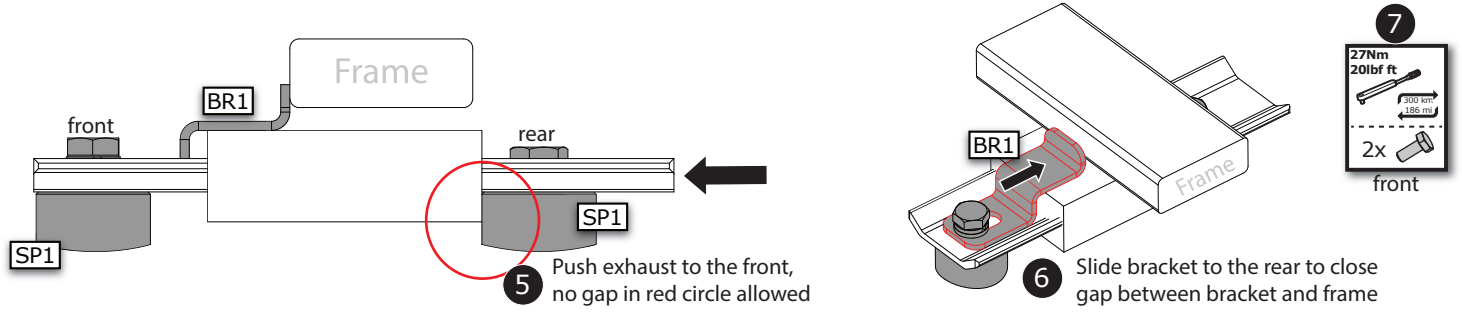
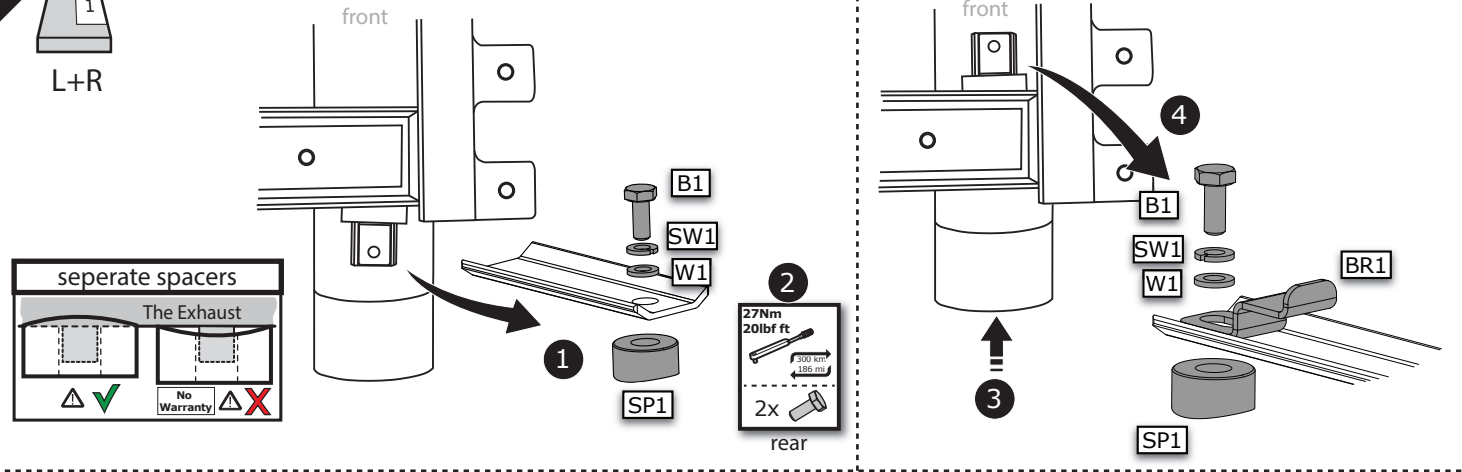

6

Adjust right hand side OEM link pipe position

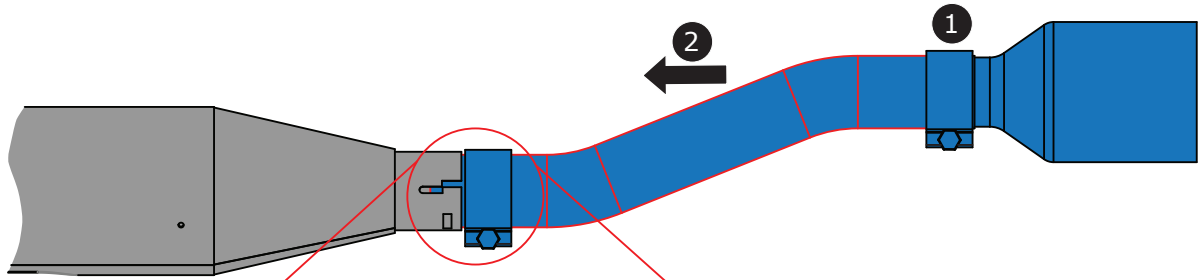

- 1 Loosen OEM exhaust clamp
- 2 Adjust Link pipe position
- 3 Check/adjust gap
- 4 Tighten both OEM exhaust clamps

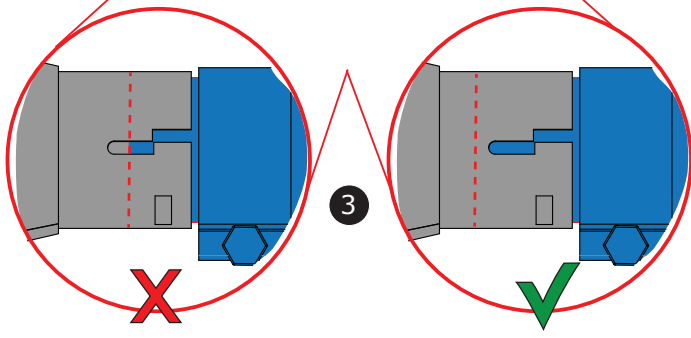

4

30Nm
22lbf ft

300 km/h
186 mi/h

2x

7

Servo position right

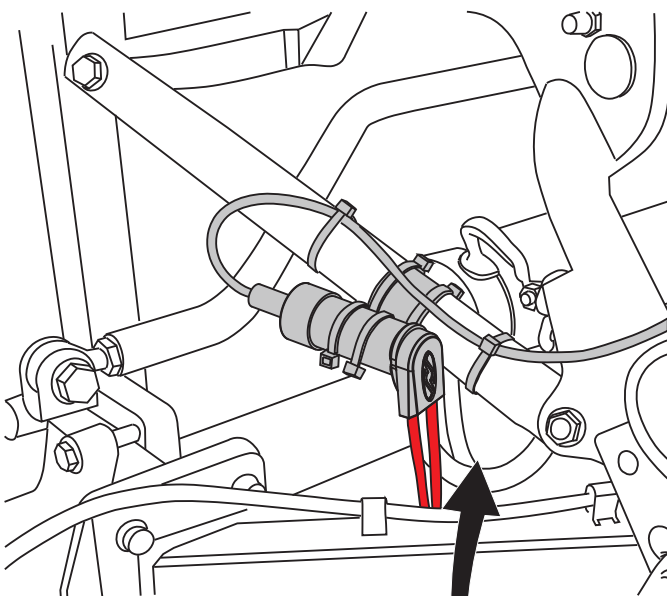

Servo position left

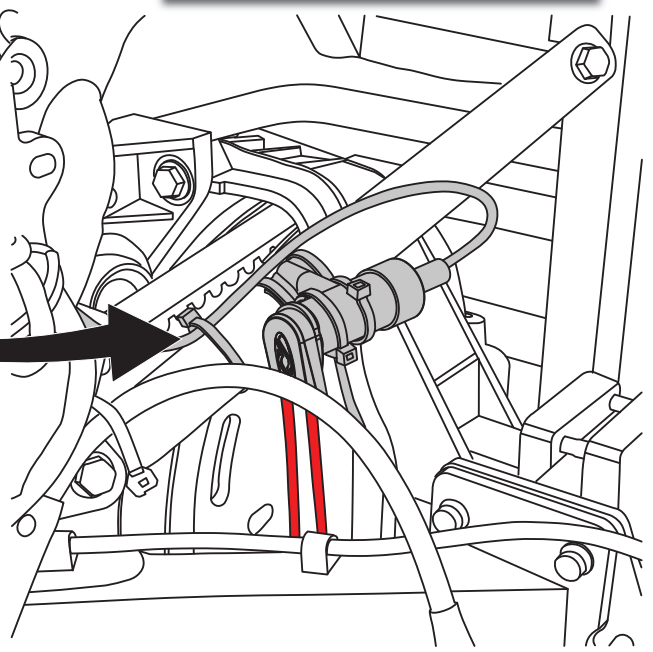
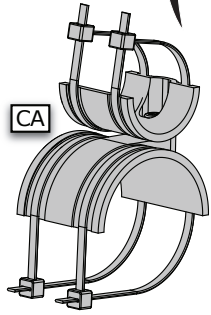

8

2P + 2X

6P + 6X

Or

8Nm
6lbf ft

1x

Avoid Bending near the connector

Sufficient cable length for slack

9

4P + 4X

4A + OEM

Avoid Bending near the connector

Sufficient cable length for slack

10

Complete System Check!

L&R

L&R