



SN. . . . .

# Dr. Jekyll & Mr. Hyde<sup>®</sup>

## THE EXHAUST

MANUAL : BMW<sup>®</sup> | EASYMOUNT | SMARTBOX 2

**NEW IN THIS MANUAL:**  
**- 2019 MODEL**



R 1250 GS Adventure

2019 » Up

1

# R 1250 GS Adventure Easymount Smartbox 2

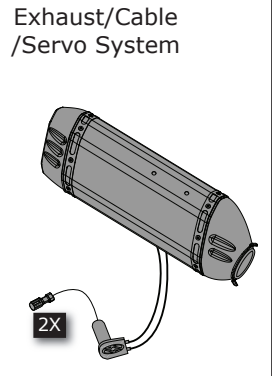
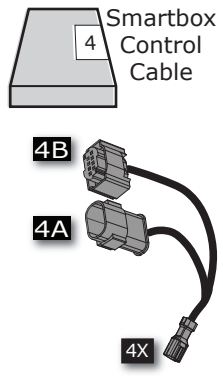
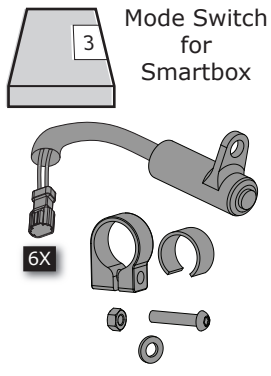
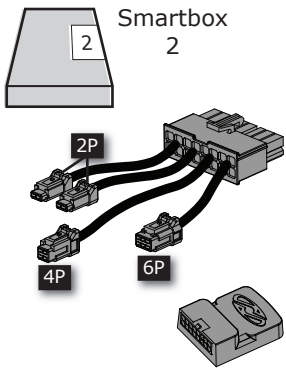
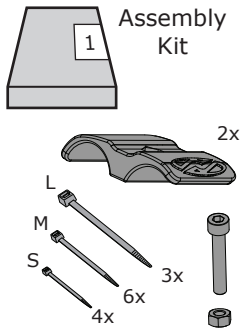
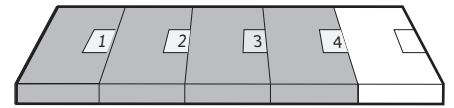

2

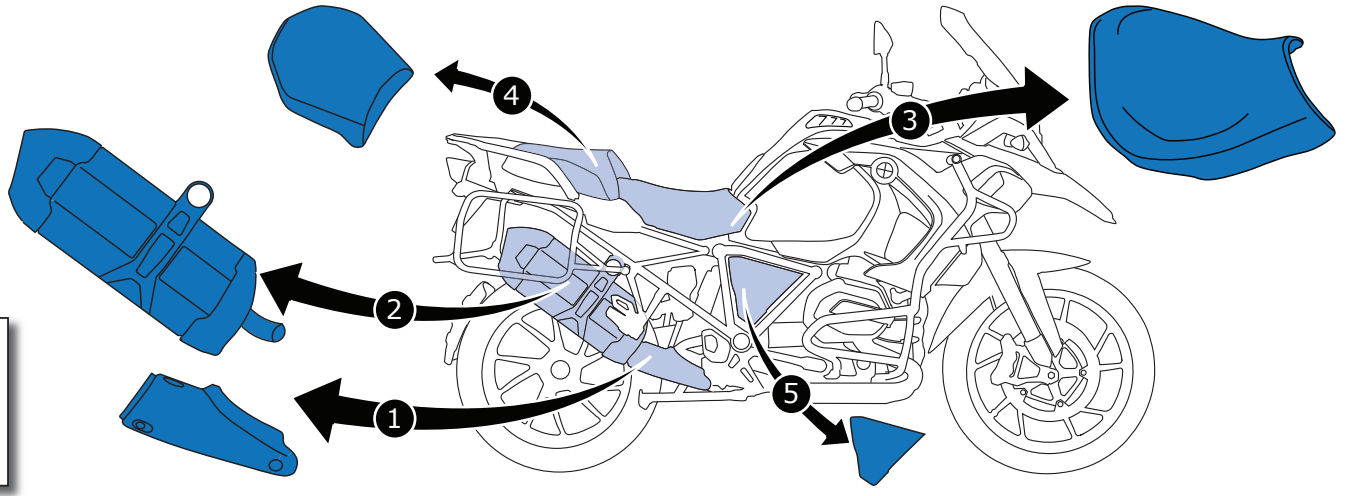

3

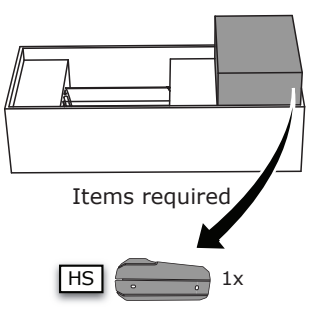

To mount the exhaust use the mountingset + manual

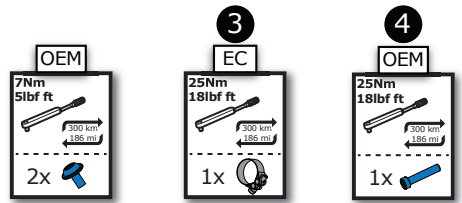
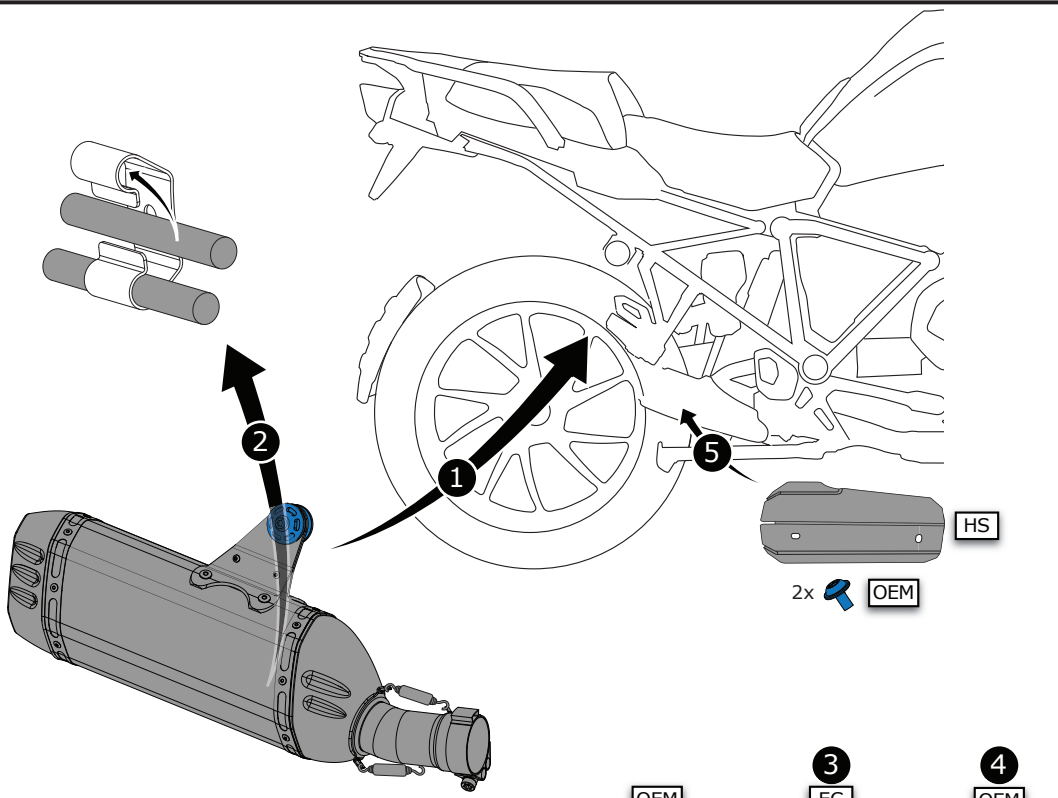
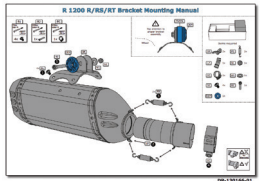

4

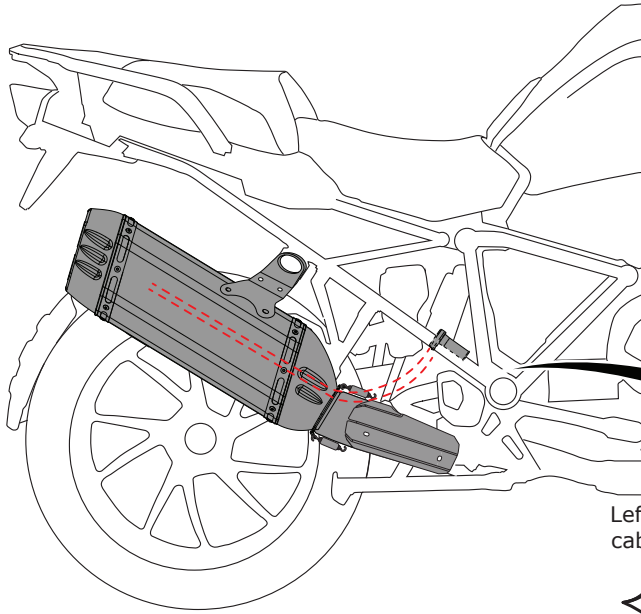
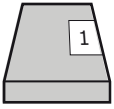

Left hand side cable routing:

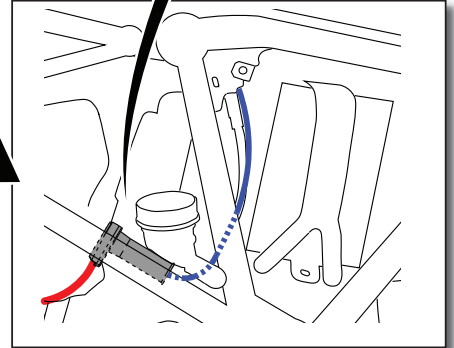
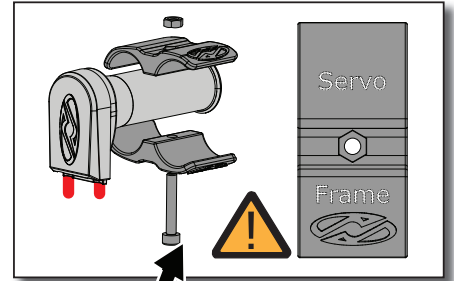

5

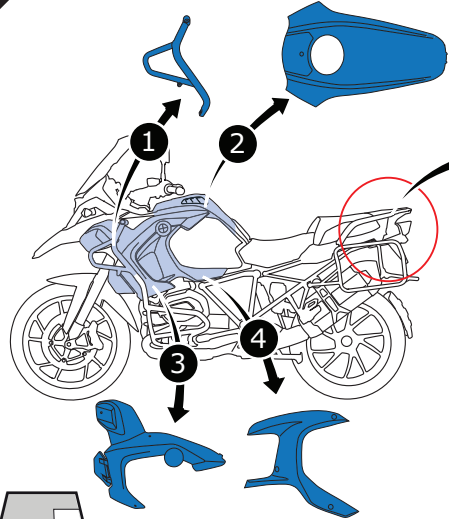

Current situation

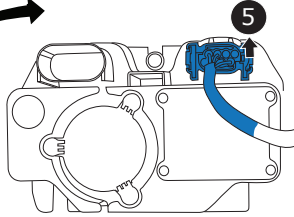

Connect control cable

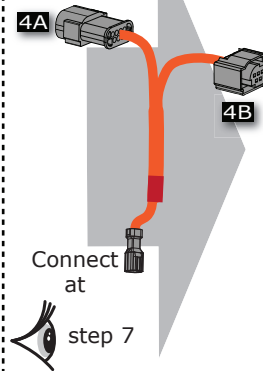

New situation

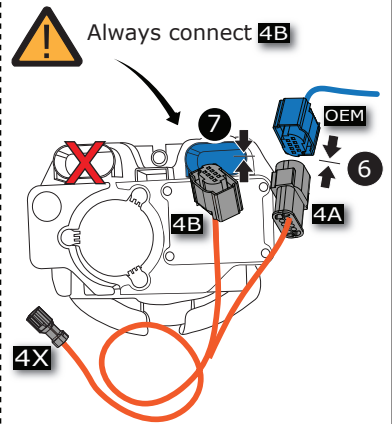

The alarm unit can be accessed in one of two manners:

Option 1: From below

3x

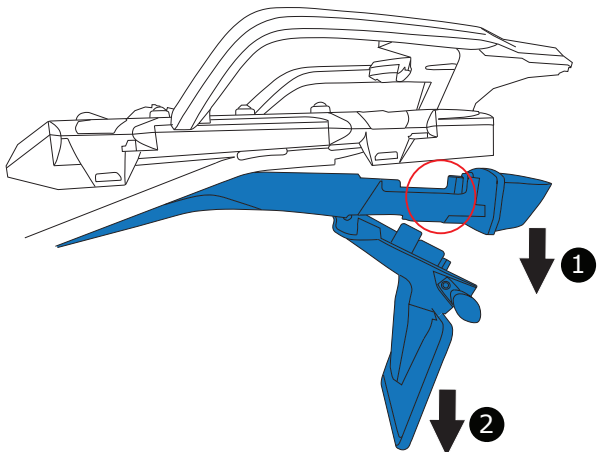

Option 2: From the top

8x

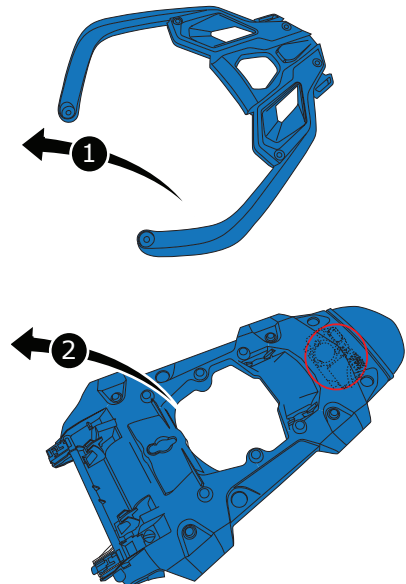

**6**

Or

**3**

Left hand side

Right hand side

2 Nm  
1,5 lbf ft

1x

B4

OEM

8Nm  
6lbf ft

1x

**7**

**2**

In reality all cables are black

1

2P + 2X

3

4P + 4X

4

6P + 6X

Avoid Bending near the connector

Sufficient cable length for slack

**8**

**2**

1

2

Complete System Check!

3

4

5

6

7

R