



SN. . . . .

# Dr. Jekyll & Mr. Hyde®

## THE EXHAUST

MANUAL : TRIUMPH® | EASYMOUNT | SMARTBOX 2

**NEW IN THIS MANUAL:  
- FIRST EDITION**



Triumph Bobber  
Triumph Speedmaster  
2017 » Up

Instruction  
video



# 1 Triumph Bobber/Speedmaster Easymount Smartbox 2

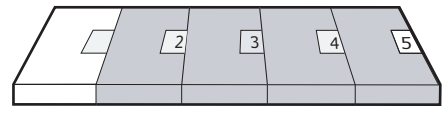

brackets / linkpipes / clamps and mounting parts.

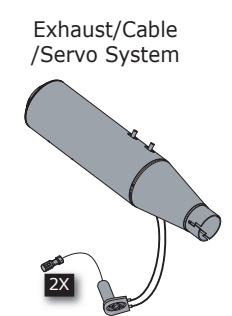
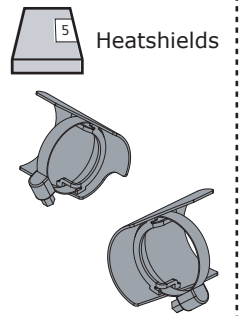
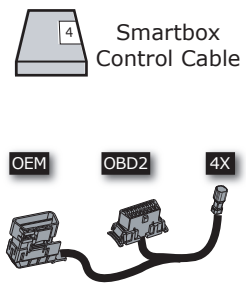
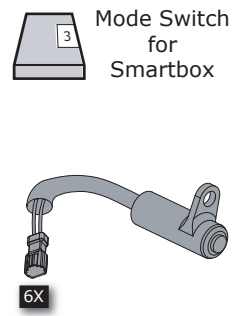
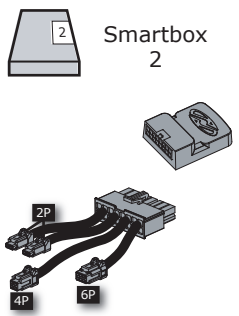

The instruction video for this model is available online, scan QR code on front page.

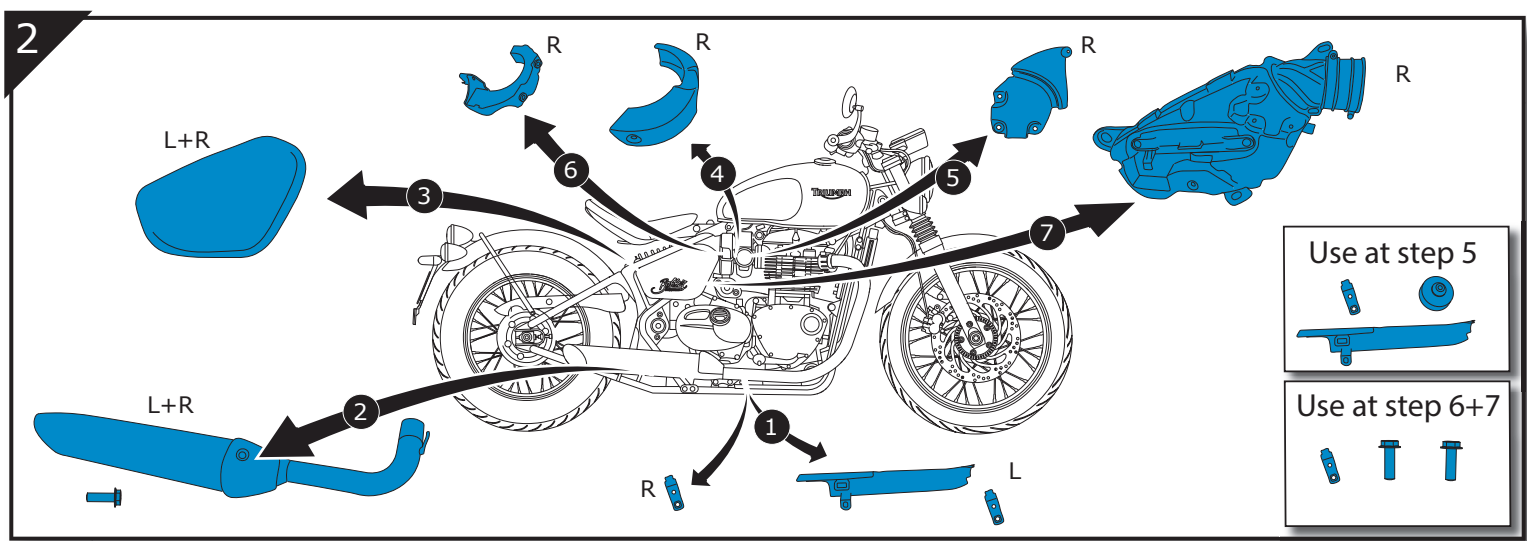

- ## 3
- Items required
- 1x BR1207
  - 1x BR1205 ⚠ LEFT
  - 4x M8x16 B0
  - 4x W1
  - 4x SP
  - 2x EC

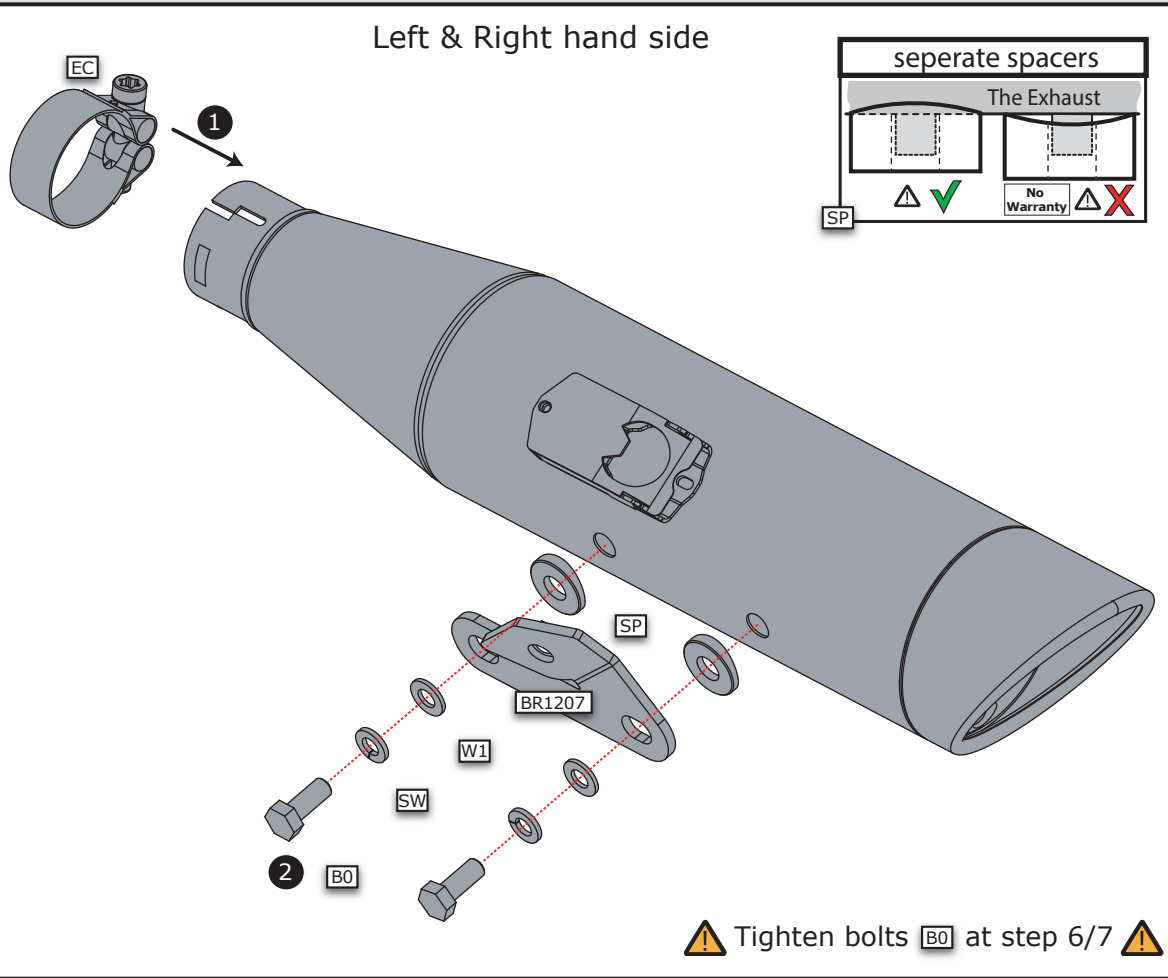

4

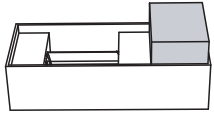

Items required

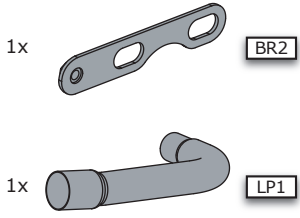

Right hand side

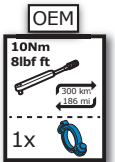
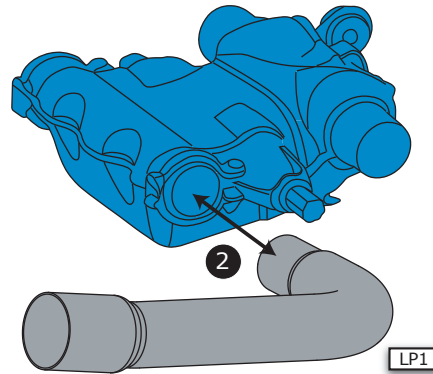
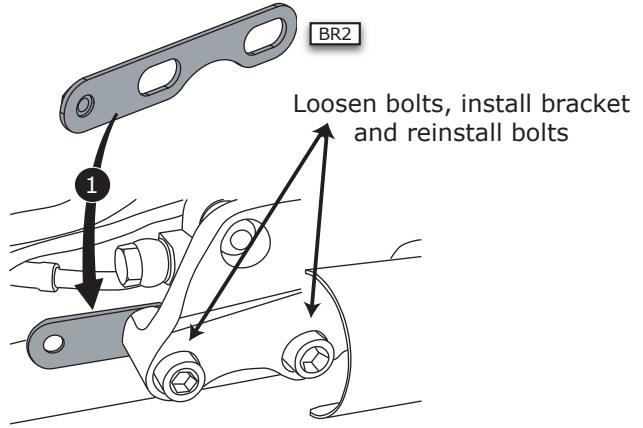

5

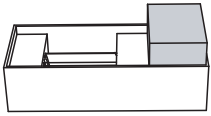

Items required

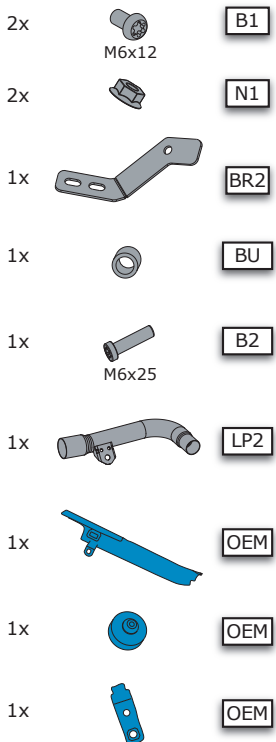

Left hand side

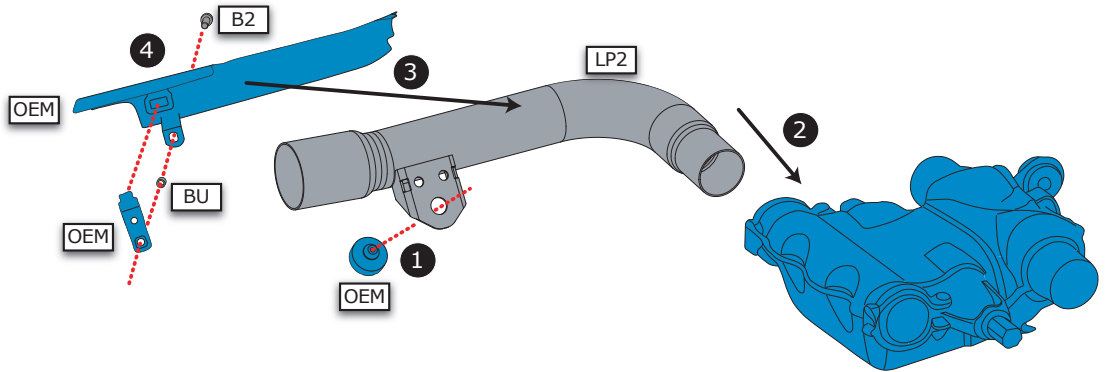

⚠ B2 & BU Don't reuse OEM parts

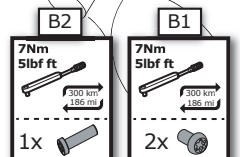
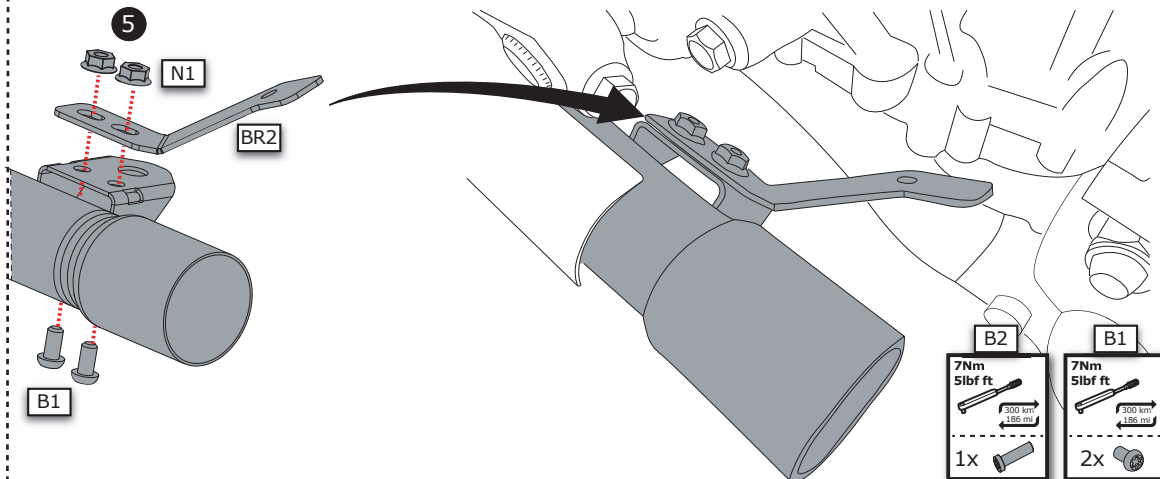

6

### Right hand side

Items required

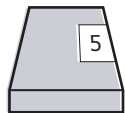

1x



OEM

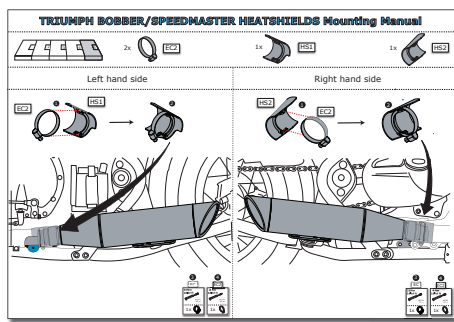
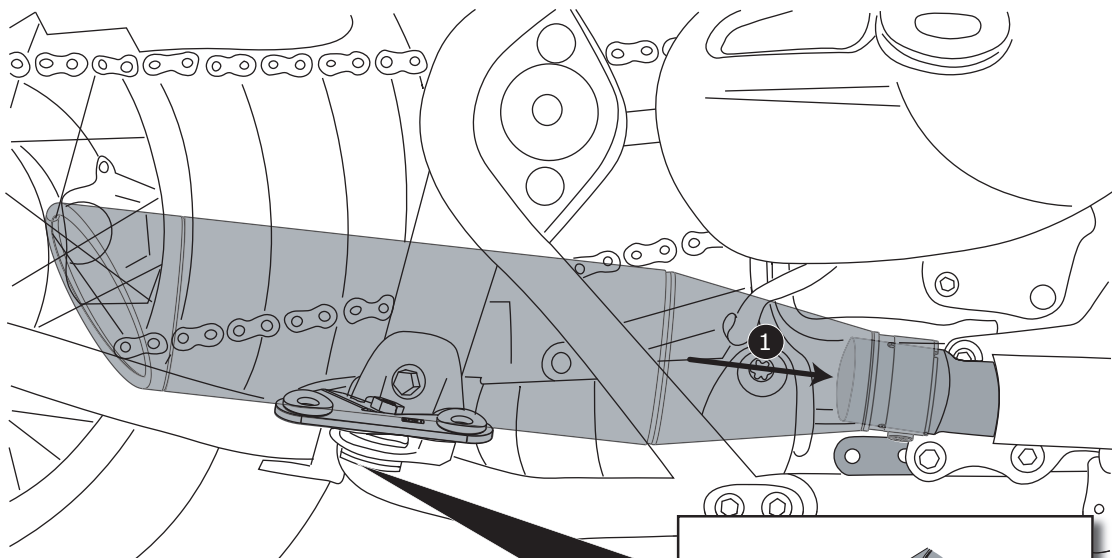

5

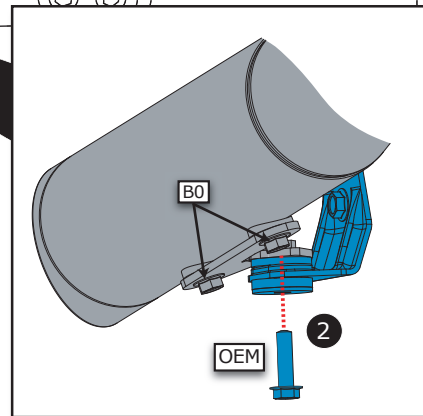

7

### Left hand side

Items required

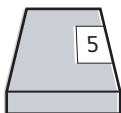

1x



OEM

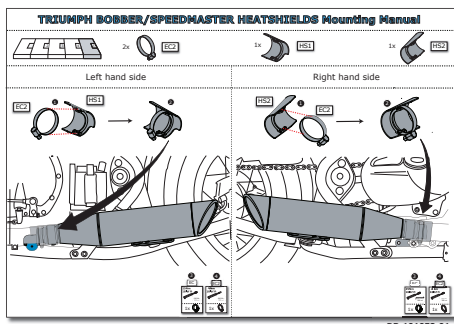
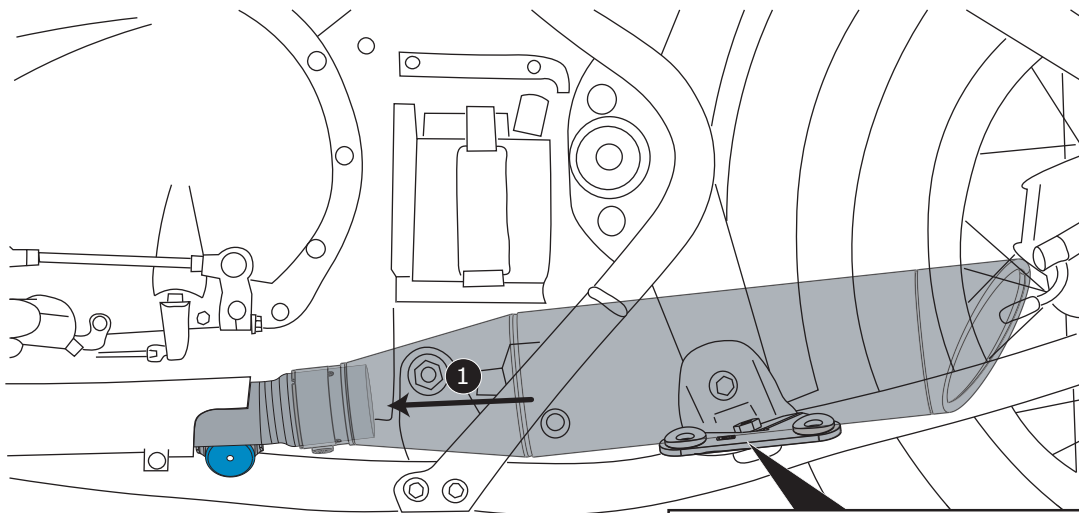

5

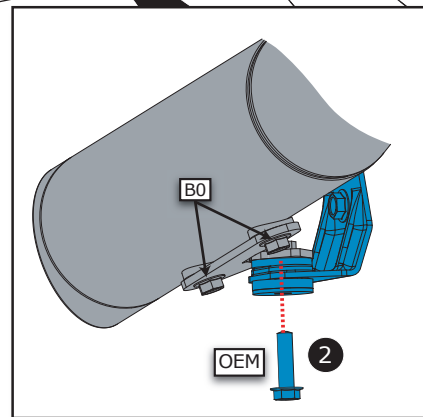

8

### Right hand side

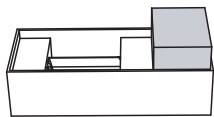

- 1x M6x16 B3
- 1x PC1
- 1x W2
- 1x M



**2X** is guided to the left side of the motorcycle. See step 9



See Instruction video.

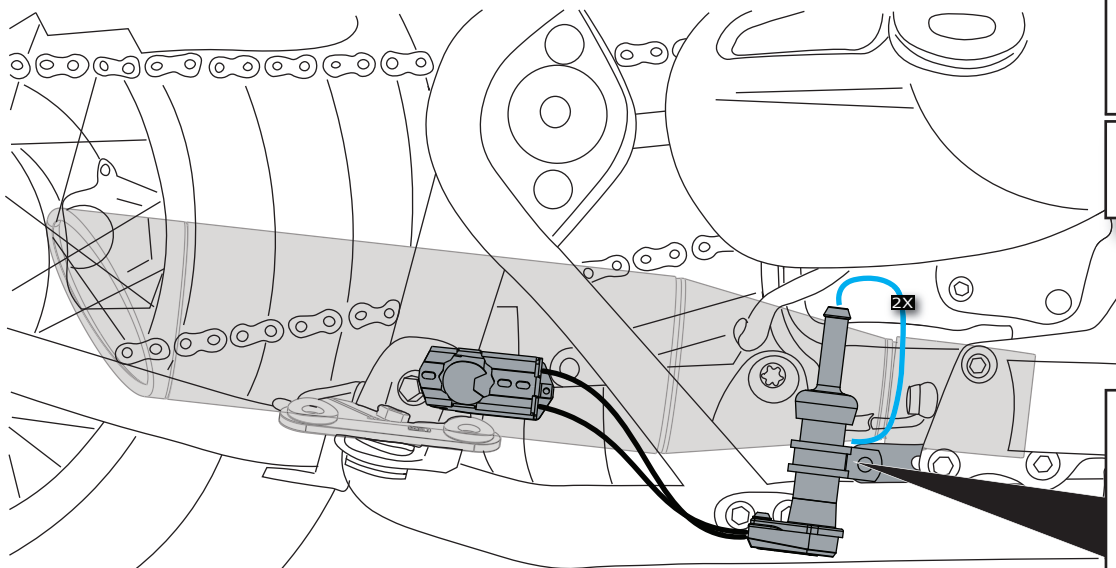

Fix cables with cable ties to **OEM** wire harness.



Do not place servo lower than the frame.

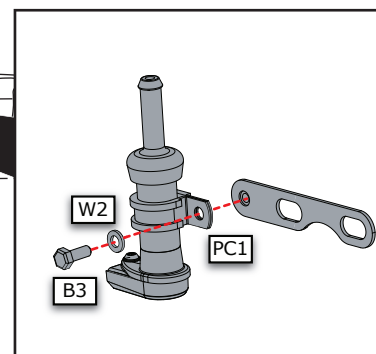
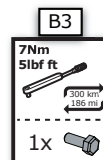

9

### Left hand side

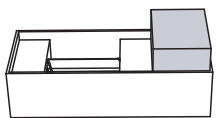

- 1x M6x16 B3
- 1x PC1
- 2x M
- 1x N2
- 1x W2



Guide cables **2X** to the location indicated at step 11. When connected, store away excess cable **above the battery**.



See Instruction video.

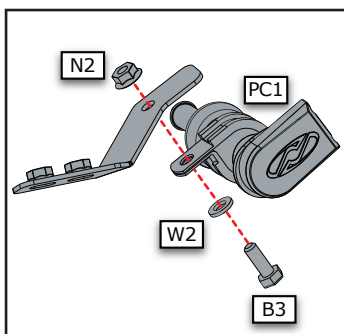
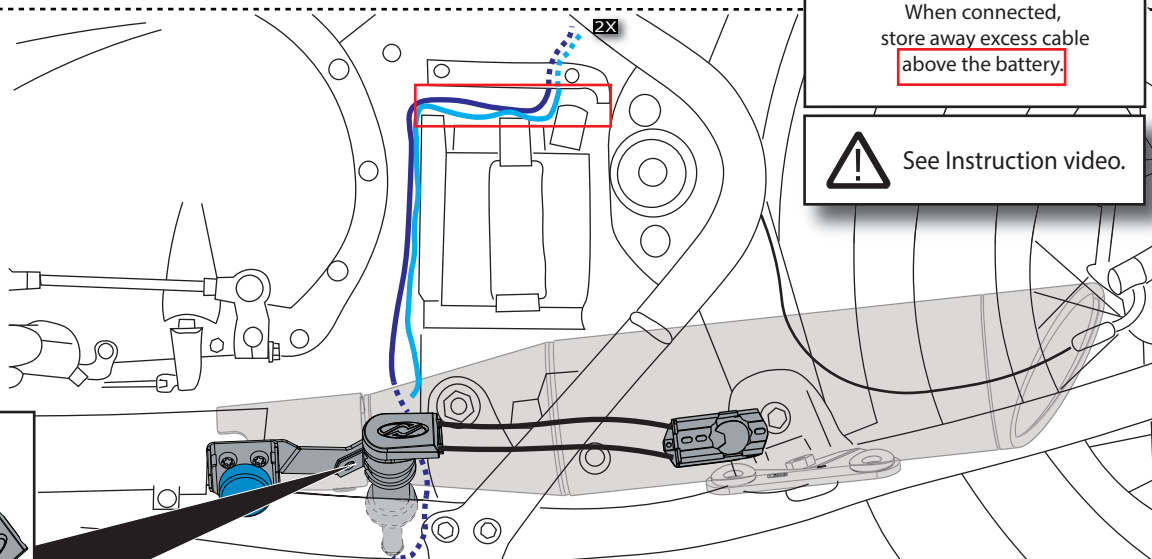

Do not place servo lower than the frame.

Fix cables with cable ties above **OEM** battery.

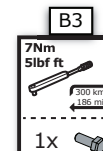

10

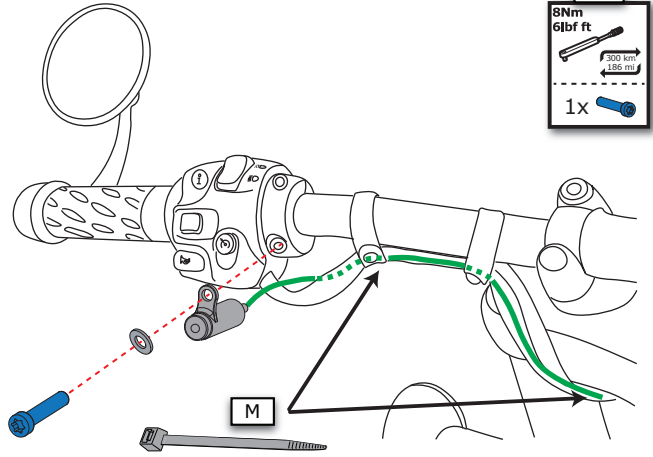
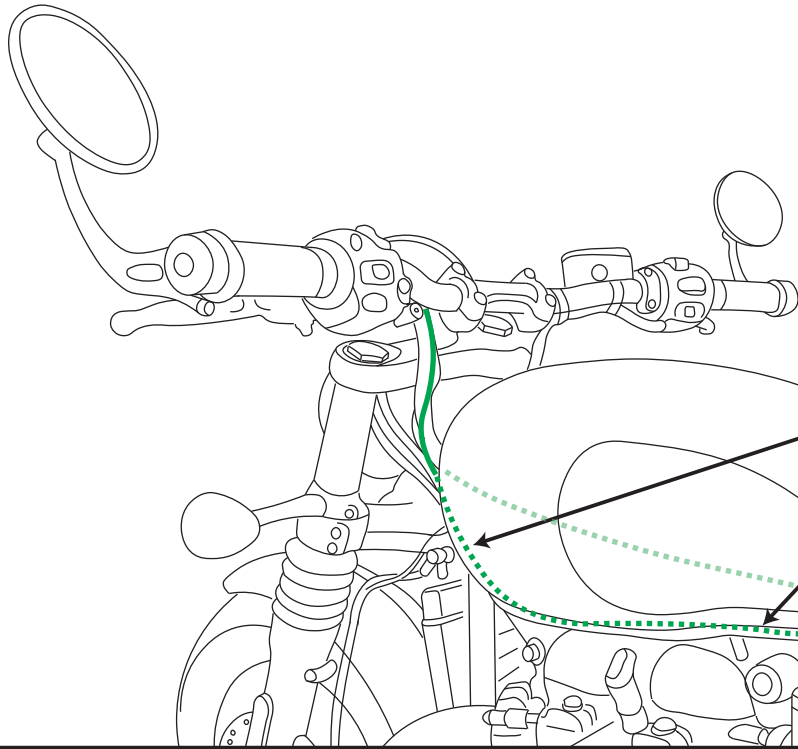

OEM

8Nm  
6lbf ft

300 mm  
11.8 in

1x

**!**

Alternative Cable Routing:  
Lift Tank and follow OEM harness

11

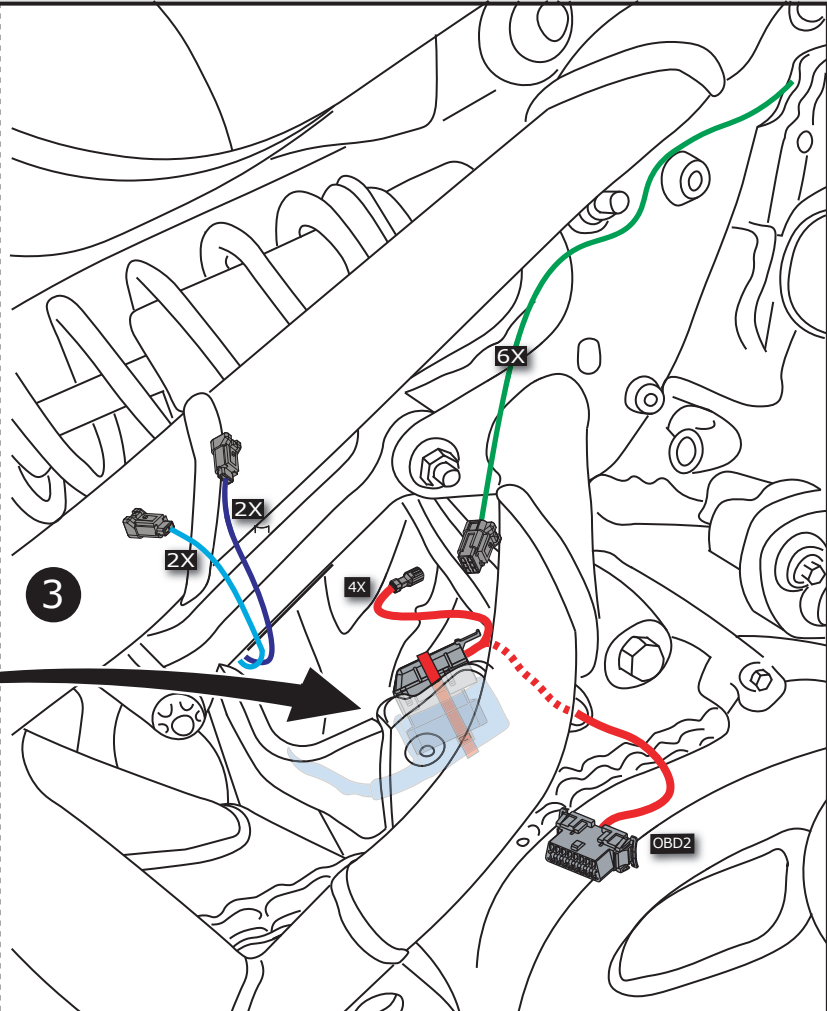
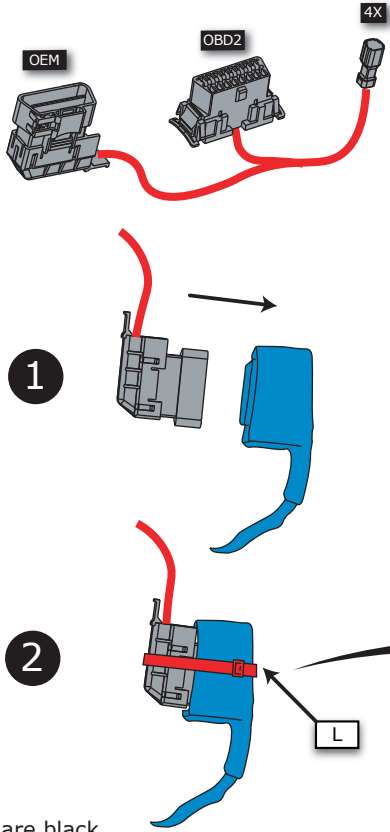
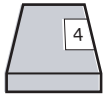

In reality all cables are black

**X** Avoid Bending near the connector

**✓** Sufficient cable length for slack

12

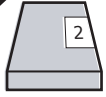

1

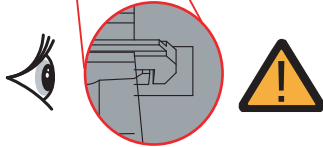
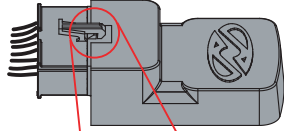
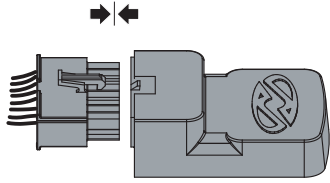

2

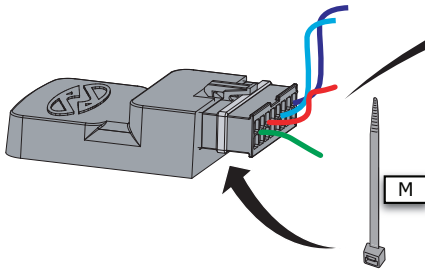

3

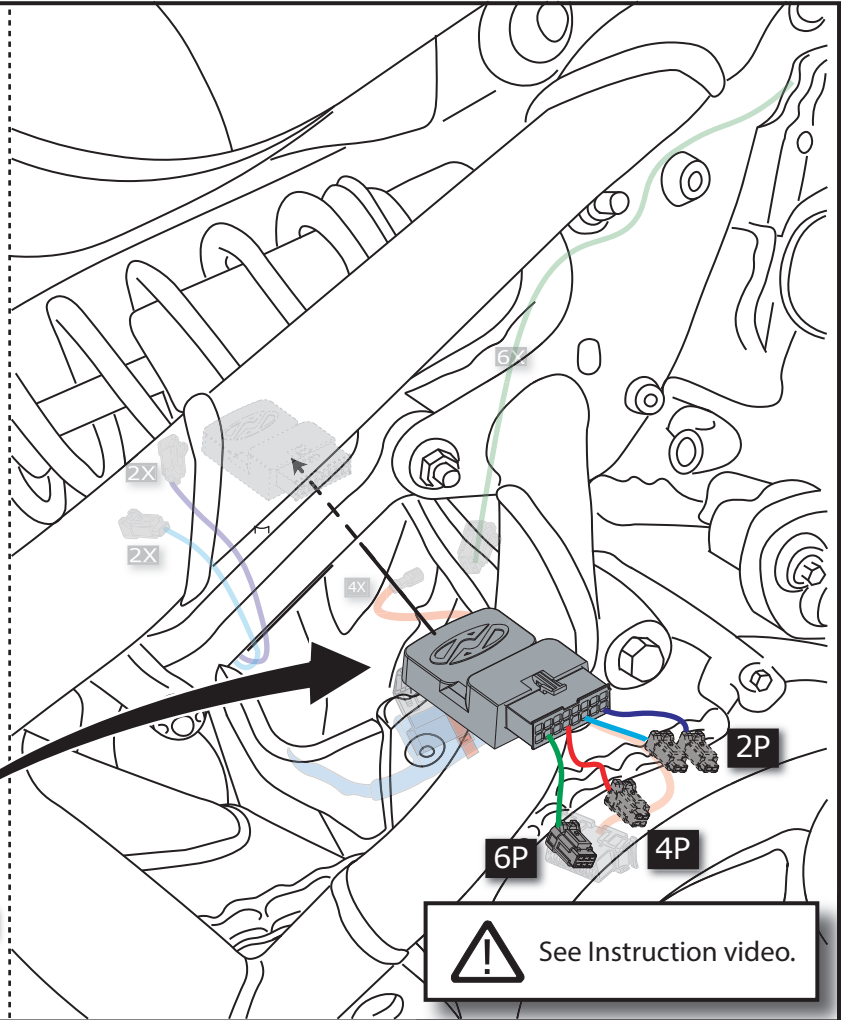

See Instruction video.

13

Connect the following cables with each other.



1

2P + 2X

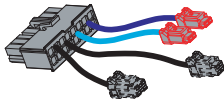

2

4P + 4X

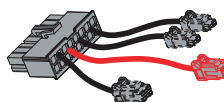

3

6P + 6X

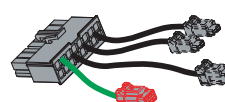

4

Complete System Check!

See complete system check manual on last 4 pages.

5



Use cable ties to organize and hide the cables in the remaining space.

6

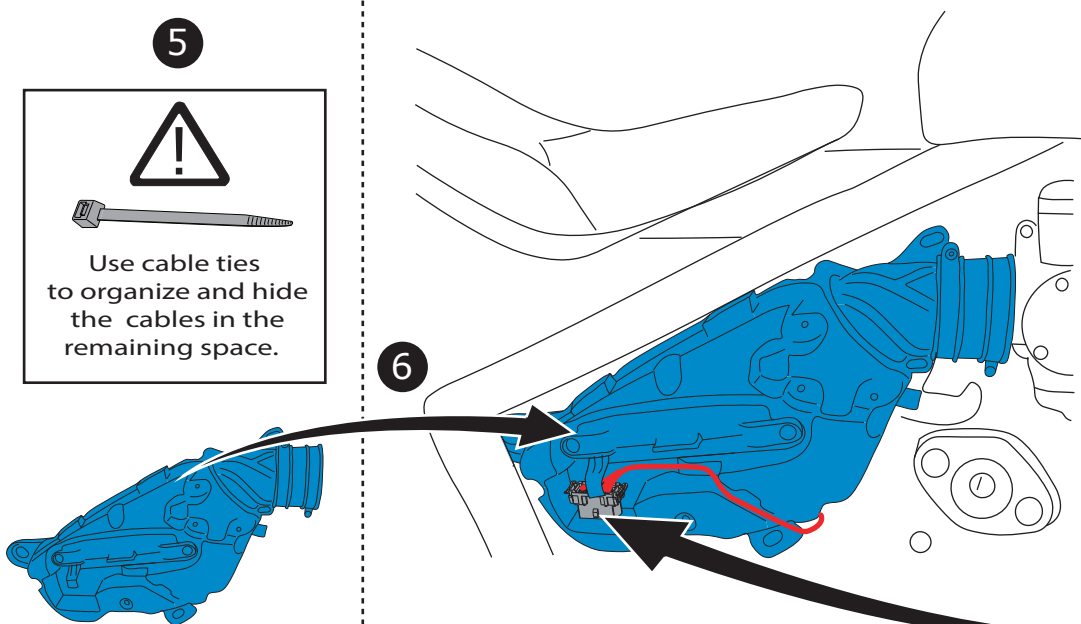

Add Vaseline to the connector on both sides

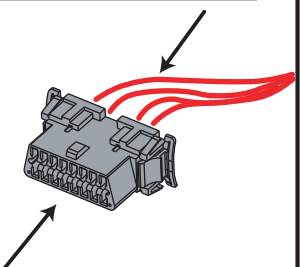
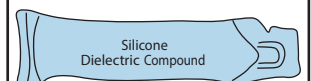

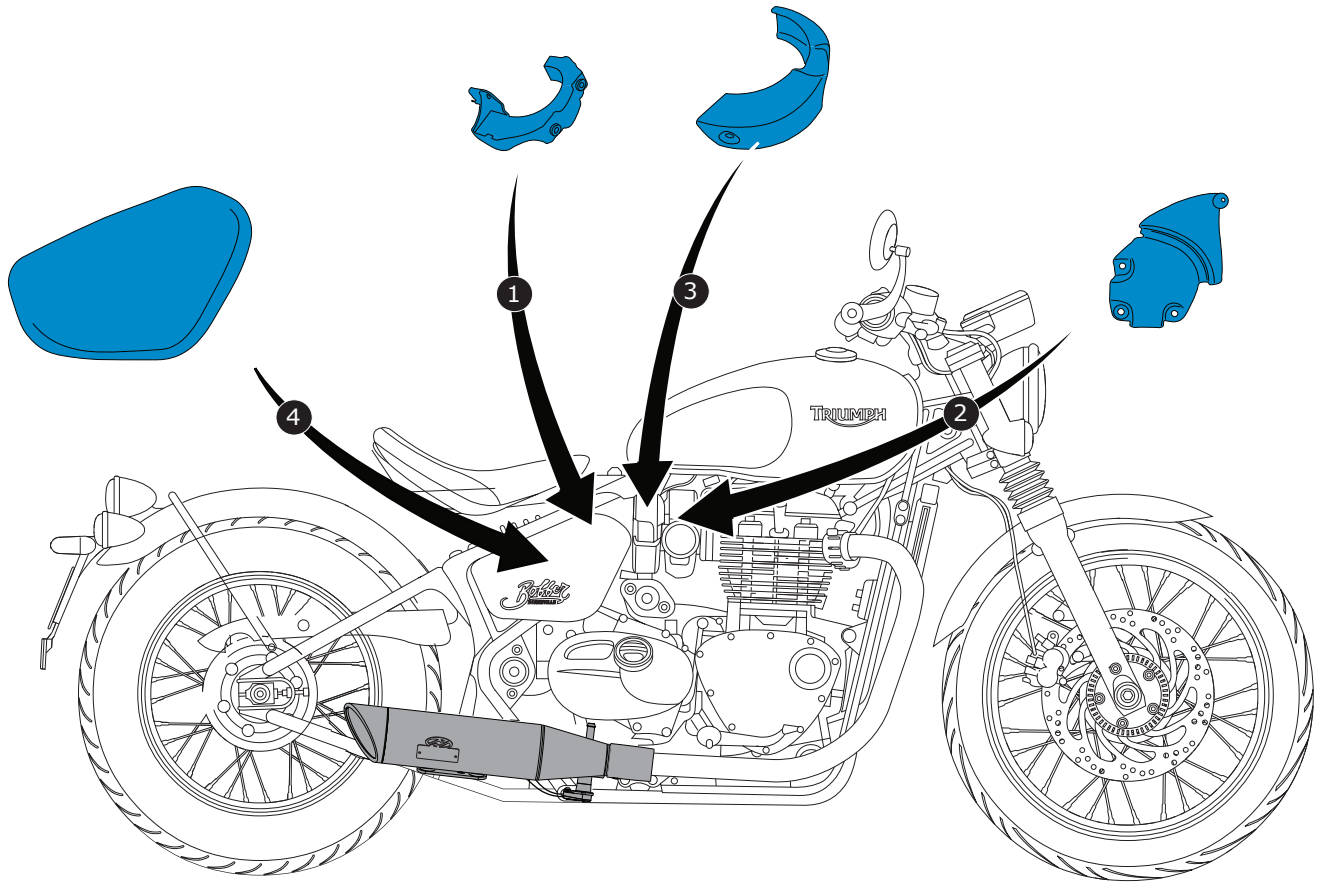



# Complete System check + Troubleshooter

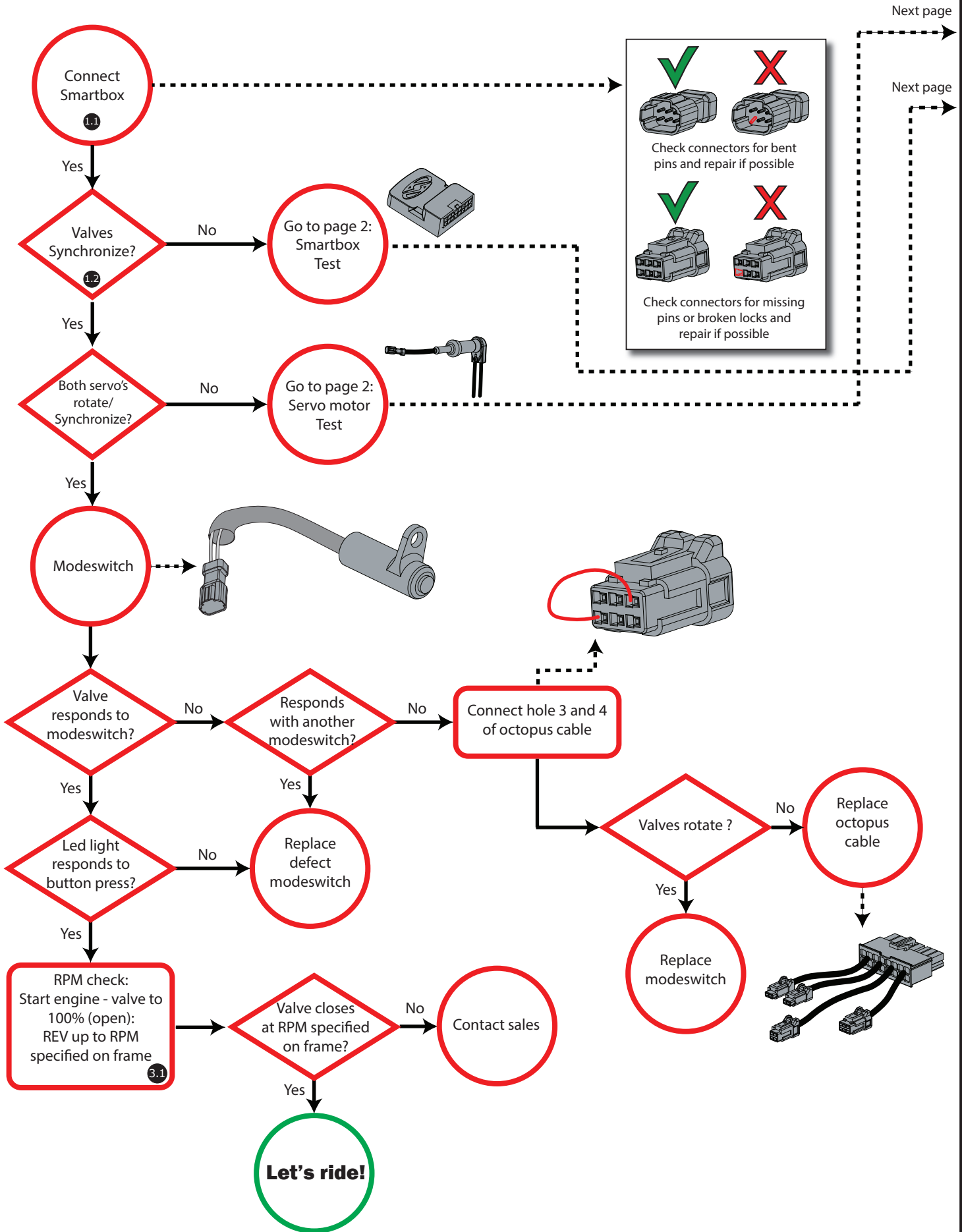

# Complete System check + Troubleshooter

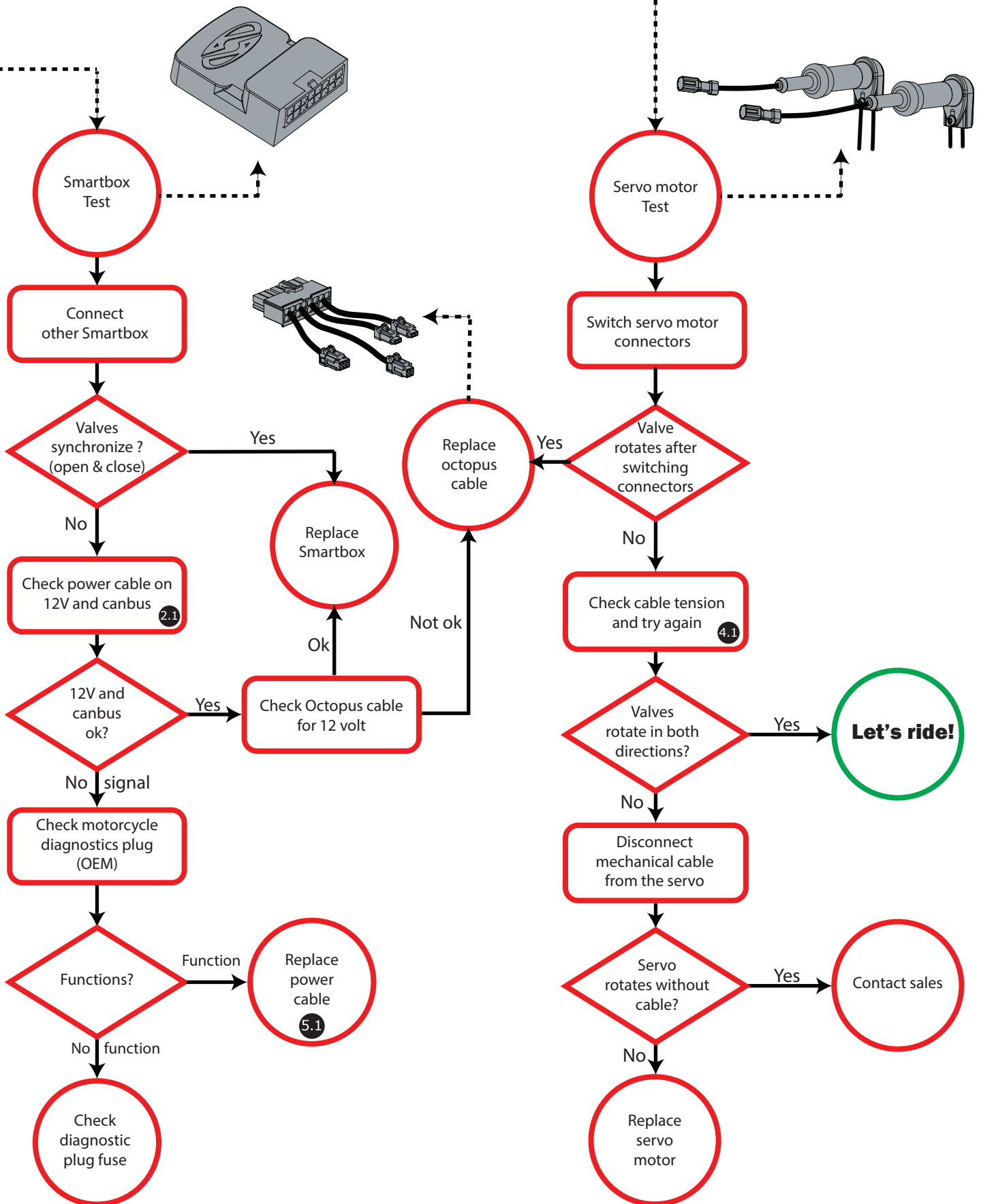

## INSTRUCTIONS

- 1.1 What happens when initializing and when does the system initialize?

The initialization is at any time the Smartbox is supplied with power again. This could be when it is plugged in or the motor is put on contact.

- 1.2 What do we mean by initializing motors?

Initializing is determining the time when the valve opens and closes, in order to maintain a legal system. The system checks what the valve range is. To determine the center point.

- 2.1 Check power cable and or canbus

Power voltage: + and - 12V,

CAN bus voltage: CAN-High from 2.5V to 3.5V, CAN-Low from 2.5V to 1.5V at rest are both 2.5V.

- 3.1 RPM specifications

This specific RPM window is mentioned on the sticker on the frame. For this test first start the bike and press the button to open the valve to 100%. Then go to the RPM window and the smartbox should react on this by closing the valve. Sometimes it is hard to keep the bike in the indicated window.

• 4.1 Cable Tension

Check the cable tension to see if it is right:

Valve doesn't rotate -> Cable tension too high

Valve makes a rattling Noise -> cable tension too low

Valves rotational direction uneven? Adjust mechanical cable



Adjust cable tension and tighten screws

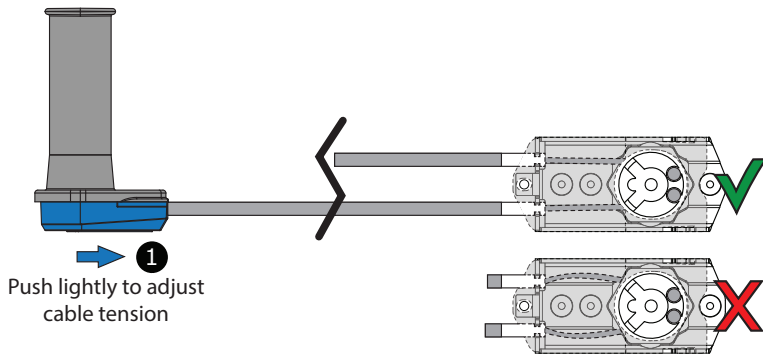

When mounted on motorcycle:  
 ⚠ Tension too high = valve doesn't rotate ⚠  
 ⚠ Tension too low = rattling valve ⚠  
 Adjust on bike if necessary

➔ 1  
 Push lightly to adjust cable tension

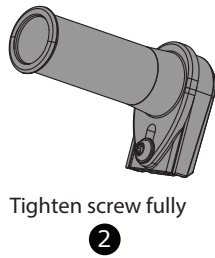

Tighten screw fully  
 2

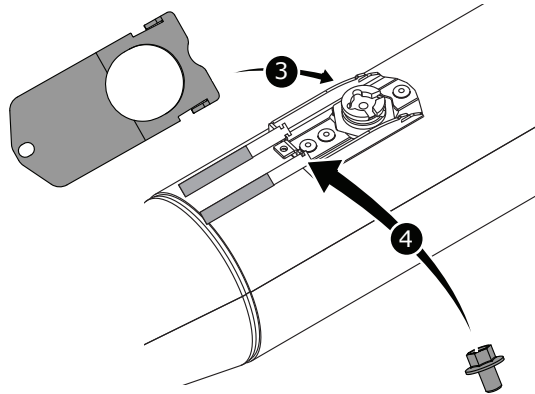

Use new screws only!

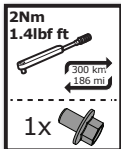

• 5.1 The power cable may vary for different brands and models of motorcycles.