



SN. . . . .

# Dr. Jekyll & Mr. Hyde®

## THE EXHAUST

MANUAL : HARLEY-DAVIDSON® | SMARTBOX 2

### NEW IN THIS MANUAL:

- 2021 MODEL
- PLUG & PLAY POWER CABLE



Fat Bob  
2021->

1

# Fat Bob 2021-> Smartbox 2

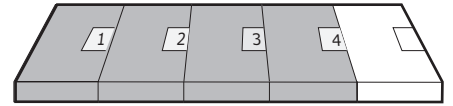

**1 Assembly Kit**

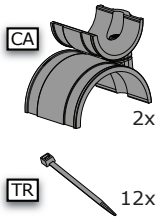

**2 Smartbox 2**

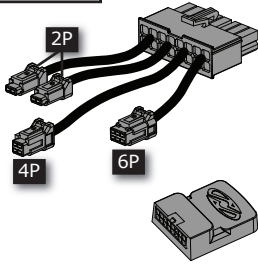

**3 Mode Switch for Smartbox**

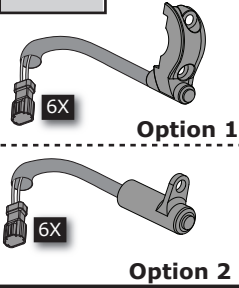

**4 Smartbox Power Cable**

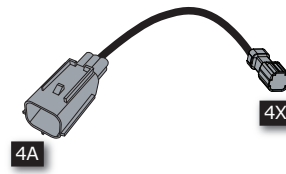

Exhaust/Cable/Servo System

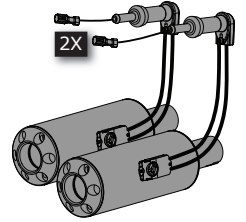

2

Re-use at step 3 & 4

4x 2x 2x

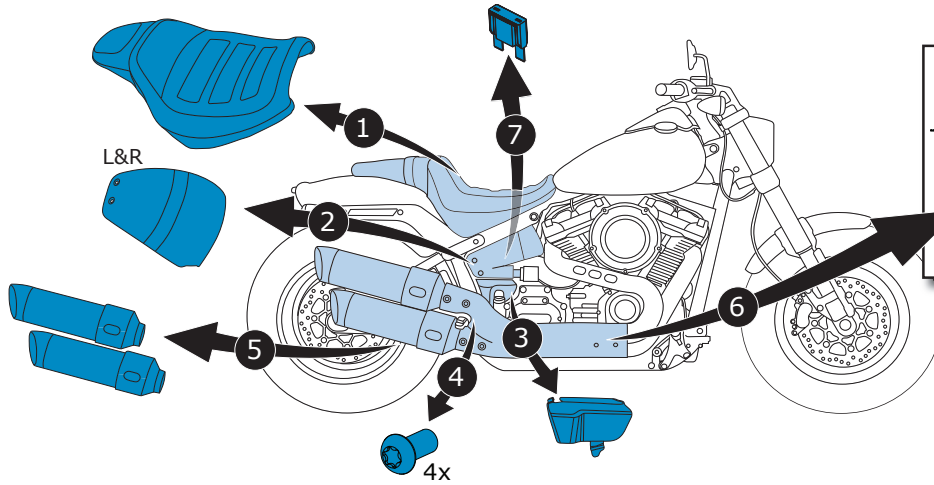

(optional)  
Reuse at step 4

2x

3

## Upper exhaust

Items required

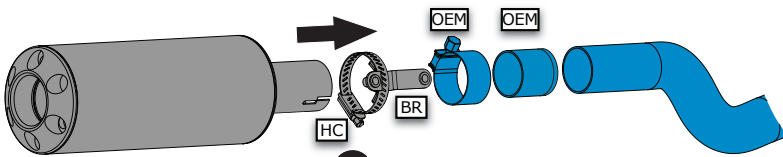
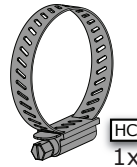
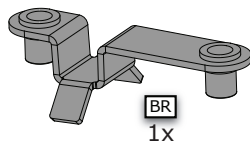

**1**  
Slide exhaust on OEM header

**2**  
Attach exhaust to OEM bracket

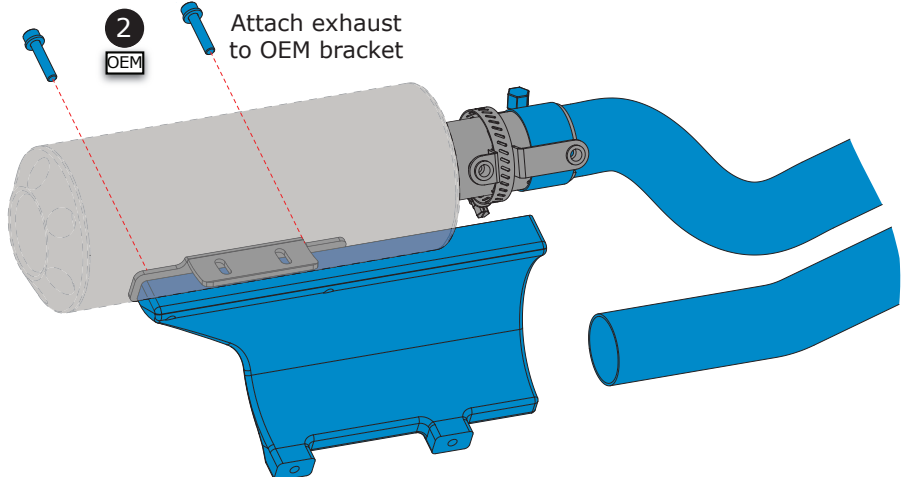

OEM	OEM
30Nm 22lbf ft	10Nm 7lbf ft
1x	2x

4

### Lower exhaust

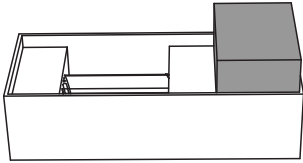

Items required

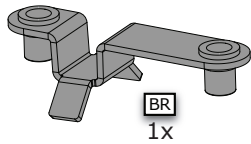

BR  
1x



HC  
1x

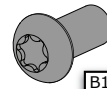

B1  
4x



N1  
4x

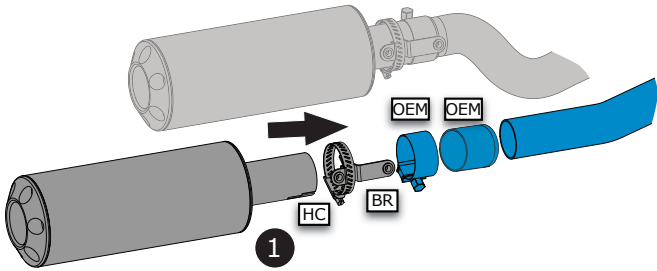

1  
Slide exhaust on  
OEM header

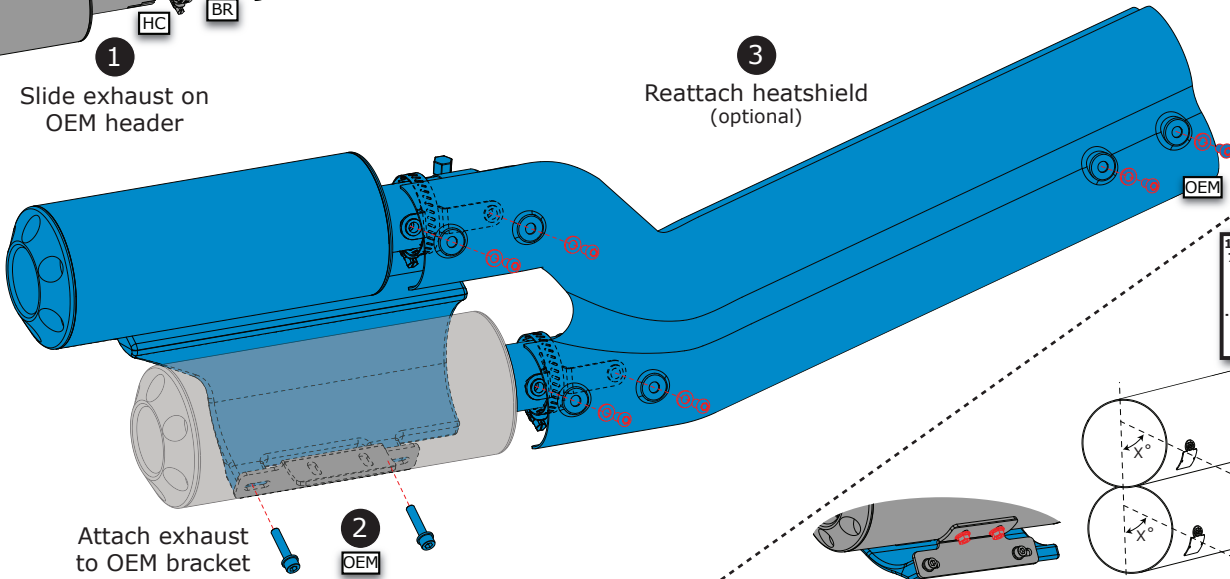
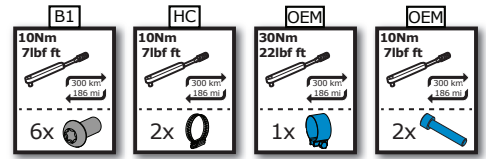

2  
Attach exhaust to  
OEM bracket

3  
Reattach heatshield  
(optional)

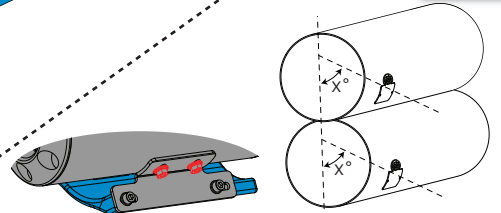
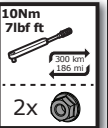

If necessary: Loosen lower exhaust and align exhausts

5

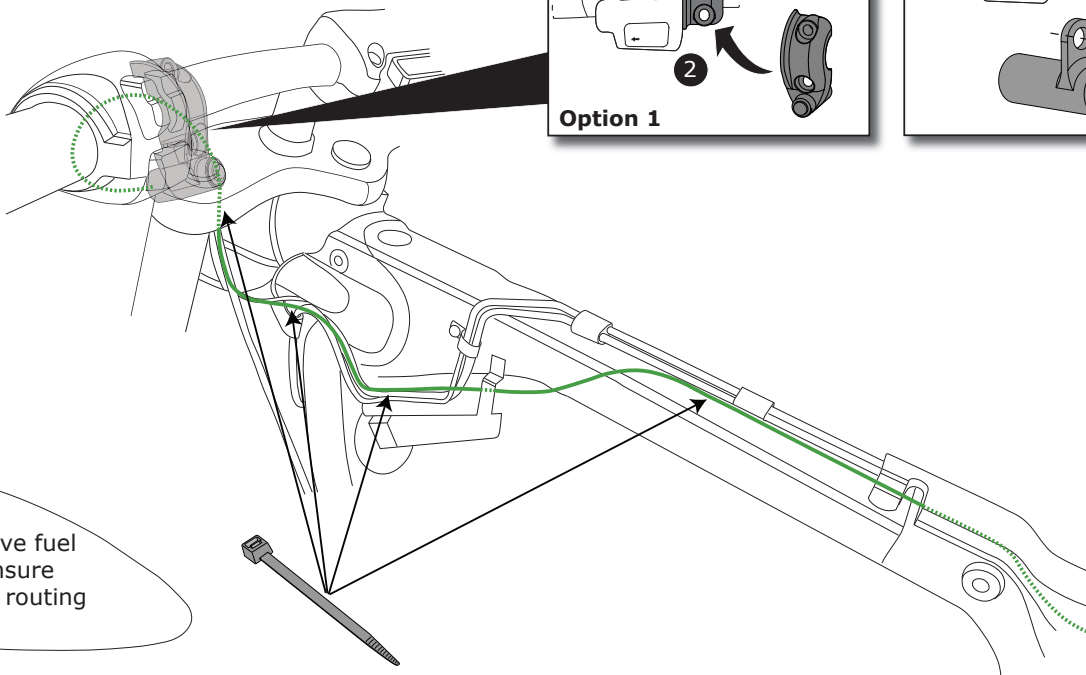
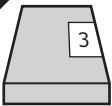

Lift or remove fuel tank to ensure proper cable routing

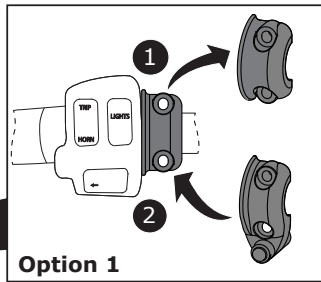

Option 1

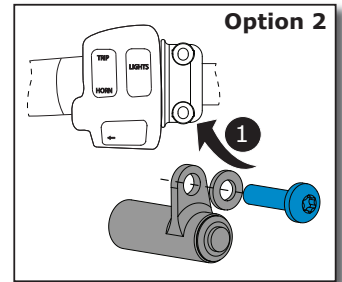

6

Left hand side

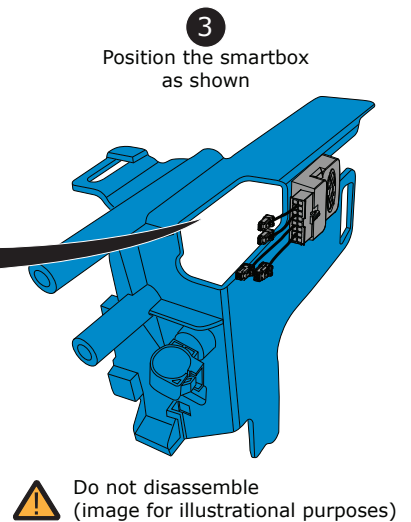
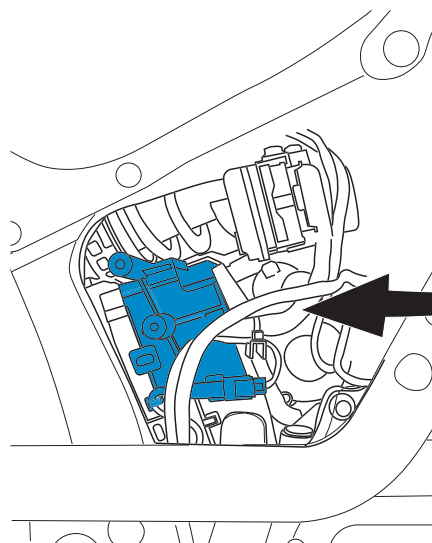
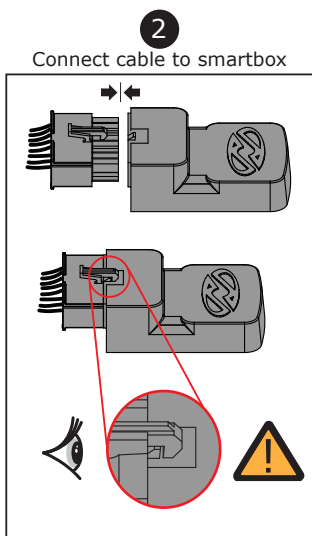
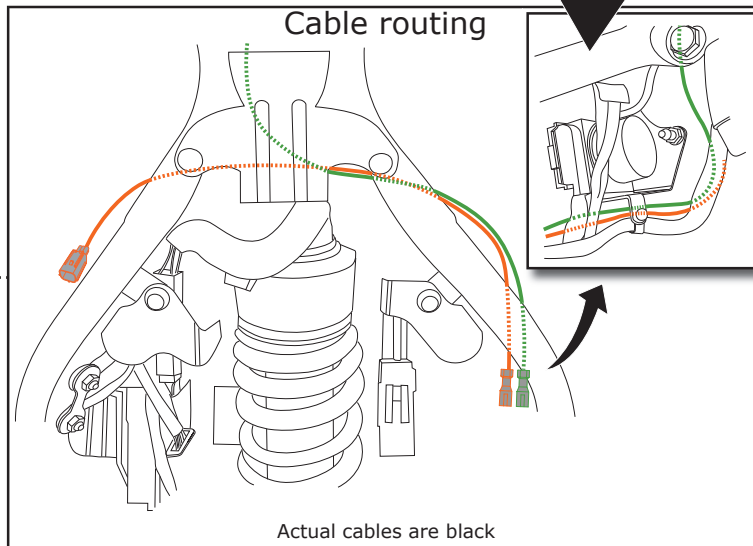
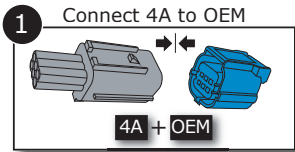
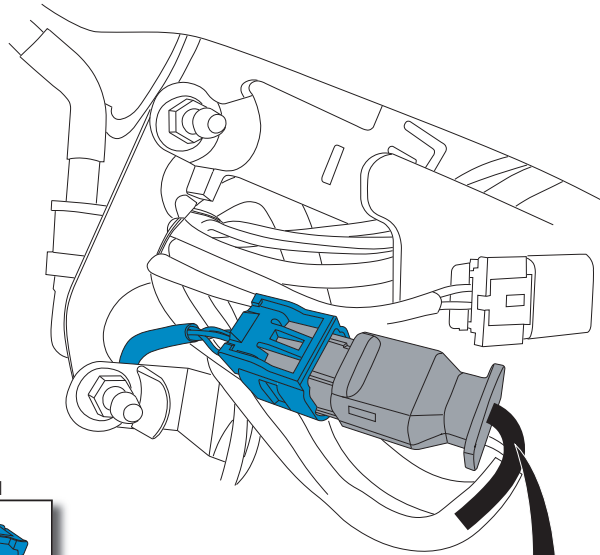
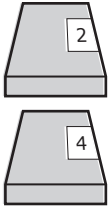

7

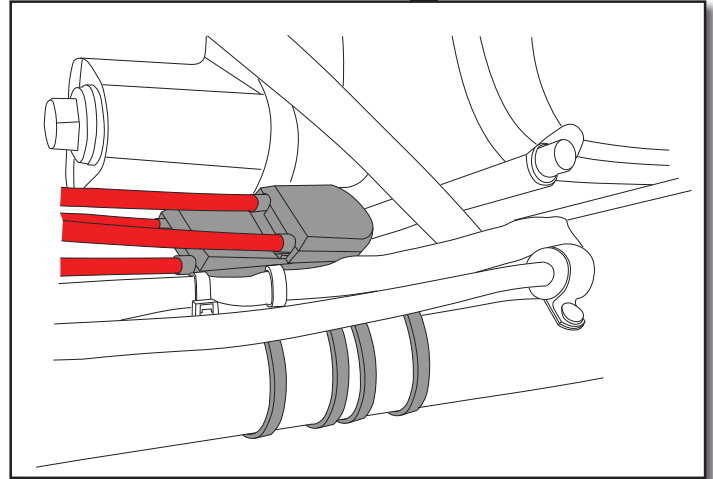
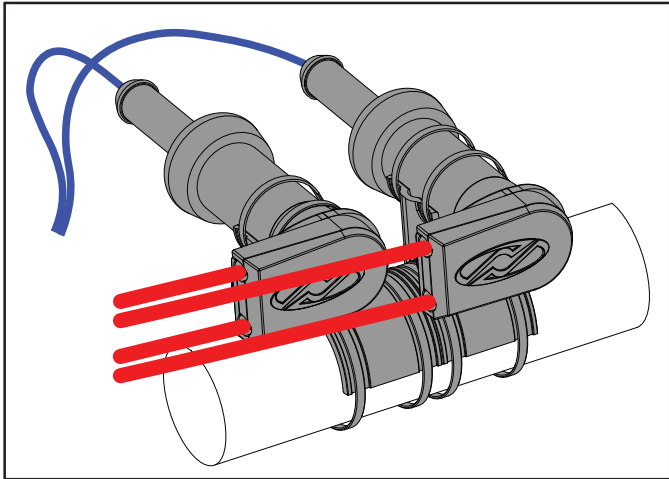
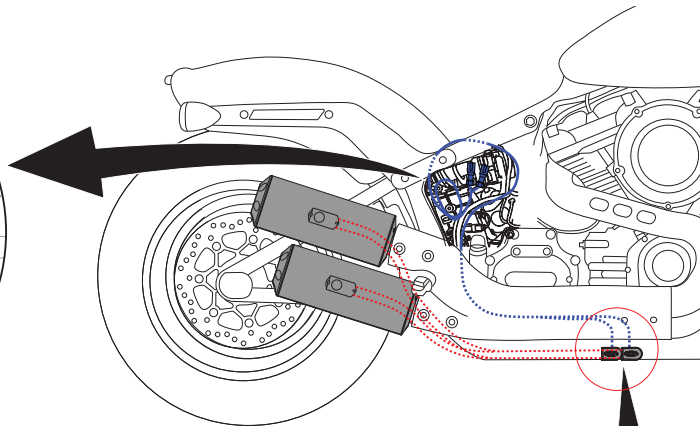
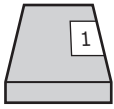

8

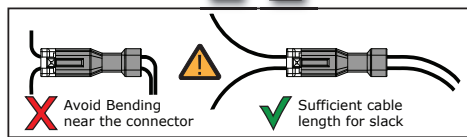
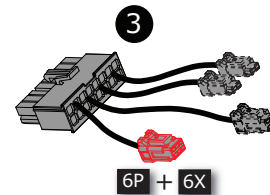
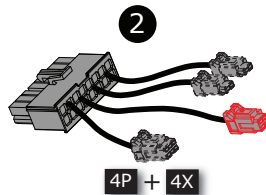
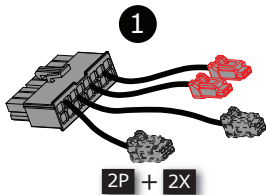

9



Reinstall fuse and perform a

**Complete System Check!**

