



SN.

Dr. Jekyll & Mr. Hyde®

THE EXHAUST

MANUAL : HARLEY-DAVIDSON® | SMARTBOX 2

NEW IN THIS MANUAL:
- JEKILL BOMB EXHAUST



Streetbob
Low Rider S
2021->

1

Streetbob/ Low Rider S 2021-> Smartbox 2

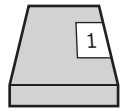
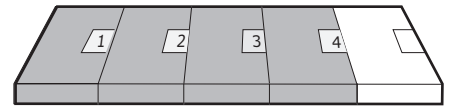

Assembly
Kit

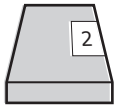
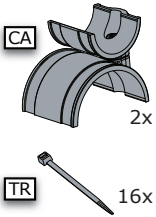

Smartbox
2

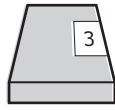
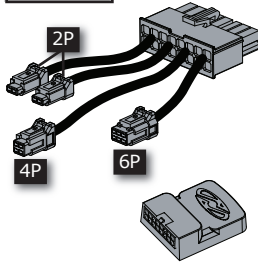

Mode Switch
for
Smartbox

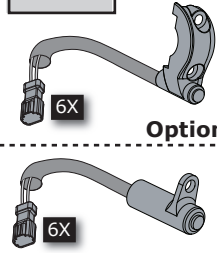

Option 1

Option 2

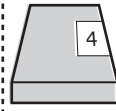

Smartbox
Power
Cable

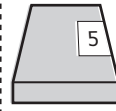
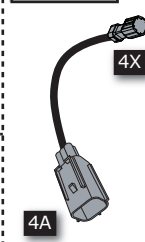

O2 sensor
cable
extender

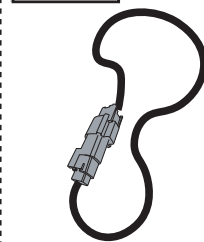

Exhaust/Cable
/Servo System

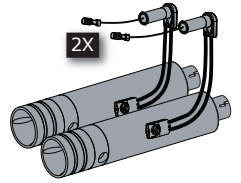

2

Re-use at
step 3

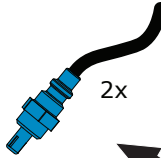

Re-use at
step 5 & 7

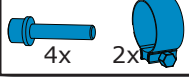

L&R

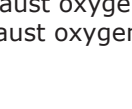
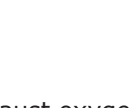
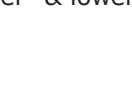
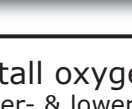
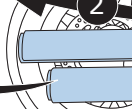
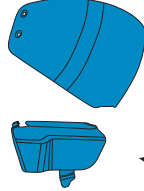

Re-install oxygen sensors Upper- & lower exhaust



Use HD-tool:
HD-52977

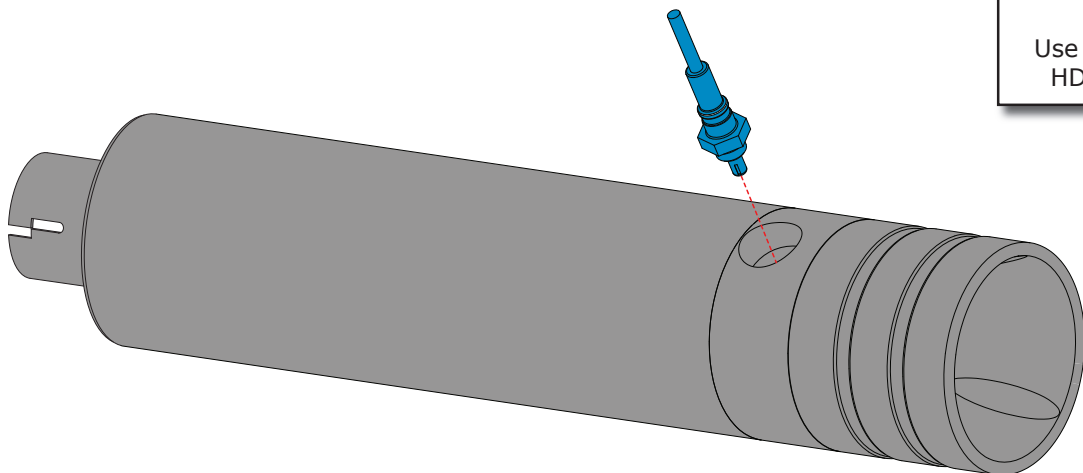

Upper exhaust oxygen sensor = gray
Lower exhaust oxygen sensor = black



4

1 Adjust OEM exhaust bracket

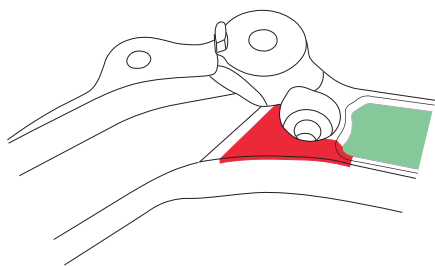

Remove material in the red area (2,5mm). Red area should be flush with green reference surface.

2 Adjust header position

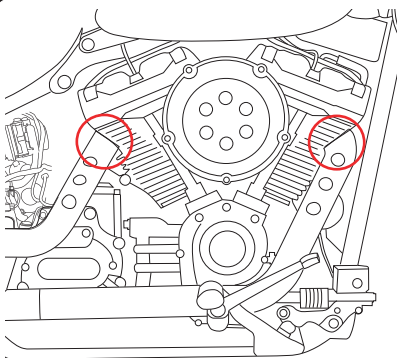

Loosen header nuts to be able to adjust the header position during the upcoming steps. Tighten after step 8.

3 Use spacers on floorboards or mid controls before re-installing them

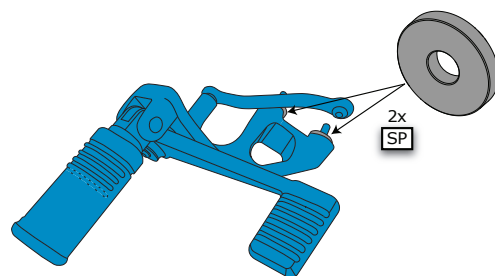

4

If applicable:
Install footrest adapter before continuing at step 5
(manual: DR-301148)

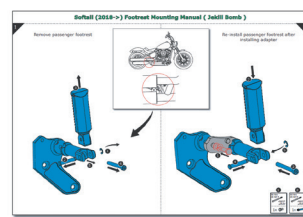

5

Install lower exhaust

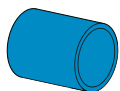

- HD part nr. 65900017

GA
1x

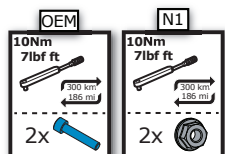

2

3

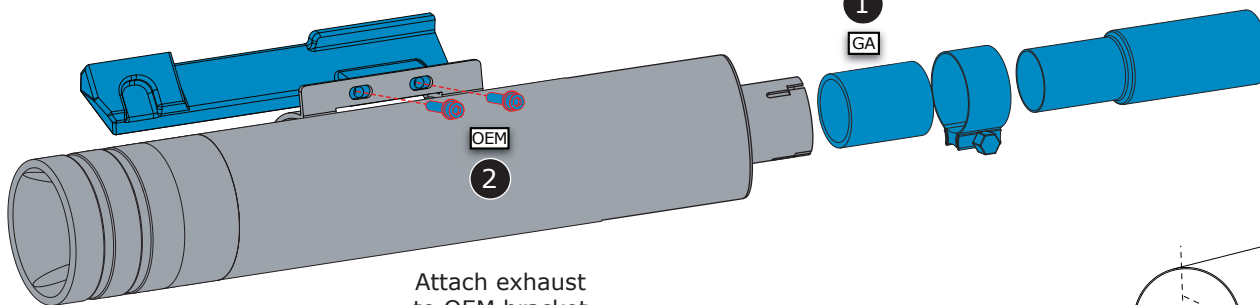

Slide exhaust on
OEM header

1

GA

OEM

2

Attach exhaust
to OEM bracket

Loosen nuts to adjust exhaust position

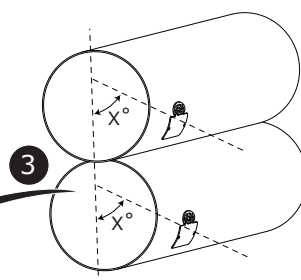
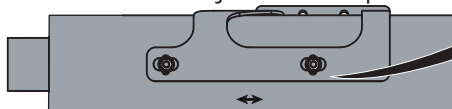

Position typeshields at
the same angle (X°)



Lower exhaust O2 sensor cable (black) routing

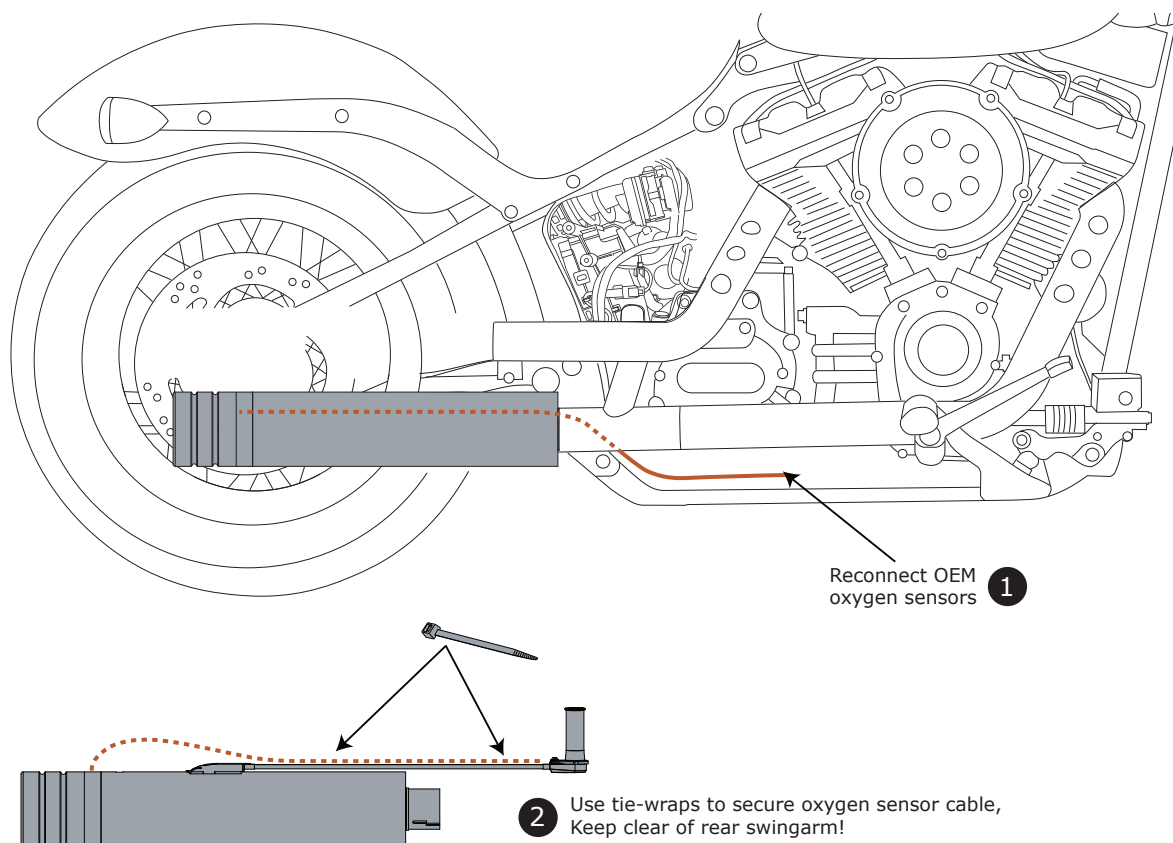

Install upper exhaust

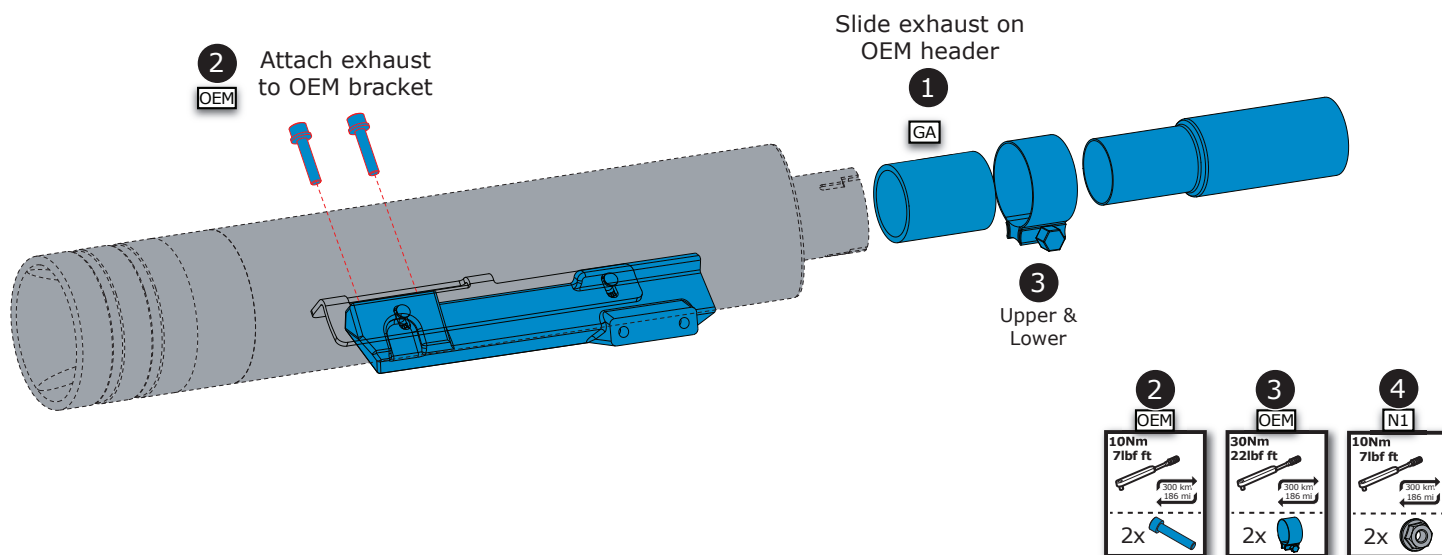

Upper exhaust O2 sensor cable (gray) routing

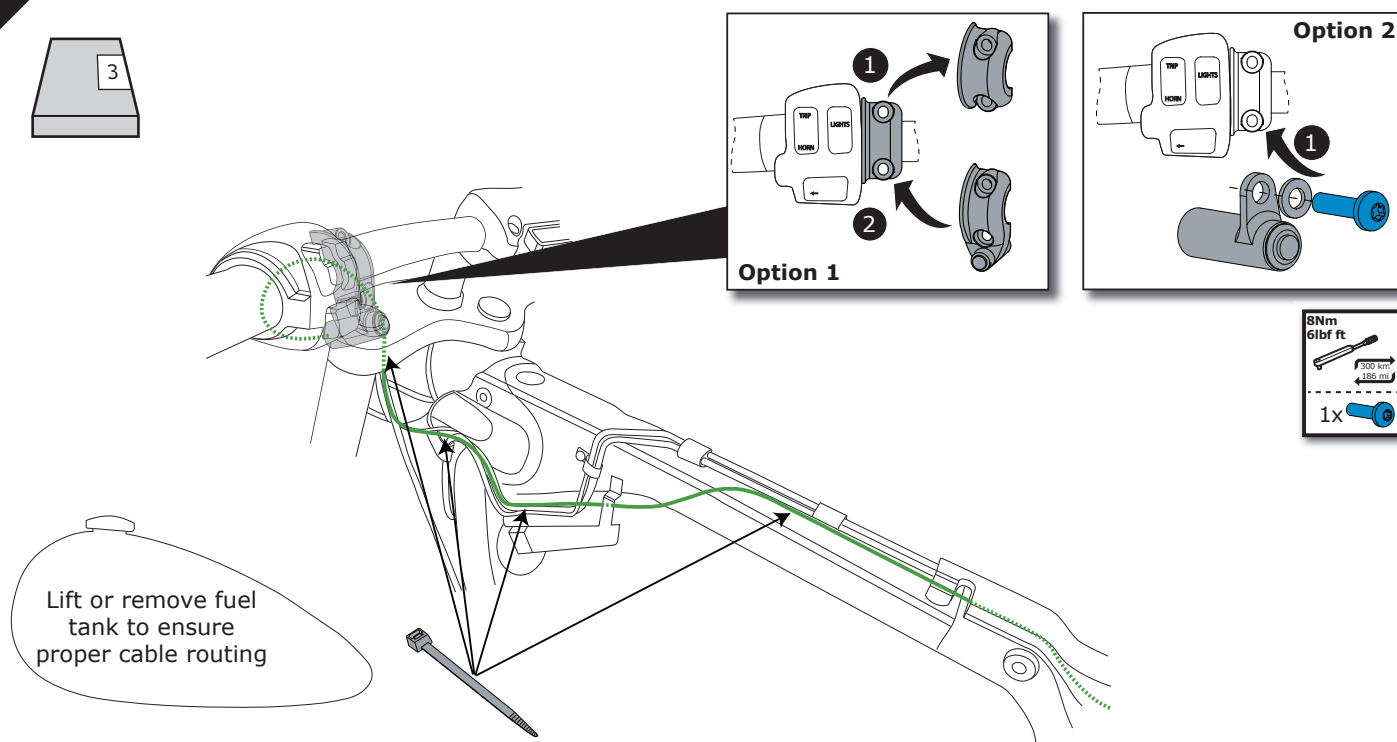
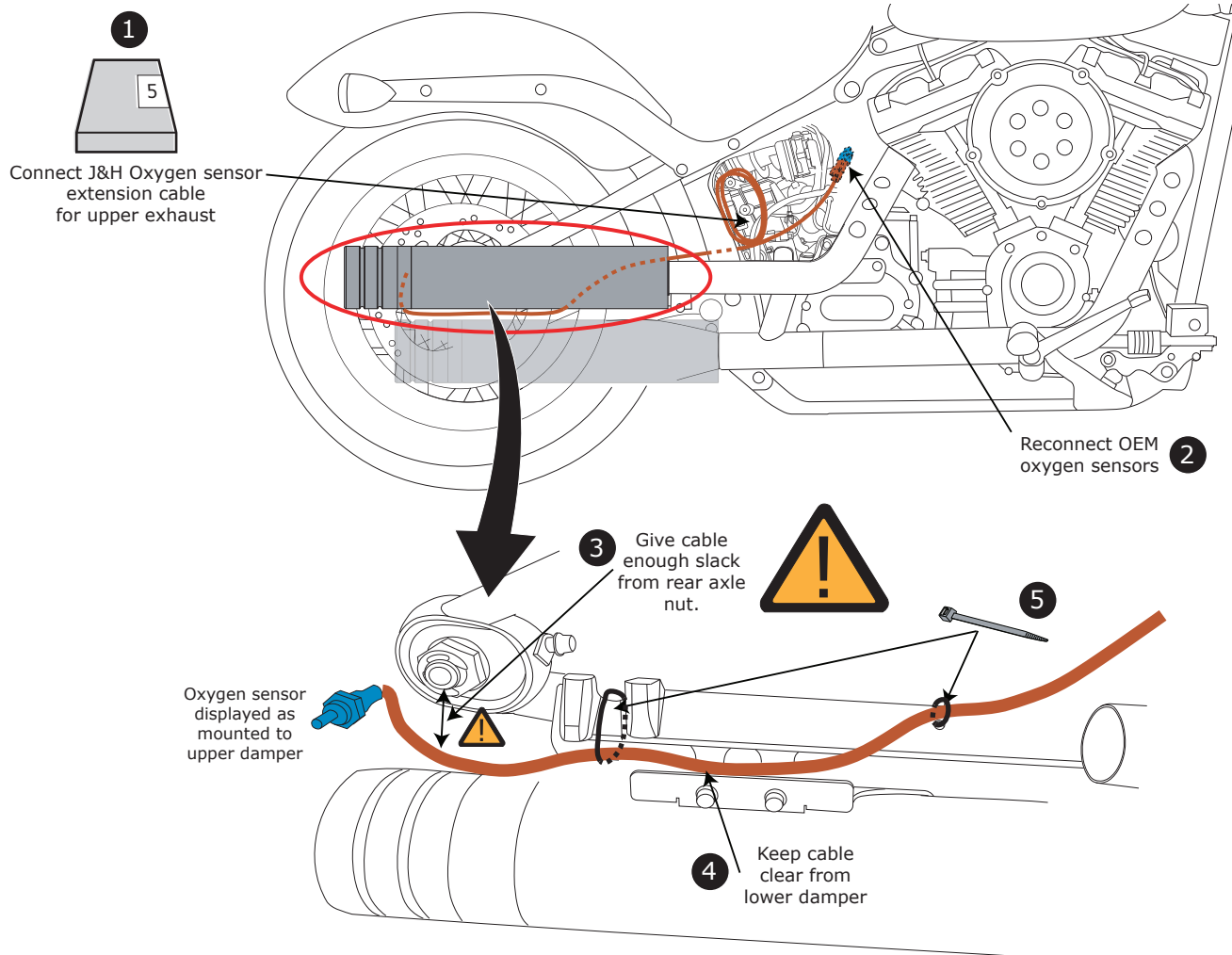

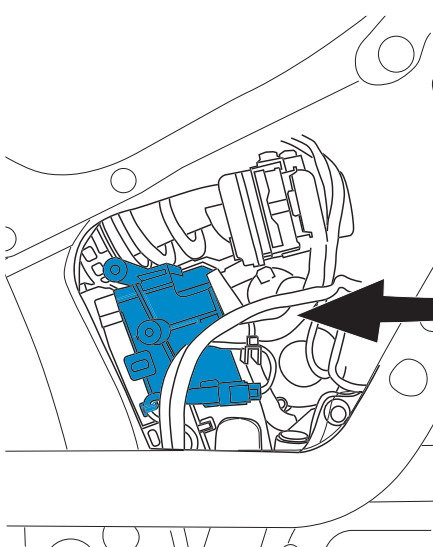
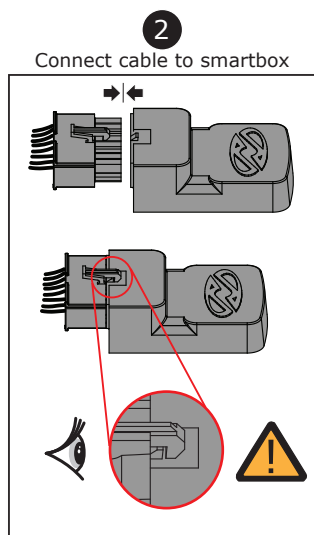
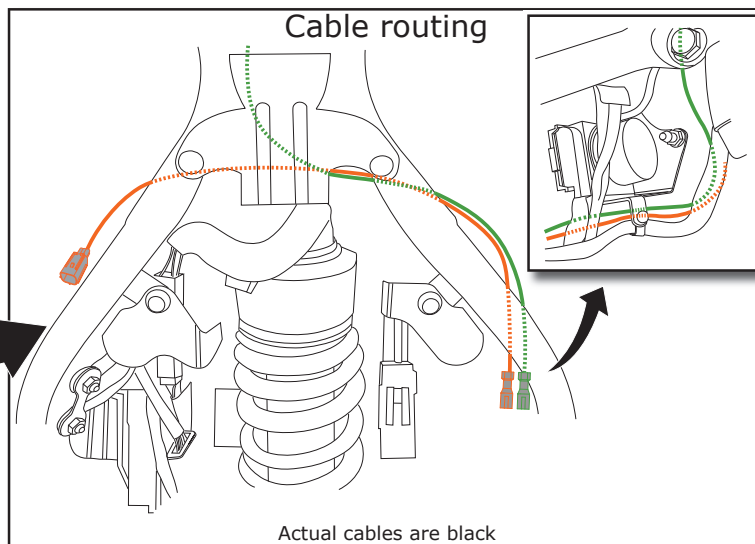
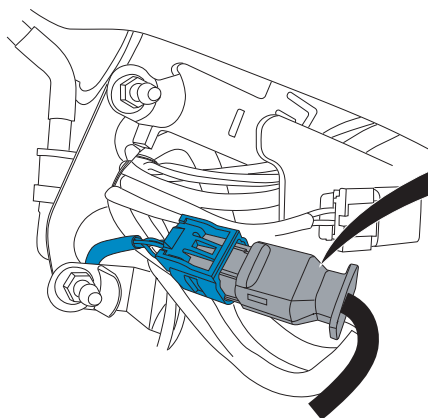
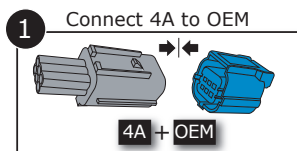
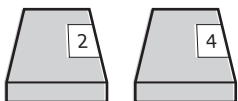

3
Position the smartbox
as shown

Do not disassemble
(image for illustrational purposes)

11

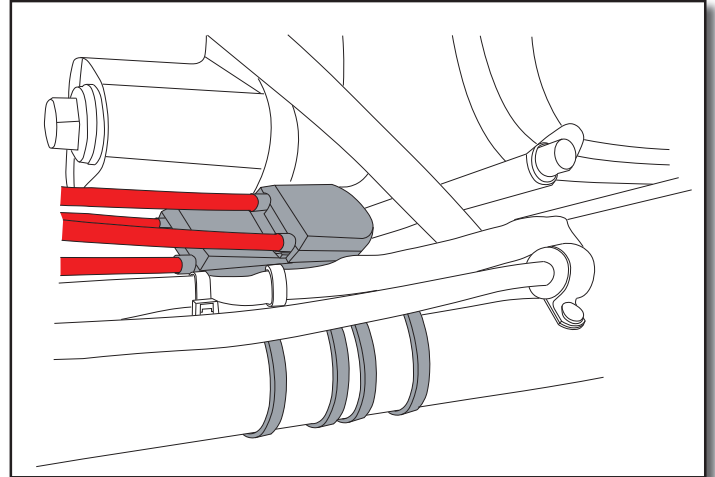
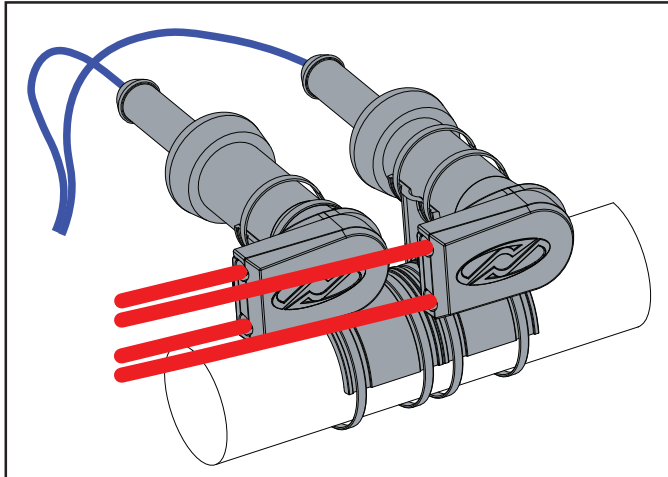
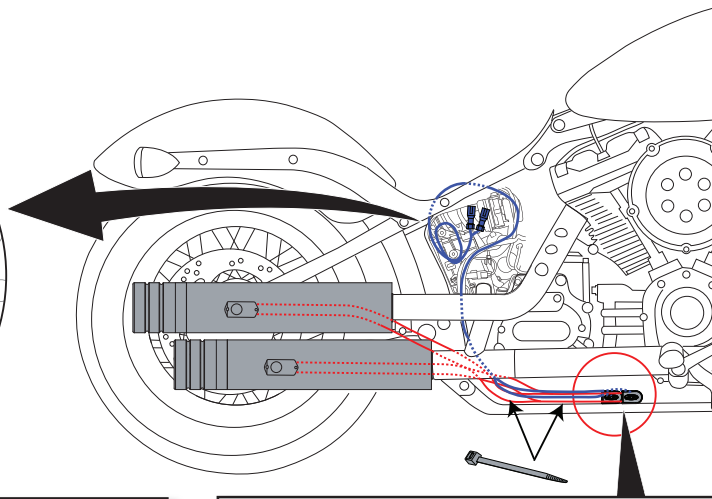
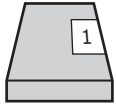

12

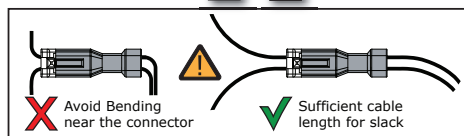
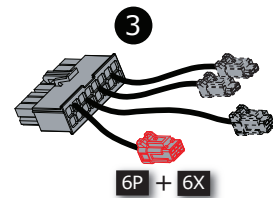
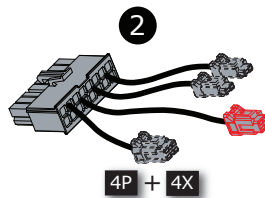
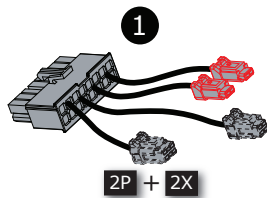

13

Complete
System
Check!

